

1. For seams assembled with GenFlex G-400 Seam Adhesive, a bead of GenFlex Edge Caulk is required on all exposed edges, following a pre-cleaning of the seam area with GenFlex EPDM Cleaner.
2. Flange must be secured through GenFlex EPDM membrane to wood nailer and set in bead of GenFlex Water Stop. Securement method must meet industry standards and be capable of resisting 200lb (890 N) of pullout resistance per linear foot.

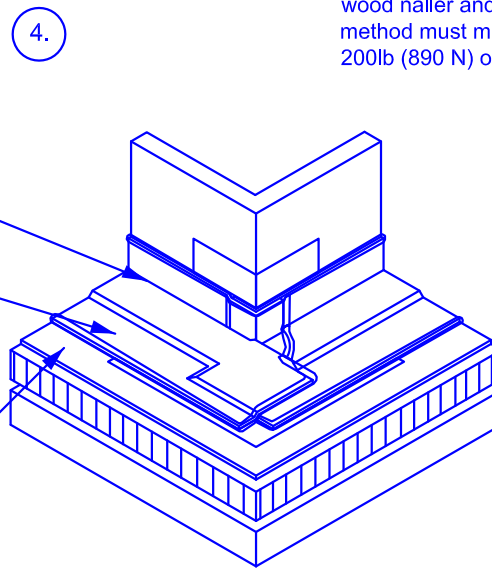
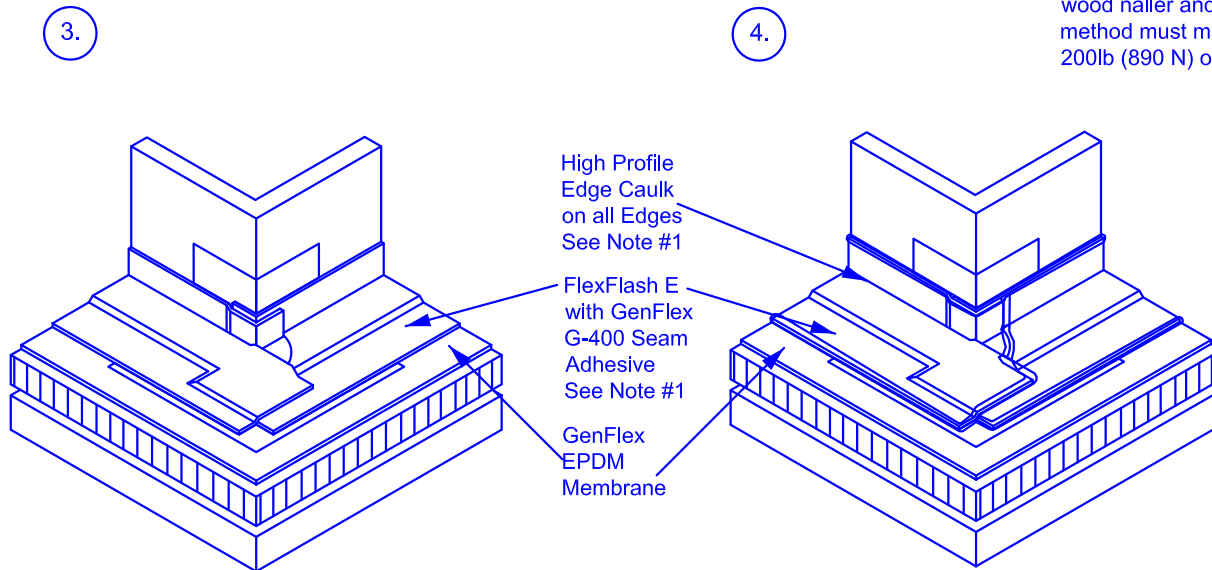

**Welded Watertight Curb/Skylight Flashing (Option B)**

EPDM Systems

ACCEPTABLE SYSTEMS:  
All Systems

MAXIMUM WARRANTY: **20 Years**

ISSUE / REVISION  
DATE:  
6-24-2015

NOT TO SCALE

DETAIL NO.

**E-3.07**