

Bar Cover Tape
See Note #3

Metal Fascia
See Note #5

NOTE: Edge Caulk is required only on the dam side of strip-in on Bar Cover Tape applications. Both sides of FlexFlash E require Edge Caulk.

1. Caulk metal joints. See Detail E-14.09.
2. All wood nailers to be approved material. Attachment of wood nailer to be accomplished by using fasteners providing no less than 125 lb (556.03 N) of pullout. Fasteners shall be spaced no greater than 24" o.c. (609.60 mm).
3. When using GenFlex Seam Tape and GenFlex Bar Cover Tape, first clean the membrane with GenFlex Cleaner. Then apply GenFlex Primer.
4. Metal coping cap, expansion joint, and edge details are typical only. All metalwork should be installed to sheet metal codes (SMACNA). Clean all metal prior to installation of GenFlex materials.

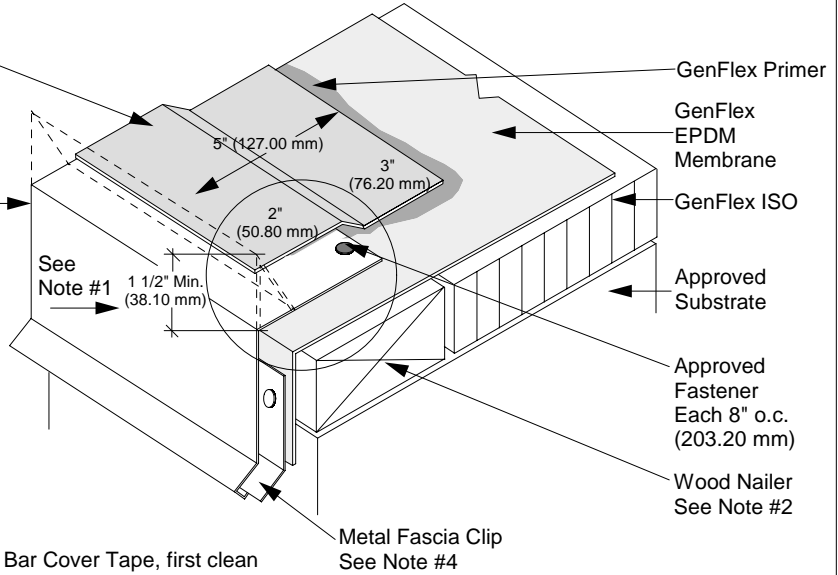

Metal Fascia Clip
See Note #4



Metal Gravel Stop

Detail #: E-14.01

EPDM Systems