

GenFlex Cured EPDM Membrane

GenFlex EPDM Bonding Adhesive  
See Note #2

GenFlex Bar Anchor with Approved Fasteners  
12" (304.80 mm) o.c.  
See Note #3

GenFlex Bar Cover Tape Centered Over Bar Anchor  
See Note #1

Primer

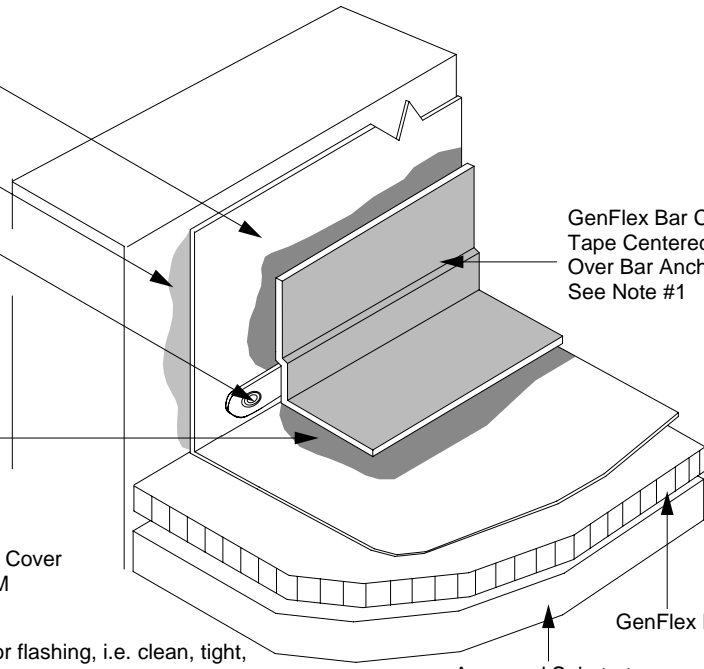

1. When using GenFlex Seam Tape and GenFlex Bar Cover Tape, first clean the membrane with GenFlex EPDM Cleaner. Then apply GenFlex Primer.

2. All parapet walls and roof curbs must be suitable for flashing, i.e. clean, tight, smooth, no cracks, etc.

3. Polymer batten strips cannot be used for attachment into masonry wall substrates. Use only on smooth surfaces, e.g. wood or insulation.

**GenFlex**  
Roofing Systems 10/06

**Continuous Membrane Base  
Flashing - Vertically Secured**

**Detail #: E-2.01**

**EPDM Systems**