

NOTE:

1. REFER TO GENFLEX™ FOR THE MOST CURRENT INFORMATION.
2. REMOVE ALL EXISTING FLASHING, LEAD, ETC. PIPE SURFACE MUST BE FREE OF ALL RUST, GREASE, INSULATION, ETC.
3. GENFLEX POURABLE SEALER MOUNDED TO SHED WATER. (MINIMUM DEPTH OF 2" (51 mm), REMAINDER OF POCKET MAY BE FILLED WITH NON-SHRINKING GROUT.
4. DO NOT USE OVER EXISTING PENETRATIONS POCKETS
5. DO NOT USE WHEN SERVICE LINE TEMP. EXCEEDS 180 °F (82 °C). REFER TO EZE-PS-P-04.
6. CUT PVC PIPE MINIMUM 2" (51 mm) HIGH AND OF SUFFICIENT WIDTH TO ALLOW 1"(25 mm) OF SPACE BETWEEN THE PVC SHELL AND PENETRATIONS. MEMBRANE MUST EXTEND TO WITHIN 1/2" (13 mm) OF PENETRATION.
7. GENFLEX POURABLE SEALER MOUNDED TO SHED WATER. (MINIMUM DEPTH OF 2" (51 mm). REMAINDER OF POCKET MAY BE FILLED WITH NON-SHRINKING GROUT.
8. APPLY EDGE CAULK AROUND ENTIRE PERIMETER OF FLASHING. REFER TO EZE-PS-LS-09 FOR SEAM EDGE TREATMENT.
9. GENPRIME PRIMER REQUIRED ON PENETRATIONS AND MEMBRANE INSIDE OF PENETRATION POCKET.

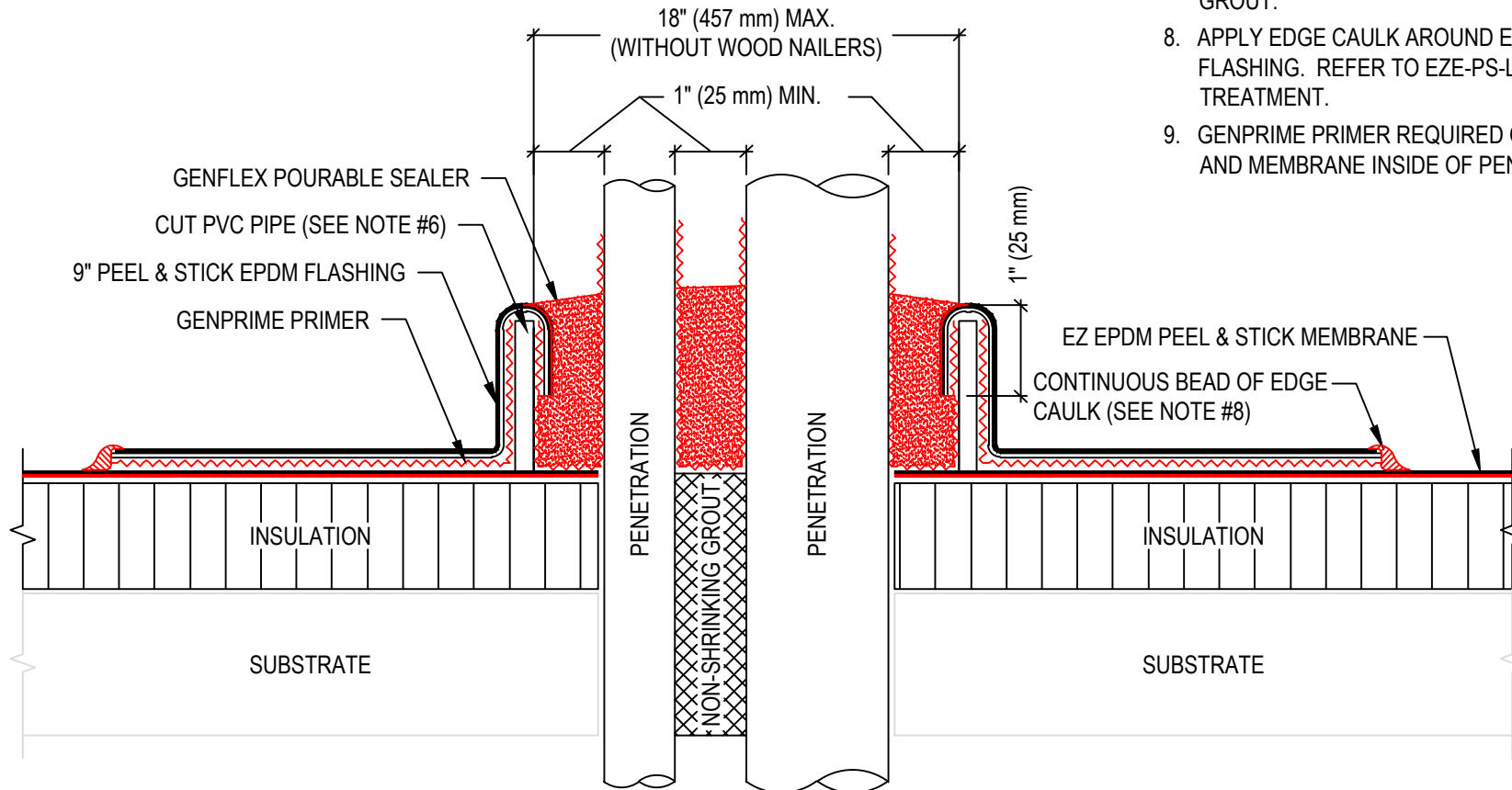

**PENETRATION WITH FIELD FABRICATED ROUND
PVC PENETRATION POCKET**

ACCEPTABLE SYSTEMS: EZ EPDM PEEL & STICK™ SELF ADHERED

MAXIMUM WARRANTY: 20 Years

ISSUE / REVISION
DATE:

07/28/2023

DETAIL NO.

EZE-PS-P-06

(800) 443-4272 www.genflex.com

NOT TO SCALE