

GenFlex ½" HD ISO Cover Board

DESCRIPTION

GenFlex ½" HD ISO is a half-inch (12.7 mm) thick polyiso insulation designed for use as a cover board. It is a high density, closed-cell, polyisocyanurate foam core that has been manufactured with a coated glass facer. GenFlex ½" HD ISO provides the highest thermal performance when compared to other ½" high density cover boards.

All GenFlex polyisocyanurate insulations use EPA accepted blowing agents and incorporate an HCFC-free blowing agent that does not contribute to the depletion of the ozone (ODP-Free).

ADVANTAGES

- Outstanding thermal performance (R-Value of 2.5)
- Available in 4' x 4' (1.2 m x 1.2 m) and 4' x 8' (1.2 m x 2.4 m) boards
- Lightweight 12 +/- 2 lb per 4' x 8' boards
- Easier to handle and cut than other high density cover boards
- Compatible with all GenFlex EPDM and TPO fully adhered and mechanically attached systems
- High compressive strength cover board (120 psi)
- Superior FM Global, wind uplift performance. 1-90 requires only 12 fasteners per board.
- ½" (12.7 mm) – 96 boards per bundle
- Coverage per bundle:
 - 4' x 4' = 1536 ft² (142.7 m²)
 - 4' x 8' = 3072 ft² (285.4 m²)

SPECIFICATION COMPLIANCE

- Manufactured in ISO 9000 Registered Facilities
- FM Global Approved when applied with the fastening pattern shown
- UL Classified

INSTALLATION

Install GenFlex ½" HD ISO in accordance with current GenFlex specifications and installation guidelines. Install with GenFast Fasteners and plates as shown below or with GenFlex approved insulation adhesives. **DO NOT USE HOT ASPHALT WITH ½" HD ISO.**

Insulation shall be neatly fitted to all roof penetrations, projections and nailers. No more insulation shall be installed than can be covered with membrane and completed before the end of each day's work or before the onset of inclement weather.

GenFlex ½" ISO can be applied over existing roof surfaces under adhered or mechanically attached EPDM and TPO roofing systems. Contact the GenFlex Technical Department for proper fastening patterns.

STORAGE and PRECAUTIONS

- Keep insulation dry at all times
- Elevate insulation above the deck or ground
- Cover insulation with waterproof tarps
- Combustible. Refer to MSDS for more information.
- Do not install over wet, damp or uneven substrates.
- DO NOT MOP OR TORCH

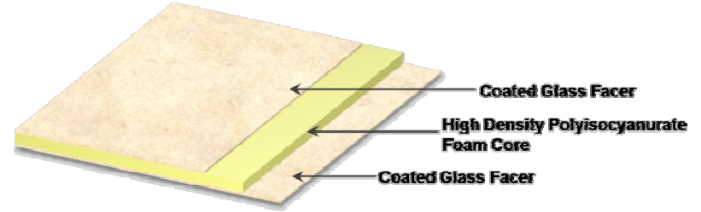

PHYSICAL PROPERTIES

PROPERTY	ASTM TEST METHOD	TYPICAL VALUES
Compressive strength	D 1621	120 psi (827 kPa)
Density	D 1622	5 pcf (80 kg/m ³)
Pull through resistance	D 473	210 lb (934 N)
Foot traffic resistance	Rolling	> 6000 passes
Dimensional stability	D 2126	<0.5%
Water absorption	C 209	<3%
Facer adhesion	D 1623	20 psi (138 kPa)
Resistance to mold	D 3273	Pass

SUPERIOR HAIL RESISTANCE

GenFlex ½" HD ISO boards have been given a Severe Rating by Factory Mutual (FM) Global. ½" HD ISO has also received Approvals for 2.5" diameter hail with mechanically attached 0.060 TPO with a kinetic energy of 57.48 ft-lbs and 2.0" diameter hail with mechanically attached 0.045 EPDM with a kinetic energy of 23.65 ft-lbs (source: National Bureau of Standards 23).

THERMAL VALUES

NOMINAL THICKNESS		R-Value	MAX FLUTE SPAN METAL (INCHES)
INCHES	mm		
0.50	12.7	2.5	2.625"
*Long Term Thermal Resistance (LTTR) values in accordance with CAN/ULC S770.			

LEED INFORMATION

Recycled Content

- Post Industrial Waste: Average 8.3%
- Post Consumer Waste: Average 0%

FM Global fastening pattern for Fully Adhered 1-90 attachment of GenFlex ½" HD ISO Cover Board

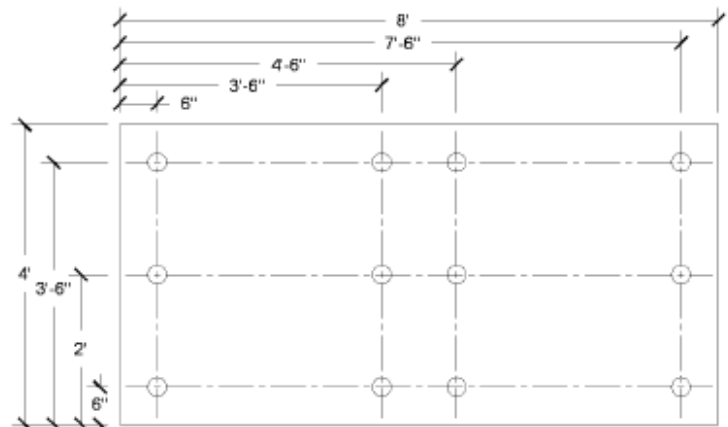

Foamed Plastic for Roofing Systems
As to an External Fire Exposure Only
61P2
See UL Directory of Products
Certified for Canada
And UL Roofing Materials
And Systems Directory
R9516