

1. GenFlex EZ TPO Peel & Stick RMA must be fastened along the entire length of both structural purlins located closest to the ridge.
2. Prime the backside of the TPO membrane with Clear Primer prior to attaching to the RMA strip.
3. GenFast Purlin Fasteners must penetrate the structural purlin a minimum of 1.5" (38 mm) total.
4. If structural purlins are spaced every 5' (1.5 m), fastener spacing is not to exceed 12" (305 mm) o.c. If structural purlins are spaced every 6' (1.8 m), fastener spacing is not to exceed 6" (152 mm) o.c.

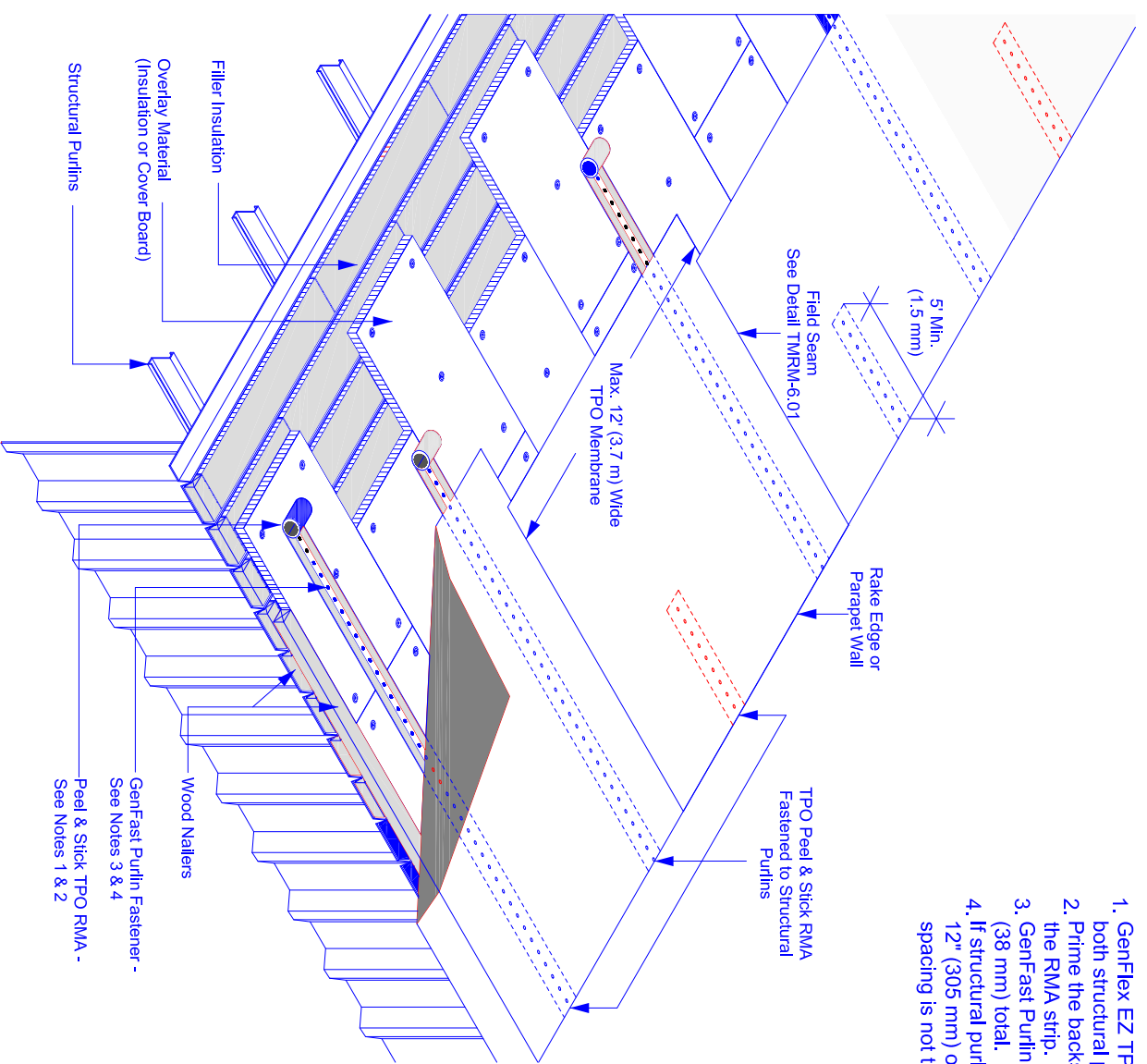

Membrane Layout and Attachment



EZ TPO Systems

ACCEPTABLE SYSTEMS:
Metal Building Recover

MAXIMUM WARRANTY: **15 Years**

ISSUE / REVISION
DATE:
10-27-2015

DETAIL NO.
EZ-S-42.10

NOT TO SCALE