

USE APPROPRIATE TERMINATIONS

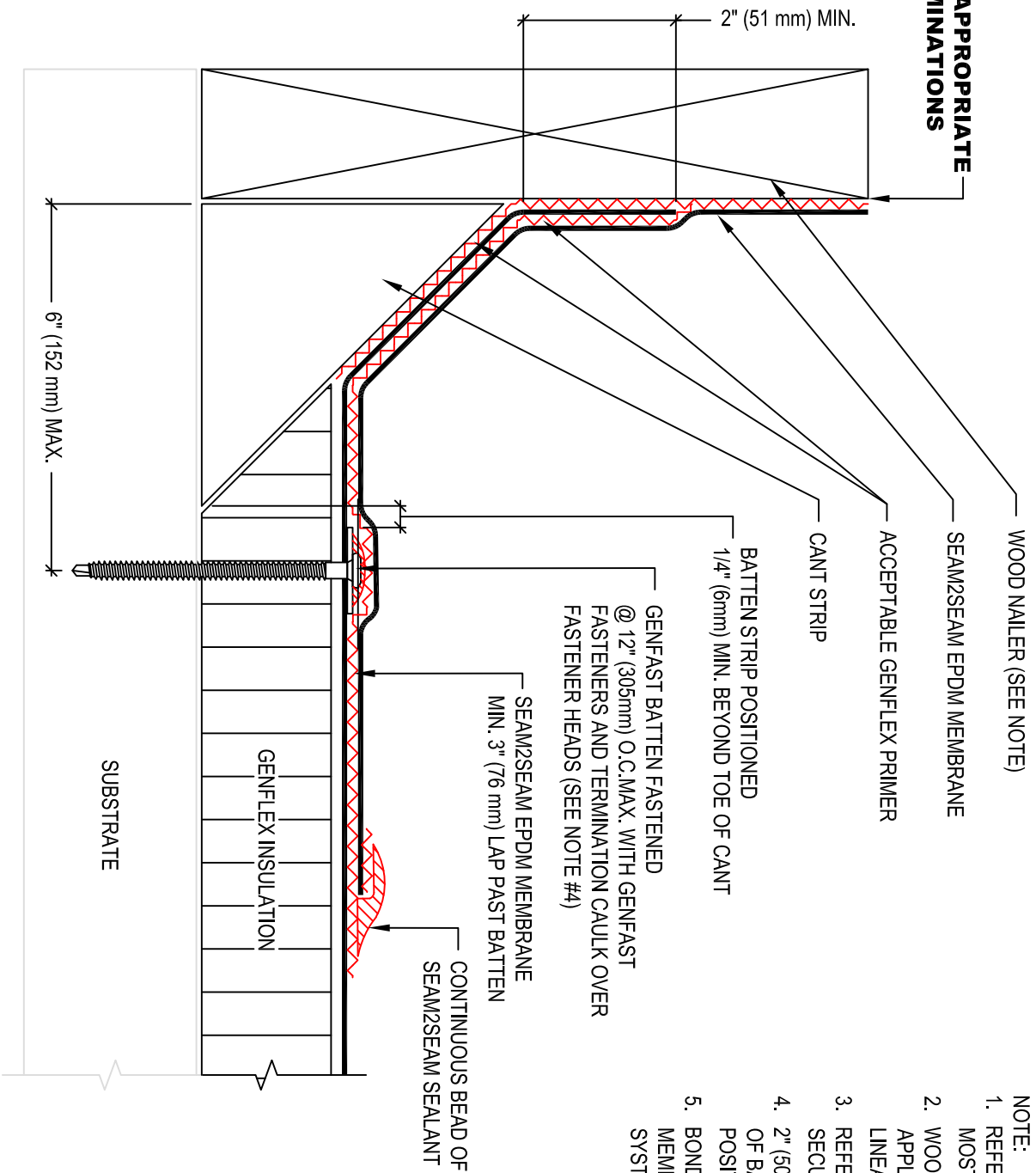

- NOTE:**
1. REFER TO GENFLEX WEBSITE FOR THE MOST CURRENT INFORMATION.
 2. WOOD NAILER MUST BE INSTALLED TO MEET APPLICABLE BUILDING CODES OR 200 lb PER LINEAR FOOT MINIMUM IN ANY GIVEN DIRECTION.
 3. REFER TO S2S-BT-16 & S2S-BT-17 FOR MEMBRANE SECUREMENT AT CORNERS.
 4. 2" (50.8 mm) METAL PLATES MAY BE USED IN LIEU OF BATTEN STRIP. EDGE OF PLATE MUST BE POSITIONED SIMILAR TO BATTEN.
 5. BONDING ADHESIVE REQUIRED BETWEEN MEMBRANE AND INSULATION FOR ADHERED SYSTEMS.



BASE TIE-IN AT EXISTING CURB / PARAPET WITH EXISTING CANT

GENFLEX™

ACCEPTABLE SYSTEMS: **SEAM2SEAM™ EPDM**

MAXIMUM WARRANTY: 20 Years

ISSUE / REVISION DATE:

06/01/2020

DETAIL NO.

S2S-BT-11

GENFLEX: (800) 443-4272 www.genflex.com

NOT TO SCALE