



**BASE TIE-IN AT WELDED WATERTIGHT CURB
(FLANGES 2" TO 3")**

GENFLEX™ ACCEPTABLE SYSTEMS: SEAM2SEAM™ EPDM

GENFLEX: (800) 443-4272 www.genflex.com

MAXIMUM WARRANTY: 20 Years

ISSUE / REVISION
DATE:

06/01/2020

NOT TO SCALE

DETAIL NO.

S2S-BT-13

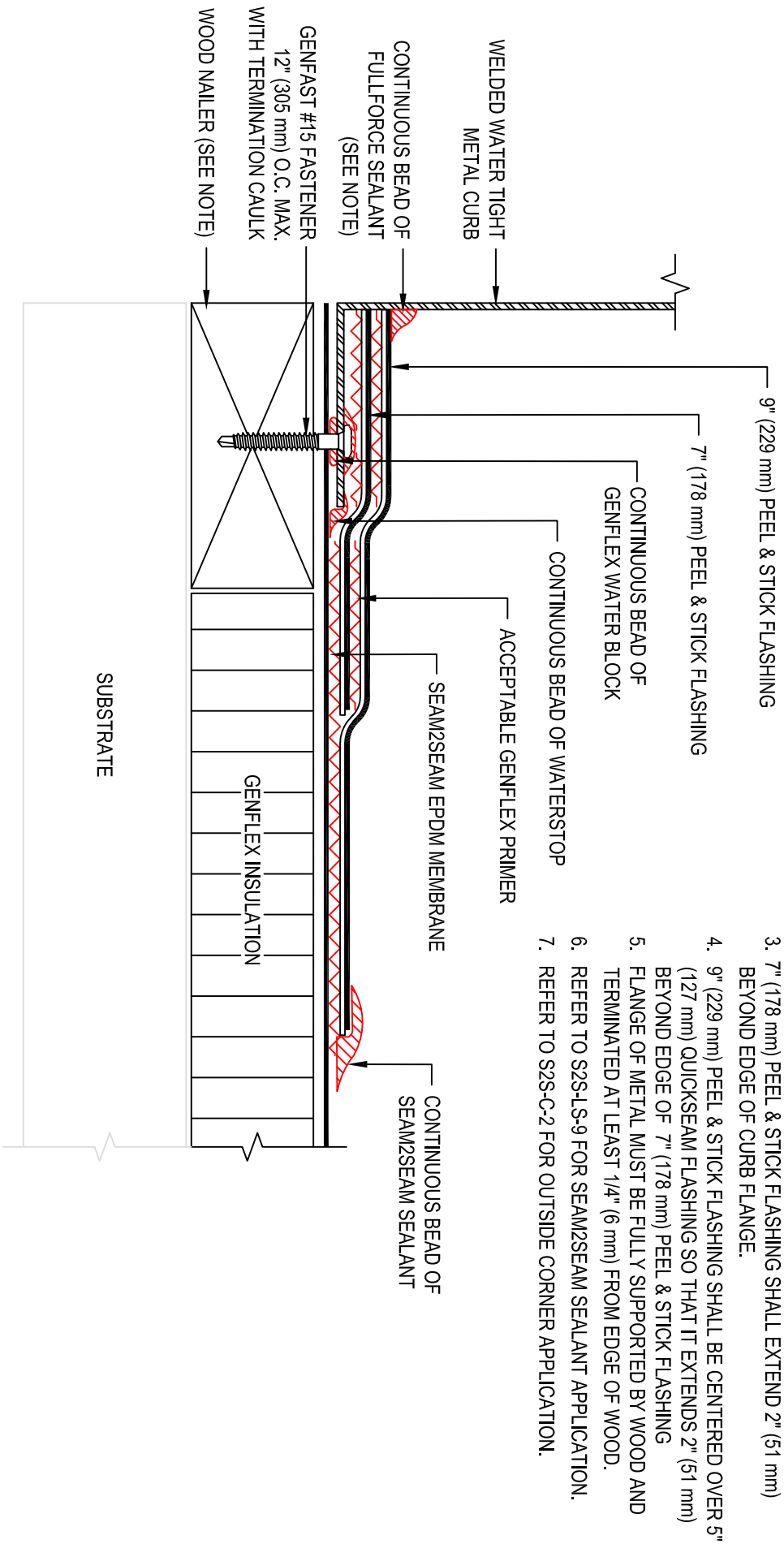

NOTE:

1. REFER TO FIRESTONE WEBSITE FOR THE MOST CURRENT INFORMATION.
2. WOOD NAILER MUST BE INSTALLED TO MEET APPLICABLE BUILDING CODES OR 200 lb PER LINEAR FOOT MINIMUM IN ANY GIVEN DIRECTION.
3. 7" (178 mm) PEEL & STICK FLASHING SHALL EXTEND 2" (51 mm) BEYOND EDGE OF CURB FLANGE.
4. 9" (229 mm) PEEL & STICK FLASHING SHALL BE CENTERED OVER 5" (127 mm) QUICKSEAM FLASHING SO THAT IT EXTENDS 2" (51 mm) BEYOND EDGE OF 7" (178 mm) PEEL & STICK FLASHING
5. FLANGE OF METAL MUST BE FULLY SUPPORTED BY WOOD AND TERMINATED AT LEAST 1/4" (6 mm) FROM EDGE OF WOOD.
6. REFER TO S2S-L-S-9 FOR SEAM2SEAM SEALANT APPLICATION.
7. REFER TO S2S-C-2 FOR OUTSIDE CORNER APPLICATION.