

STEP #1

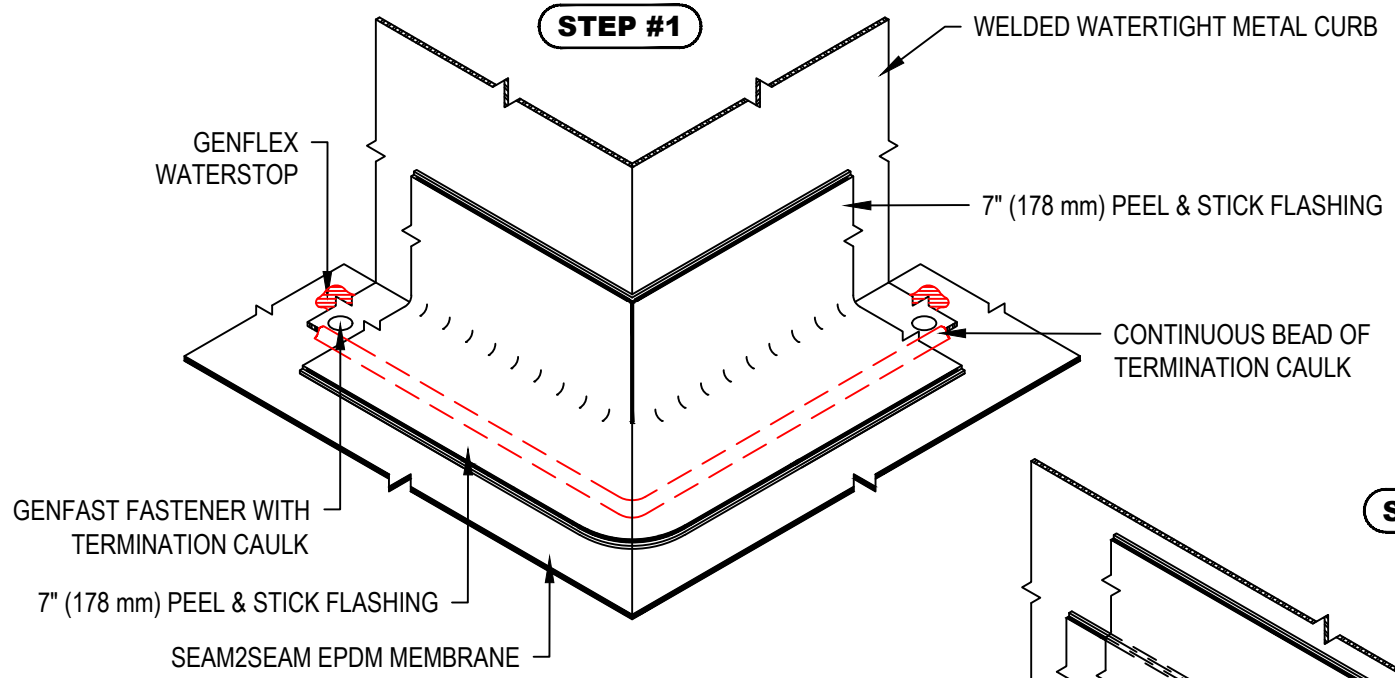

- NOTE:
1. REFER TO GENFLEX WEBSITE FOR THE MOST CURRENT INFORMATION.
 2. USE APPROPRIATE GENFLEX PRIMER TO CLEAN AND PRIME EPDM MATING SURFACES PRIOR TO INSTALLATION OF PEEL & STICK PRODUCTS.

STEP #2

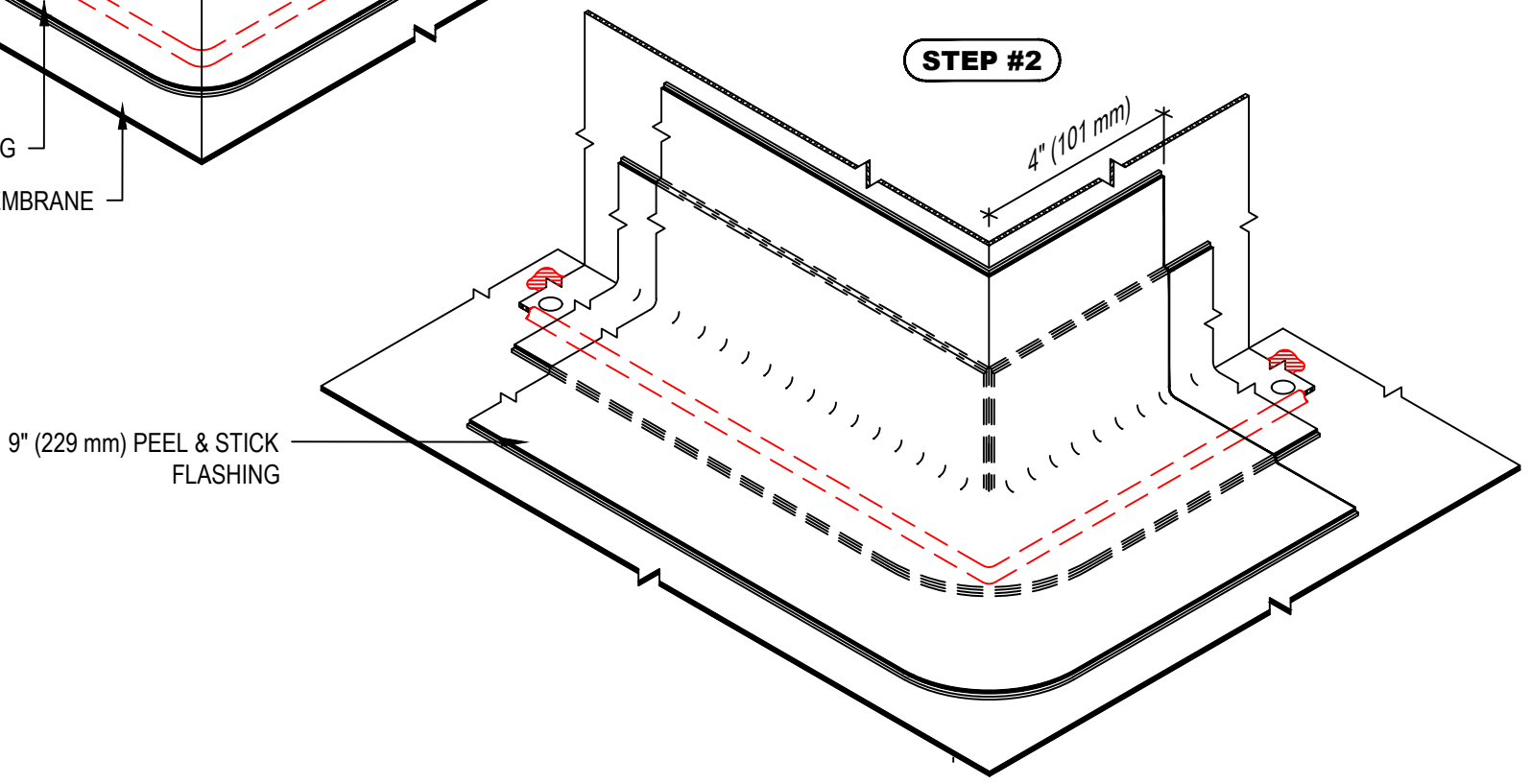

OUTSIDE CORNER AT WELDED WATERTIGHT CURB (FLANGES UNDER 2") - INSTALLATION STEPS 1 & 2

GENFLEX™

ACCEPTABLE SYSTEMS: **SEAM2SEAM™ EPDM**

MAXIMUM WARRANTY: 20 Years

ISSUE / REVISION DATE:
04/06/2020

DETAIL NO.
S2S-C-2A

GENFLEX: (800) 443-4272 www.genflex.com

NOT TO SCALE