

**NOTE:**

1. REFER TO GENFLEX WEBSITE FOR THE MOST CURRENT INFORMATION.
2. USE APPROPRIATE GENFLEX PRIMER TO CLEAN AND PRIME EPDM MATING SURFACES PRIOR TO INSTALLATION OF PEEL & STICK PRODUCTS.

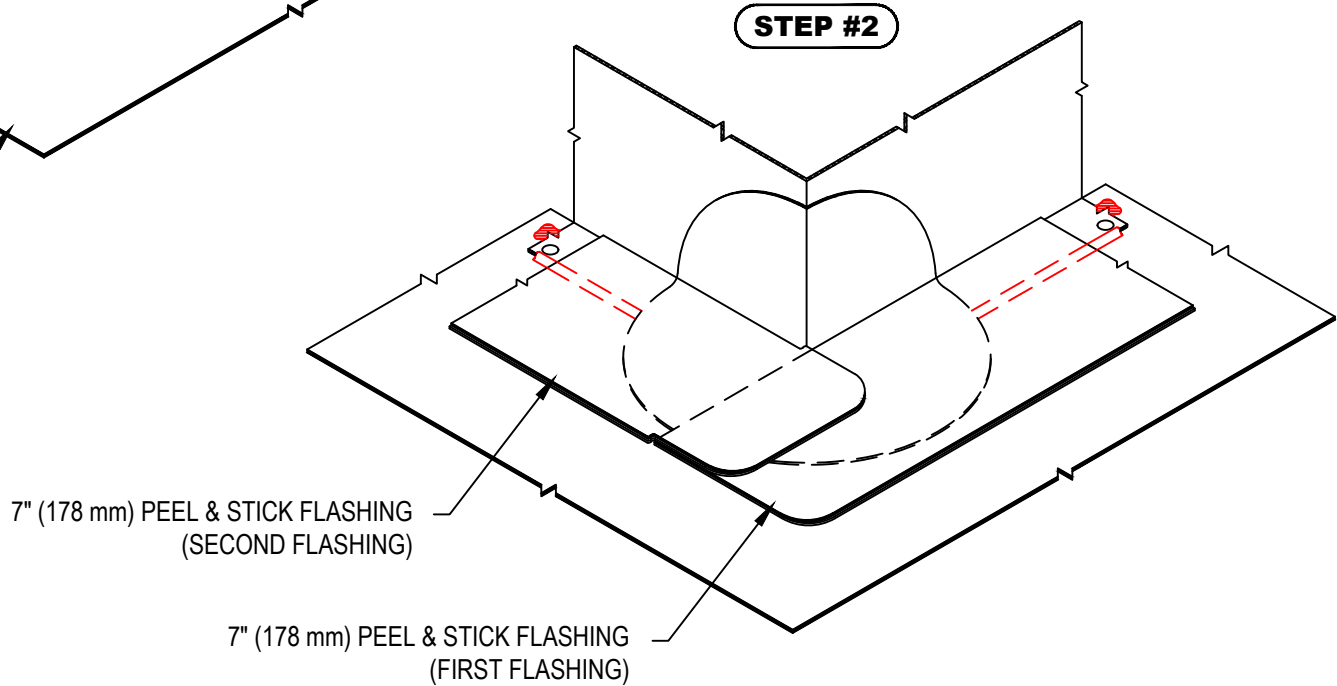
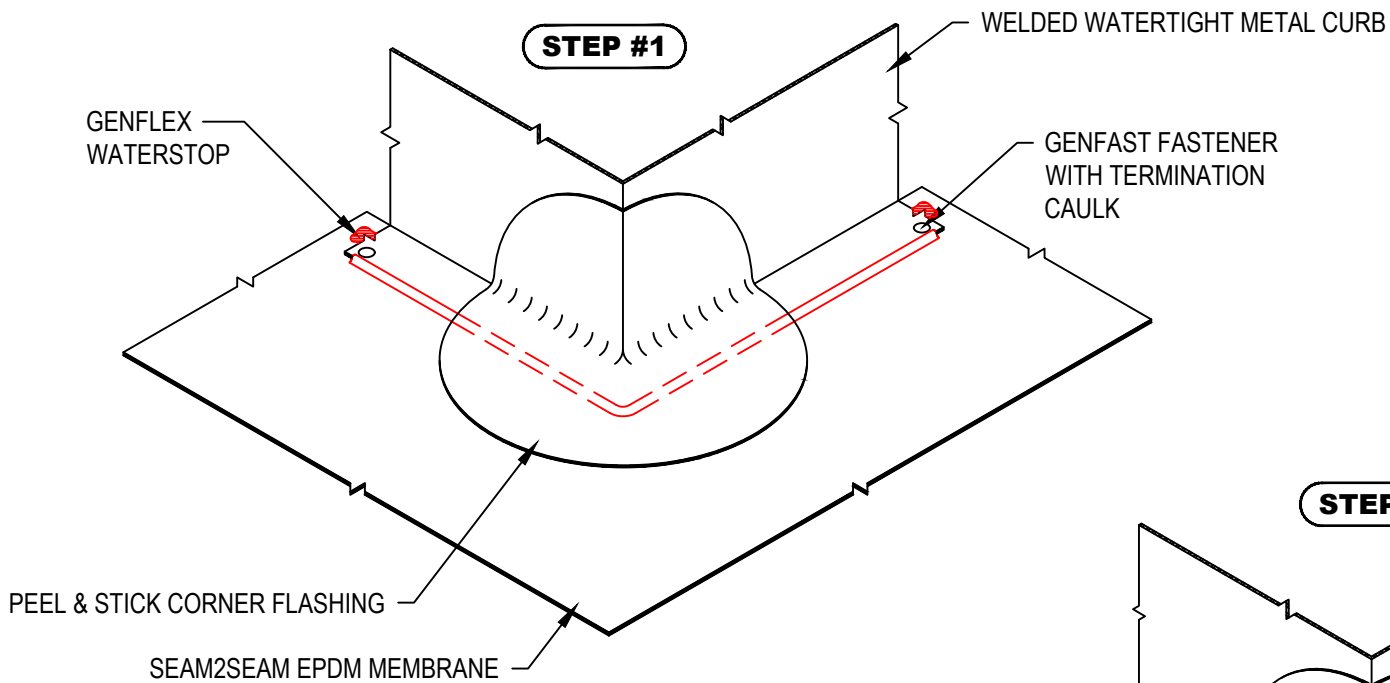

**OUTSIDE CORNER AT WELDED WATERTIGHT CURB (FLANGES 2" TO 3") - INSTALLATION STEPS 1 & 2**

**GENFLEX™**

ACCEPTABLE SYSTEMS: **SEAM2SEAM™ EPDM**

MAXIMUM WARRANTY: 20 Years

ISSUE / REVISION DATE:

04/06/2020

DETAIL NO.

**S2S-C-3A**

GENFLEX: (800) 443-4272 www.genflex.com

NOT TO SCALE