

**ROOF TO WALL
EXPANSION JOINT**

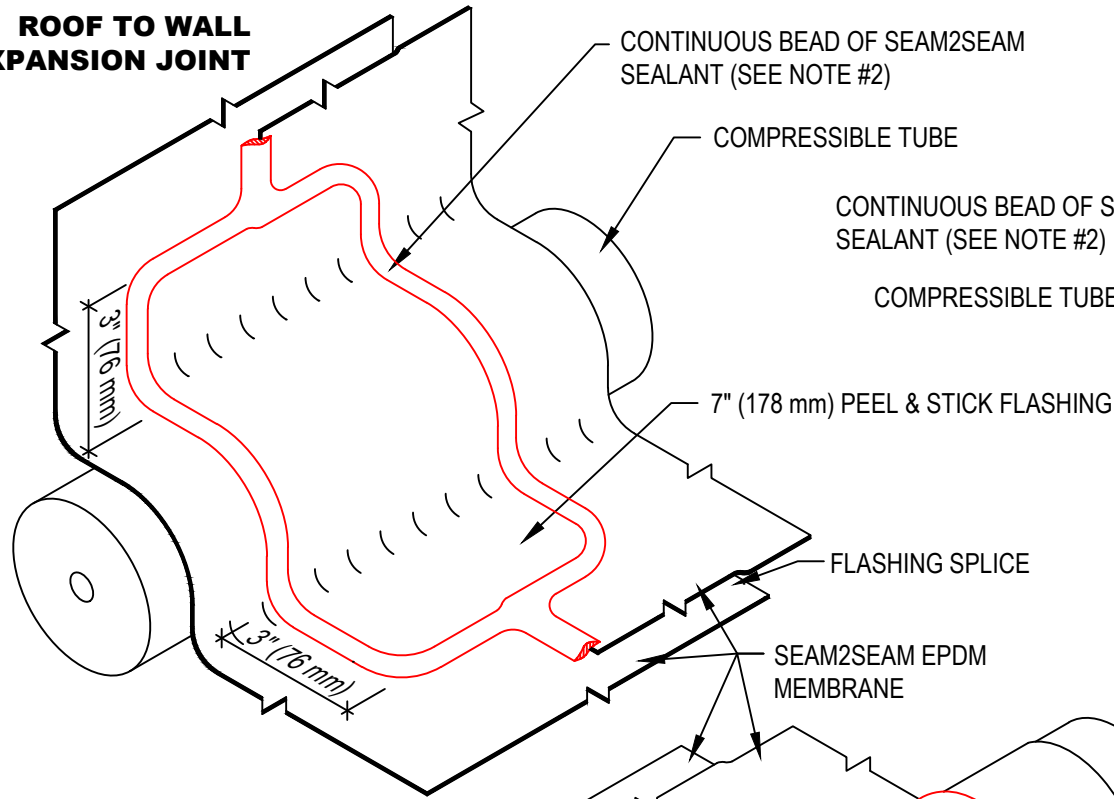

**CURB TO CURB
EXPANSION JOINT**

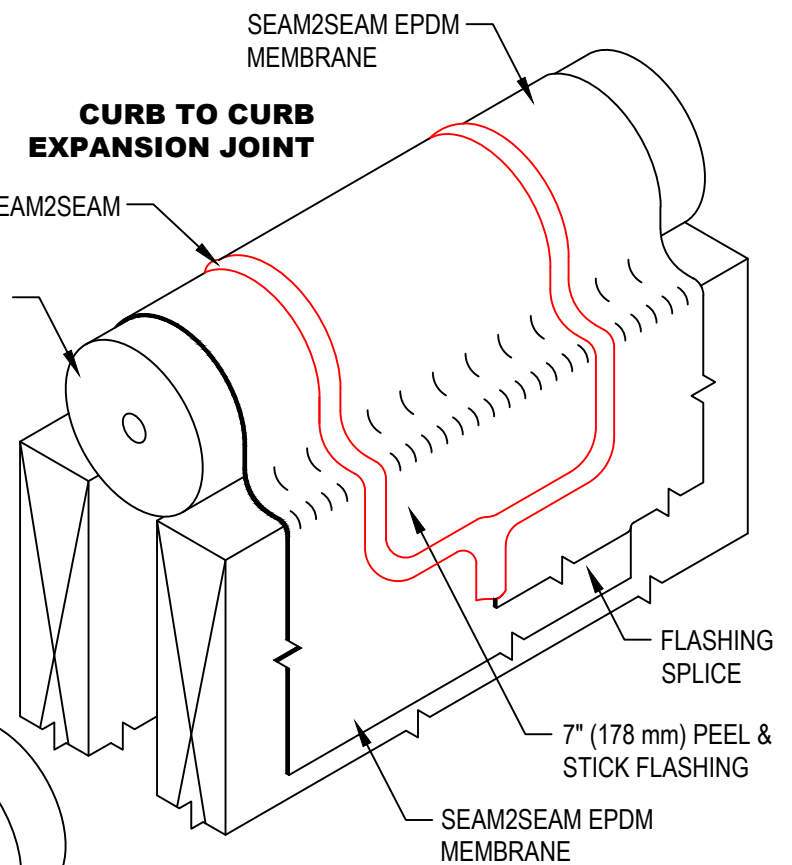

CONTINUOUS BEAD OF
SEAM2SEAM SEALANT
(SEE NOTE #2)

**ROOF TO ROOF
EXPANSION JOINT**

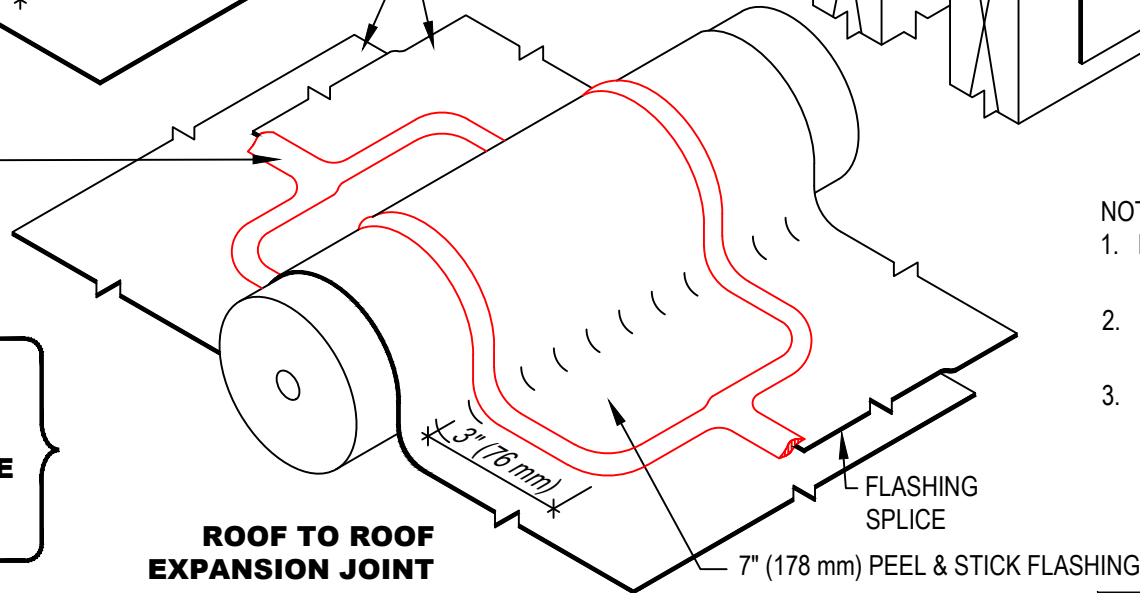

**BASE FLASHING AND
TERMINATIONS NOT
SHOWN FOR CLARITY.
REFER TO APPROPRIATE
TERMINATION & BASE
TIE-IN DETAILS.**

NOTE:

1. REFER TO GENFLEX WEBSITE FOR THE MOST CURRENT INFORMATION.
2. SEAM2SEAM SEALANT IS REQUIRED OVER ALL FIELD AND FLASHING SEAMS.
3. USE ACCEPTABLE GENFLEX PRIMER TO CLEAN AND PRIME EPDM MATING SURFACES PRIOR TO SEAM SPLICING AND INSTALLATION OF PEEL & STICK PRODUCTS.



LAP SPLICE AT EXPANSION JOINT TUBE

GENFLEX™

ACCEPTABLE SYSTEMS: **SEAM2SEAM™ EPDM**

GENFLEX: (800) 443-4272 www.genflex.com

MAXIMUM WARRANTY: 20 Years

ISSUE / REVISION
DATE:

04/06/2020

NOT TO SCALE

DETAIL NO.

S2S-LS-13