

NOTE:

1. REFER TO SEAM2SEAM WEBSITE FOR THE MOST CURRENT INFORMATION.
2. USE ACCEPTABLE GENFLEX PRIMER TO CLEAN AND PRIME EPDM MATING SURFACE PRIOR TO INSTALLATION OF PEEL&STICK PRODUCTS.
3. ALLOW PRIMER TO FLASH OFF APPROPRIATELY BEFORE APPLYING FLASHING OR SEALANT.
4. EXTRA CLEANING IS REQUIRED AT FACTORY SPLICE AREAS AND OTHER AREAS WHERE EXCESS DUSTING AGENTS MAY HAVE ACCUMULATED.

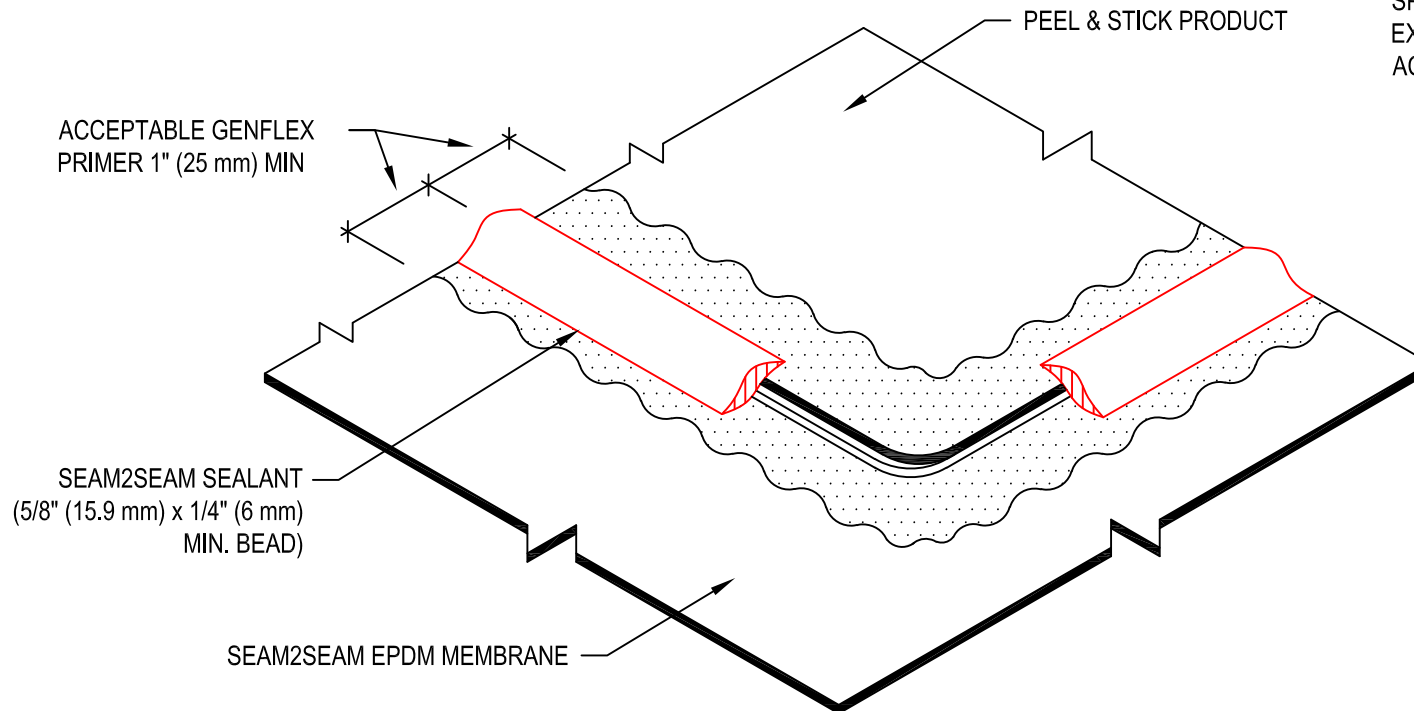

**SEAM EDGE TREATMENT
FOR PEEL & STICK PRODUCTS**

GENFLEX™

ACCEPTABLE SYSTEMS: **SEAM2SEAM™ EPDM**

MAXIMUM WARRANTY: 20 Years

ISSUE / REVISION
DATE:

01/06/2023

DETAIL NO.

S2S-LS-9

GENFLEX: (800) 443-4272 www.genflex.com

NOT TO SCALE