

**NOTE:**

1. STEP #1 - APPLY CONTINUOUS BEAD OF GENFLEX WATERSTOP BENEATH METAL, CENTERED UNDER FASTENERS. SECURE METAL SCUPPER SLEEVE WITH APPROPRIATE FASTENERS. ROUND ALL METAL CORNERS.
2. STEP #2 - STRIP IN EXPOSED EDGES OF SCUPPER WITH 7" (178 mm) PEEL & STICK FLASHING STARTING WITH SIDES OF SCUPPER.
3. USE ACCEPTABLE GENFLEX PRIMER TO CLEAN AND PRIME MATING SURFACES PRIOR TO INSTALLATION OF PEEL & STICK PRODUCTS.
4. SCUPPER MUST BE WELDED METAL SLEEVE WITH 3" (76 mm) FLANGE.

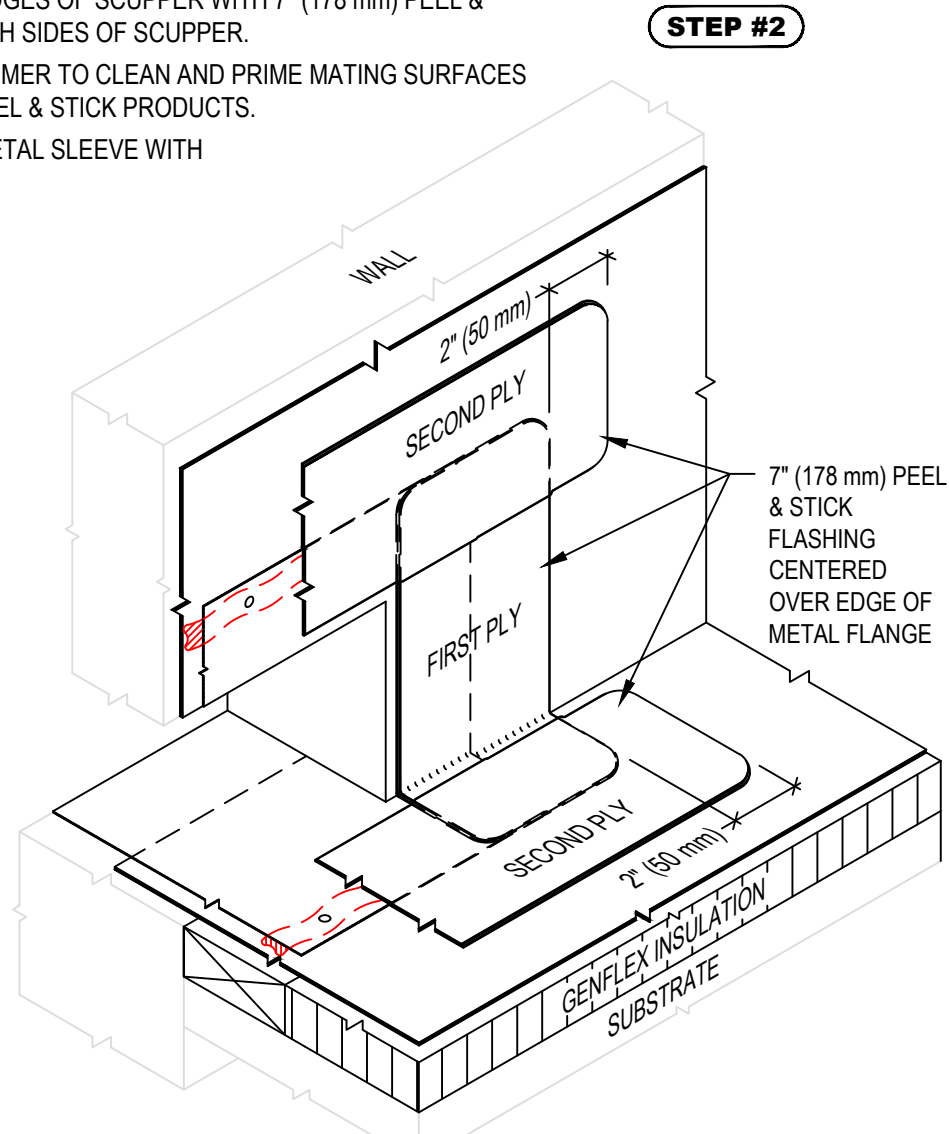
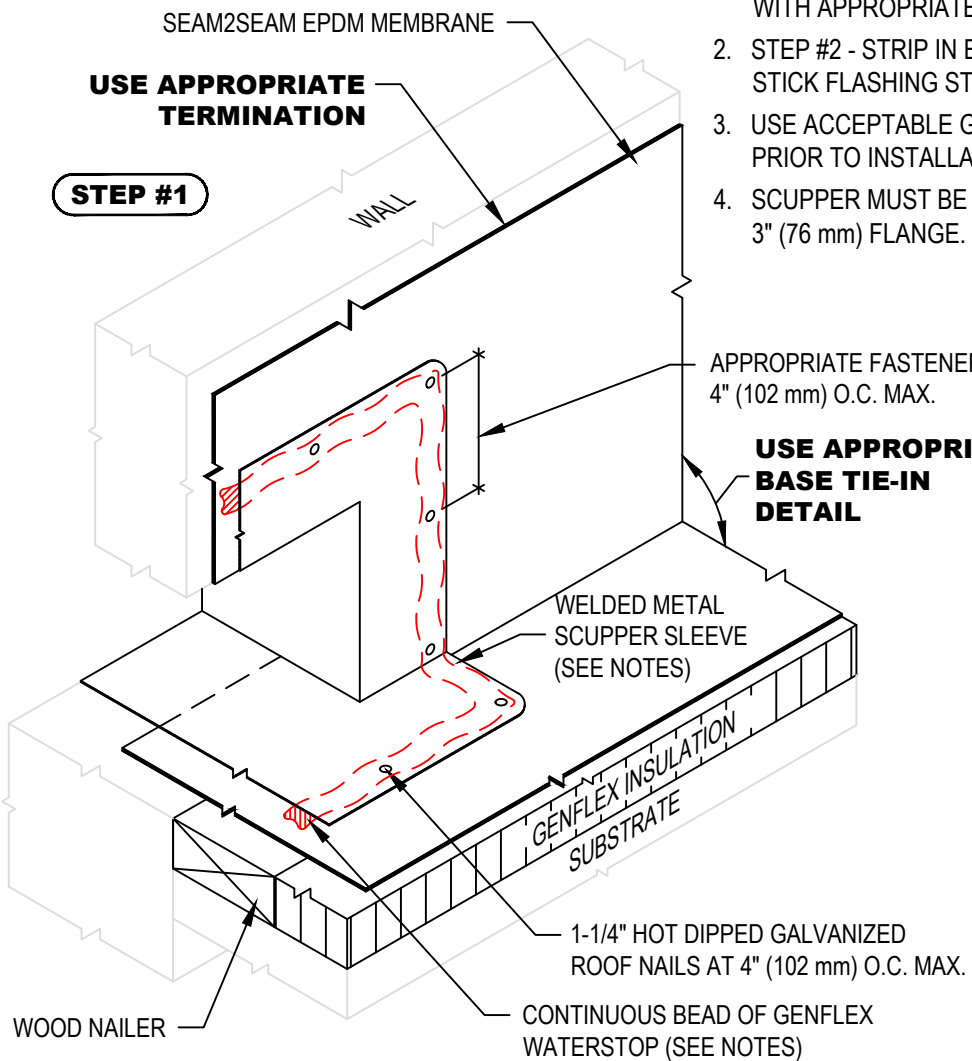

	<b>THRU-WALL SCUPPER (WELDED SLEEVE) INSTALLATION STEPS 1 &amp; 2</b>		MAXIMUM WARRANTY: 20 Years	
	<b>GENFLEX™</b>	ACCEPTABLE SYSTEMS: <b>SEAM2SEAM™ EPDM</b>	ISSUE / REVISION DATE: 04/06/2020	DETAIL NO. <b>S2S-S-1A</b>
GENFLEX: (800) 443-4272 www.genflex.com			NOT TO SCALE	