

**USE APPROPRIATE TERMINATION**

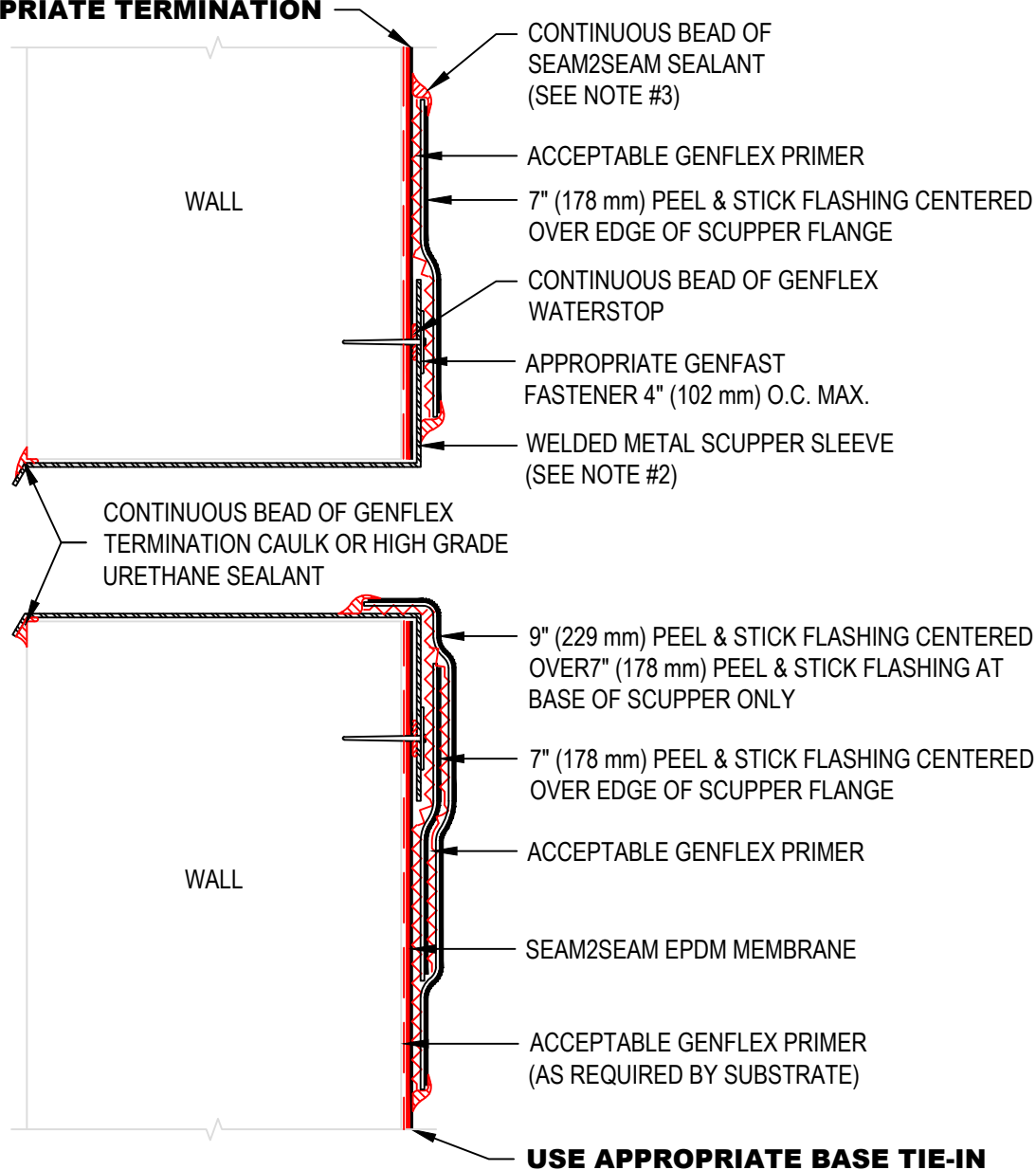

**NOTE:**

1. REFER TO GENFLEX WEBSITE FOR MOST CURRENT INFORMATION.
2. SCUPPER MUST BE WELDED METAL SLEEVE, ROUND ALL SHEET METAL FLANGE CORNERS.
3. APPLY SEAM2SEAM SEALANT AROUND ENTIRE PERIMETER OF PEEL & STICK PRODUCTS. REFER TO S2S-LS-9 FOR PEEL & STICK EDGE TREATMENT.



**OVERFLOW THRU-WALL SCUPPER  
(WELDED SLEEVE)**

**GENFLEX™**

ACCEPTABLE SYSTEMS: **SEAM2SEAM™ EPDM**

MAXIMUM WARRANTY: 20 Years

ISSUE / REVISION  
DATE:

04/06/2020

DETAIL NO.

**S2S-S-2**

GENFLEX: (800) 443-4272 www.genflex.com

NOT TO SCALE