

USE APPROPRIATE TERMINATION

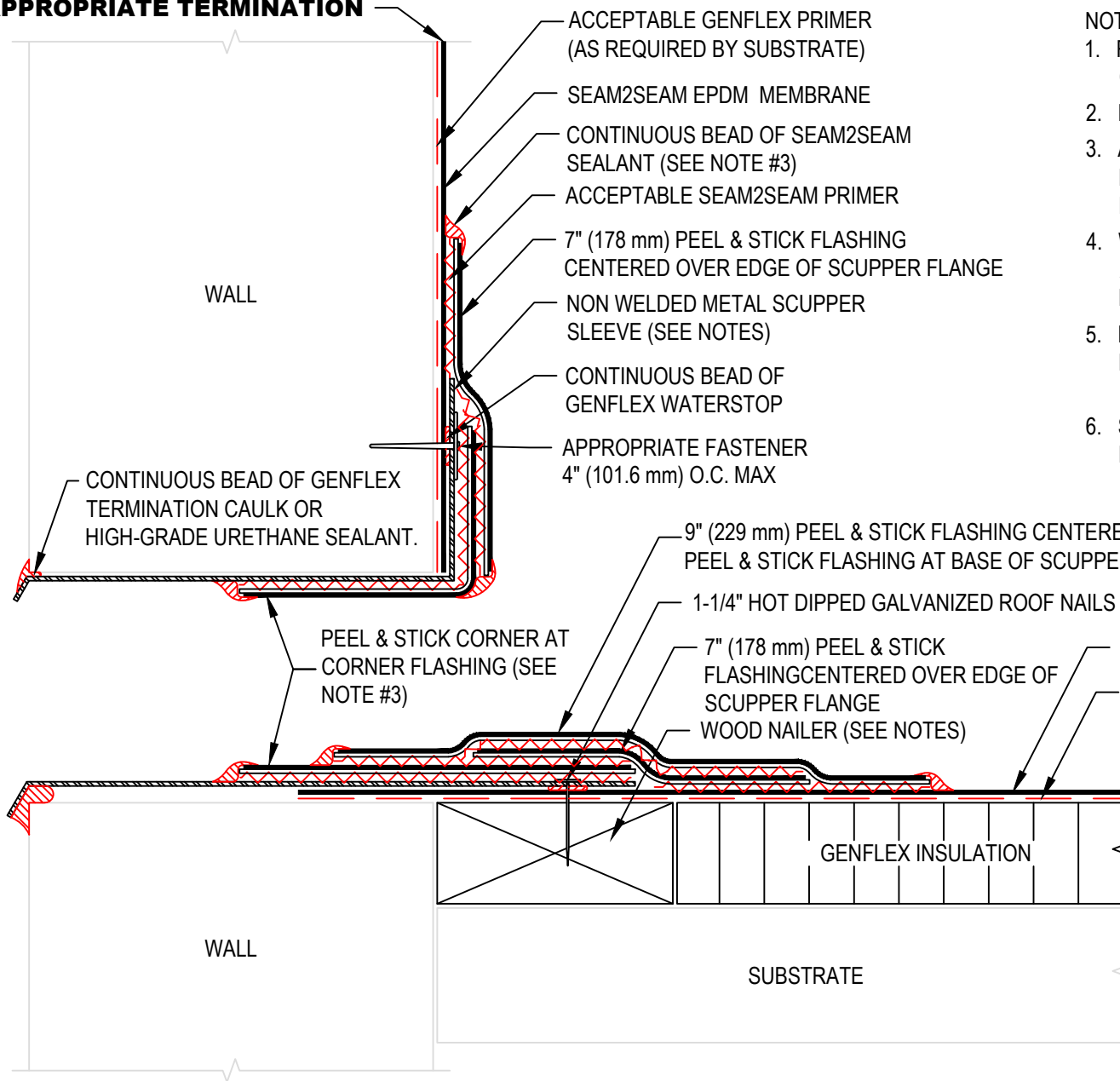

NOTE:

1. REFER TO GENFLEX WEBSITE FOR MOST CURRENT INFORMATION.
2. ROUND ALL SHEET METAL FLANGE CORNERS.
3. APPLY SEAM2SEAM SEALANT AROUND ENTIRE PERIMETER OF FLASHING. REFER TO S2S-LS-9 FOR PEEL & STICK EDGE TREATMENT.
4. WOOD NAILER MUST BE INSTALLED TO MEET APPLICABLE BUILDING CODES OR 200 lb PER LINEAR FOOT IN ANY GIVEN DIRECTION.
5. FLANGE OF METAL MUST BE FULLY SUPPORTED BY WOOD AND TERMINATED AT LEAST 1/2" (13 mm) FROM EDGE OF WOOD.
6. SEE S2S-S-3A, S2S-S-3B, AND S2S-S-3C FOR DETAILED INSTALLATION INSTRUCTIONS.



THRU-WALL SCUPPER (NON-WELDED SLEEVE)

GENFLEX™

ACCEPTABLE SYSTEMS: **SEAM2SEAM™ EPDM**

GENFLEX: (800) 443-4272 www.genflex.com

MAXIMUM WARRANTY: 20 Years

ISSUE / REVISION DATE:

04/06/2020

NOT TO SCALE

DETAIL NO.

S2S-S-3