

NOTE:

1. REFER TO GENFLEX WEBSITE FOR MOST CURRENT INFORMATION.
2. STEP #3 - STRIP IN ALL EXPOSED EDGES OF SCUPPER AS INDICATED WITH 7" (178 mm) PEEL & STICK FLASHING STARTING WITH SIDES OF SCUPPER.
3. STEP #4 - CENTER STRIP OF 9" (229 mm) PEEL & STICK FLASHING OVER 7" (178 mm) PEEL & STICK FLASHING AT BASE OF SCUPPER AS SHOWN.
4. USE ACCEPTABLE FIRESTONE PRIMER TO CLEAN AND PRIME EPDM MATING SURFACES PRIOR TO INSTALLATION OF QUICKSEAM PRODUCTS.

STEP #4

USE APPROPRIATE TERMINATION

STEP #3

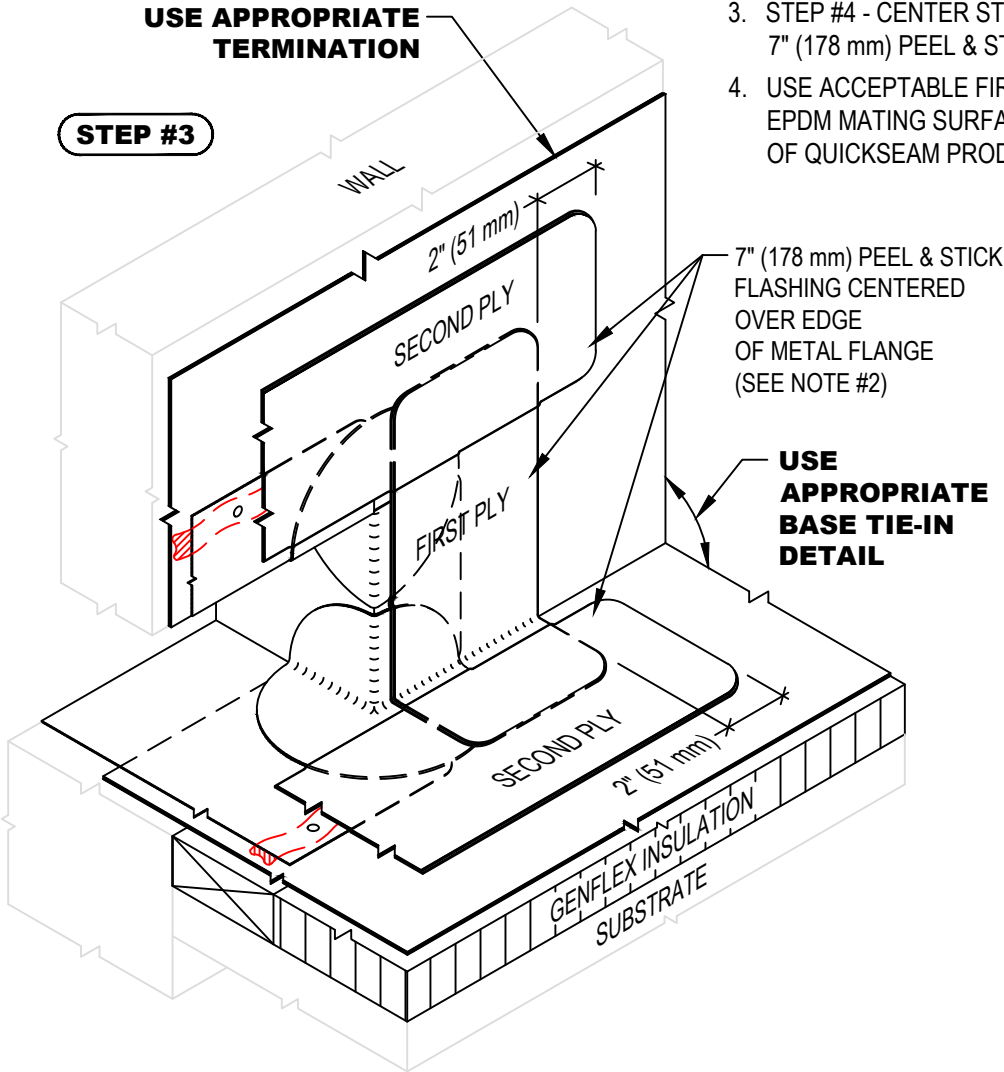

7" (178 mm) PEEL & STICK FLASHING CENTERED OVER EDGE OF METAL FLANGE (SEE NOTE #2)

USE APPROPRIATE BASE TIE-IN DETAIL

9" (229 mm) PEEL & STICK FLASHING CENTERED OVER 7" (178 mm) PEEL & STICK FLASHING (SEE NOTE #3)

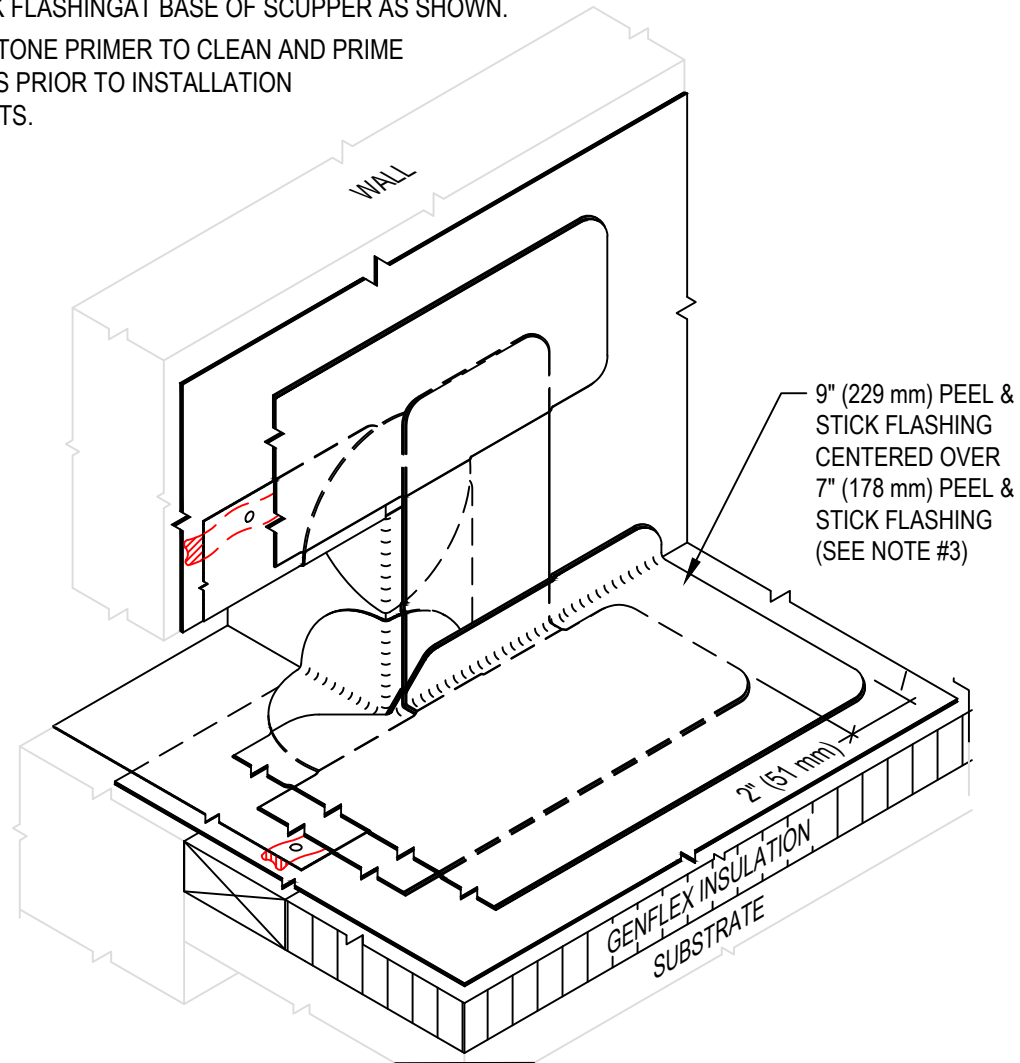

**THRU-WALL SCUPPER (NON-WELDED SLEEVE)
INSTALLATION STEPS 3 & 4**

GENFLEX™

ACCEPTABLE SYSTEMS: **SEAM2SEAM™ EPDM**

MAXIMUM WARRANTY: 20 Years

ISSUE / REVISION DATE:

04/06/2020

DETAIL NO.

S2S-S-3B

GENFLEX: (800) 443-4272 www.genflex.com

NOT TO SCALE