

NOTE:

1. REFER TO GENFLEX WEBSITE FOR MOST CURRENT INFORMATION.
2. STEP #5 - APPLY SEAM2SEAM SEALANT TO PERIMETER OF FLASHING. REFER TO S2S-LS-9 FOR PEEL & STICK EDGE TREATMENT.

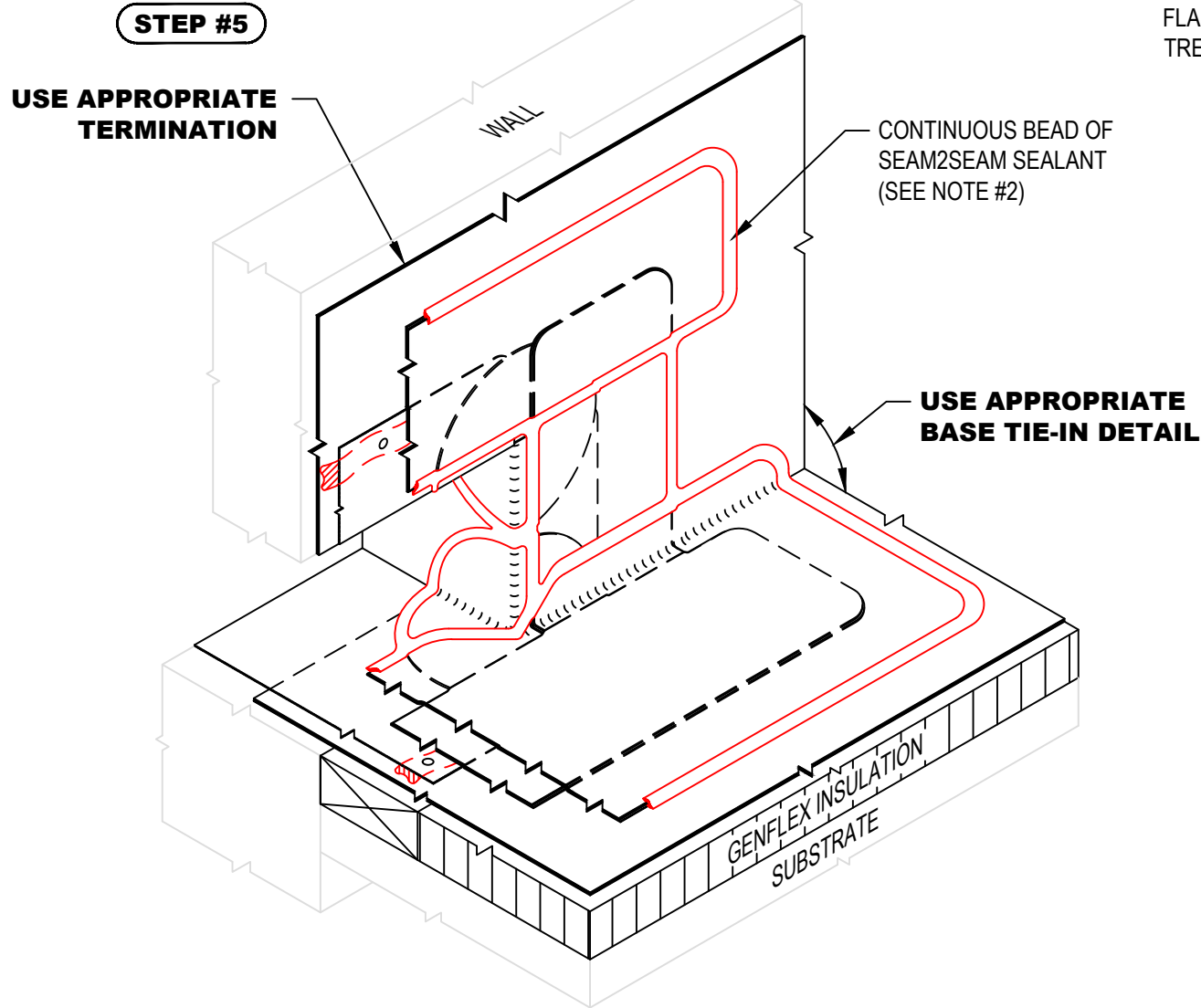

**THRU-WALL SCUPPER (NON-WELDED SLEEVE)
INSTALLATION STEP 5**

GENFLEX™

ACCEPTABLE SYSTEMS: **SEAM2SEAM™ EPDM**

GENFLEX: (800) 443-4272 www.genflex.com

MAXIMUM WARRANTY: 20 Years

ISSUE / REVISION
DATE:

04/06/2020

NOT TO SCALE

DETAIL NO.

S2S-S-3C