

USE APPROPRIATE TERMINATION

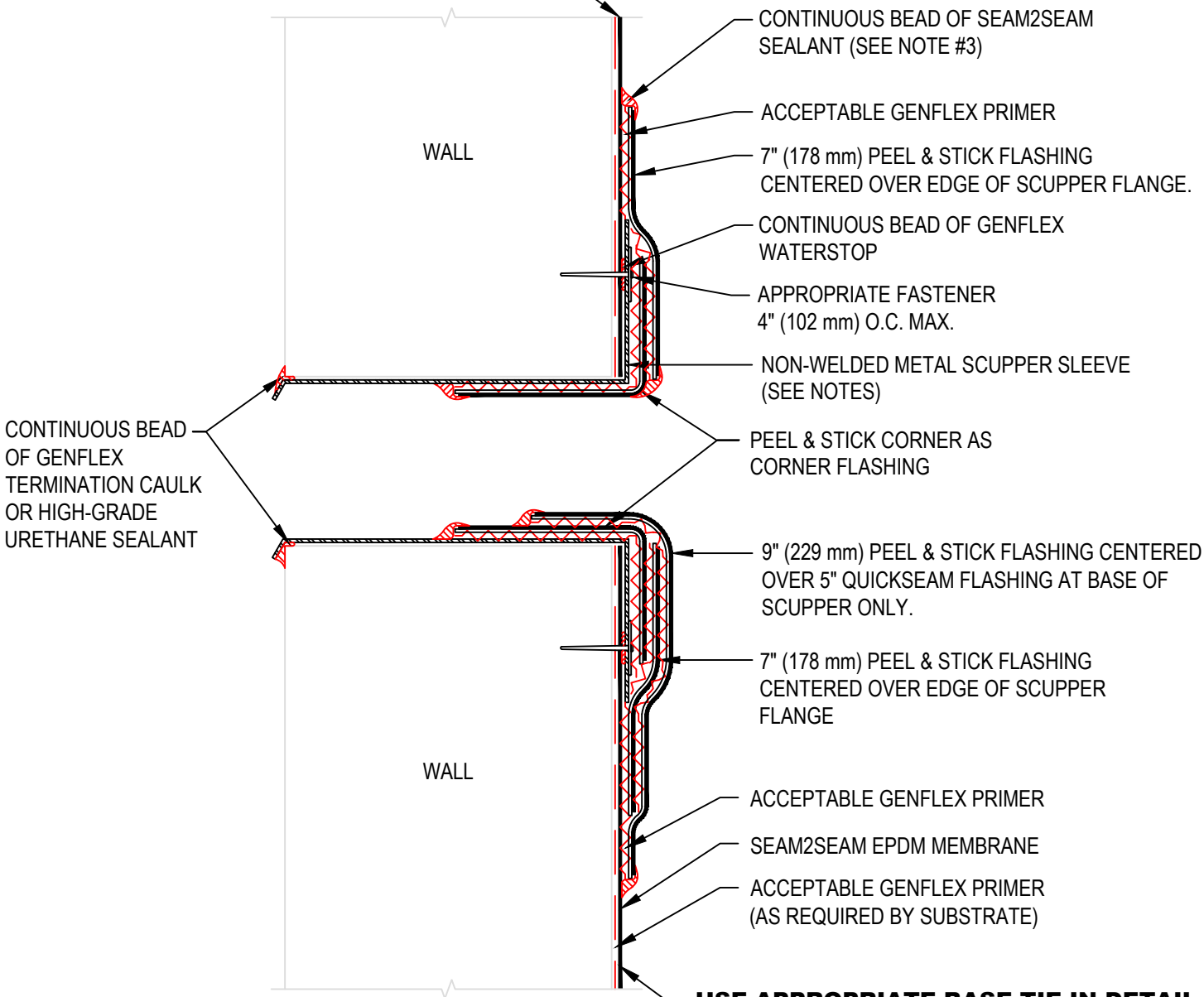

NOTE:

1. REFER TO GENFLEX WEBSITE FOR MOST CURRENT INFORMATION.
2. ROUND ALL SHEET METAL FLANGE CORNERS.
3. APPLY SEAM2SEAM SEALANT AROUND ENTIRE PERIMETER OF FLASHING. REFER TO S2S-LS-9 FOR PEEL & STICK EDGE TREATMENT.
4. SEE S2S-S-4A, S2S-S-4B & S2S-S-4C FOR DETAILED INSTALLATION INSTRUCTIONS.



**OVERFLOW THRU-WALL SCUPPER
(NON-WELDED SLEEVE)**

GENFLEX™

ACCEPTABLE SYSTEMS: **SEAM2SEAM™ EPDM**

MAXIMUM WARRANTY: 20 Years

ISSUE / REVISION
DATE:

04/06/2020

DETAIL NO.

S2S-S-4

GENFLEX: (800) 443-4272 www.genflex.com

NOT TO SCALE