

NOTE:

1. REFER TO GENFLEX WEBSITE FOR MOST CURRENT INFORMATION.
2. INSTALL GENFAST TERMINATION BAR WITH 1/4" (6 mm) GAP BETWEEN ADJOINING SECTIONS.
3. CUT TERMINATION BAR AT INSIDE AND OUTSIDE CORNERS. **DO NOT BEND AROUND CORNERS.**
4. TERMINATION BAR MUST BE FASTENED WITHIN 1" (25 mm) MAX. OF ALL SECTION ENDS.
5. APPLY WATERSTOP IN A 3/8" (10 mm) TO 1/2" (13 mm) BEAD AT APPROXIMATELY 10 LF PER TUBE.

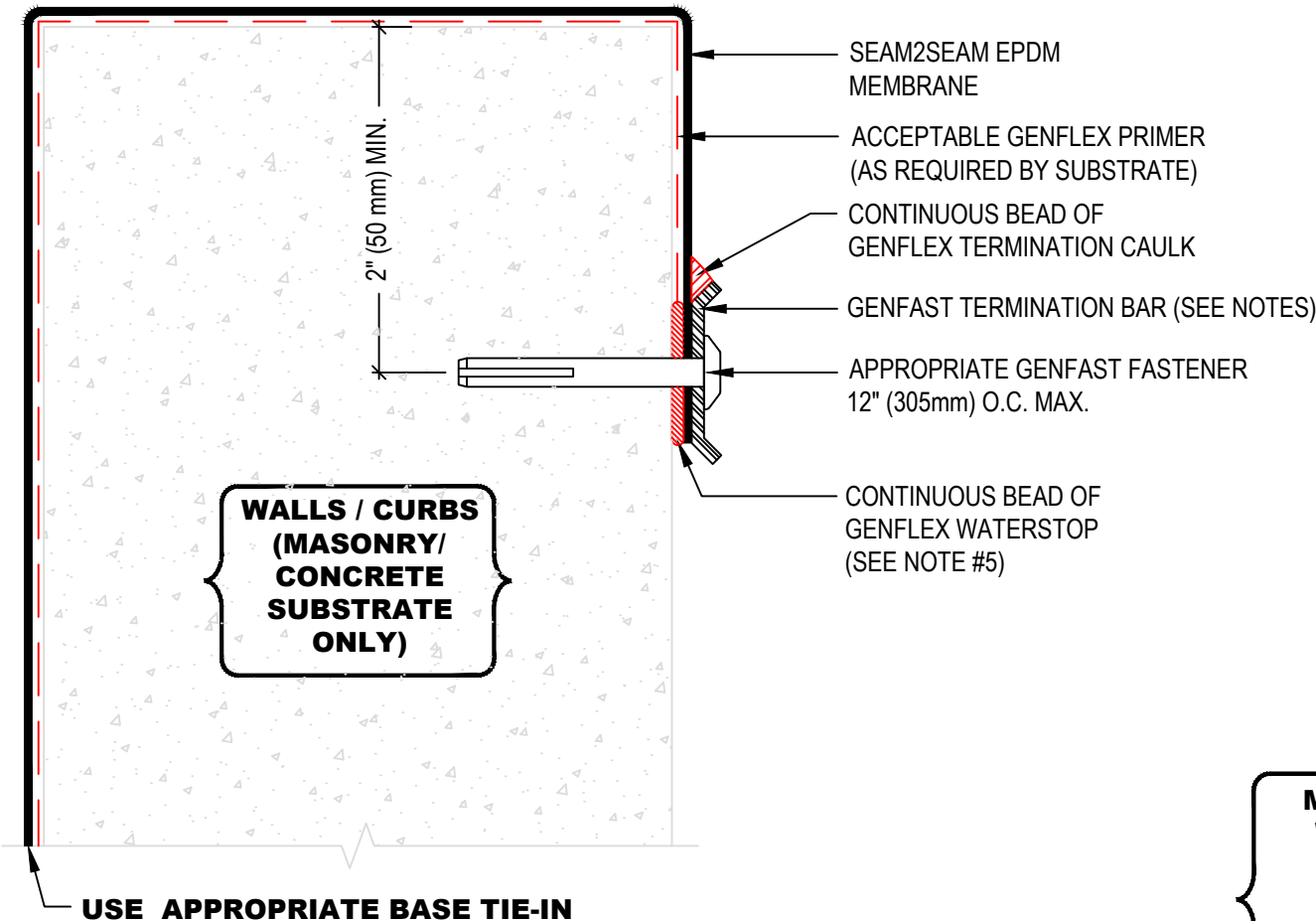

MASONRY AND CONCRETE WALLS / CURBS MUST BE WATERPROOFED AND MAINTAINED IN ORDER FOR ANY SURFACE MOUNTED TERMINATION TO BE EFFECTIVE.



TERMINATION ON OUTSIDE OF PARAPET WALL WITH TERMINATION BAR

GENFLEX™

ACCEPTABLE SYSTEMS: **SEAM2SEAM™ EPDM**

MAXIMUM WARRANTY: 20 Years

ISSUE / REVISION DATE:

04/06/2020

DETAIL NO.

S2S-T-2

GENFLEX: (800) 443-4272 www.genflex.com

NOT TO SCALE