

SEAM2SEAM SEALANT AT LAP SPLICE REQUIRED WHEN NOT COVERED WITH PEEL & STICKCOVER TAPE

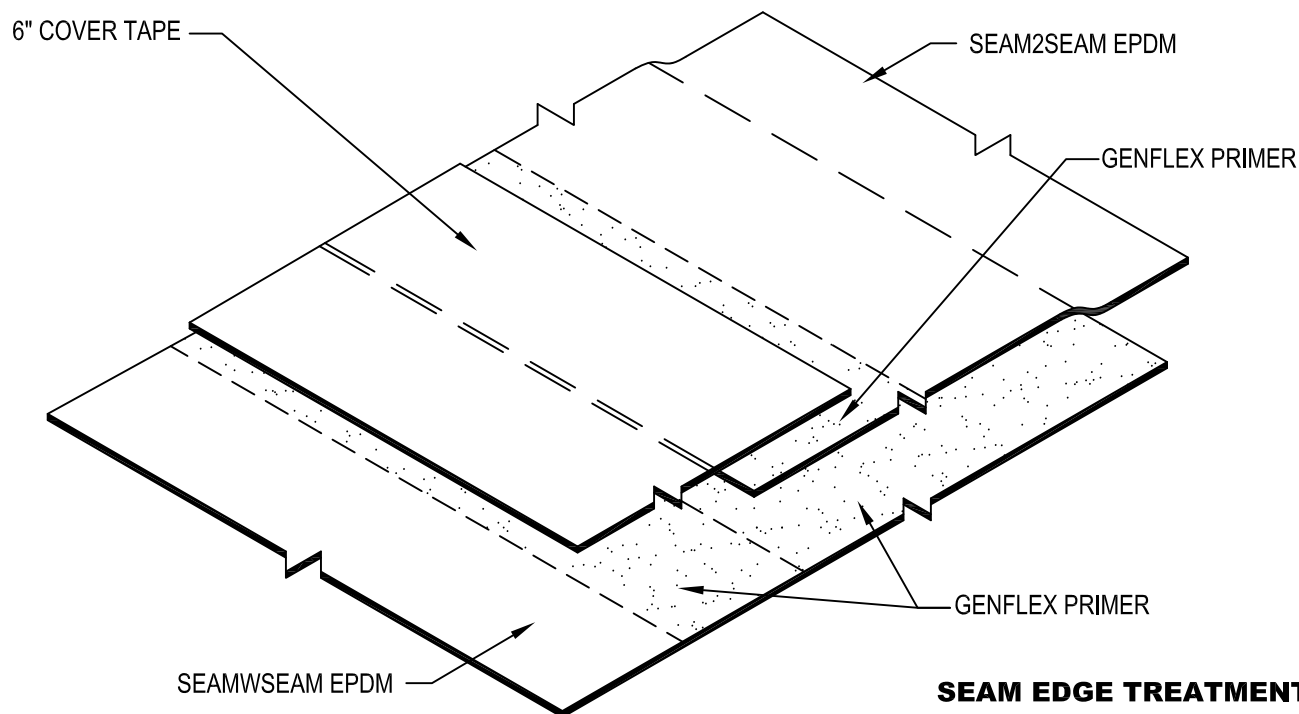

NOTES:

1. REFER TO GENFLEX WEBSITE FOR THE MUST CURRENT INFORMATION.
2. ALLOW PRIMER TO FLASH OFF BEFORE APPLYING LAP SEALANT.
3. USE ACCEPTABLE GENFLEX PRIMER TO CLEAN AND PRIME EPDM MATING SURFACE PRIOR TO REMOVAL OF SEAM2SEAM SEAM RELEASE LINERS AND INSTALLATION OF PEEL & STICK PRODUCTS.
4. EXTRA CLEANING IS REQUIRED AT FACTORY SPLICE AREAS AND OTHER AREAS WHERE EXCESS DUSTING AGENTS MAY HAVE ACCUMULATED.
5. SEAMS MAY RUN PARALLEL TO SLOPE.
6. GENFLEX SEALANT IS REQUIRED OVER ALL FIELD AND FLASHING SEAM EDGES.

SEAM EDGE TREATMENT FOR PEEL & STICK PRODUCTS

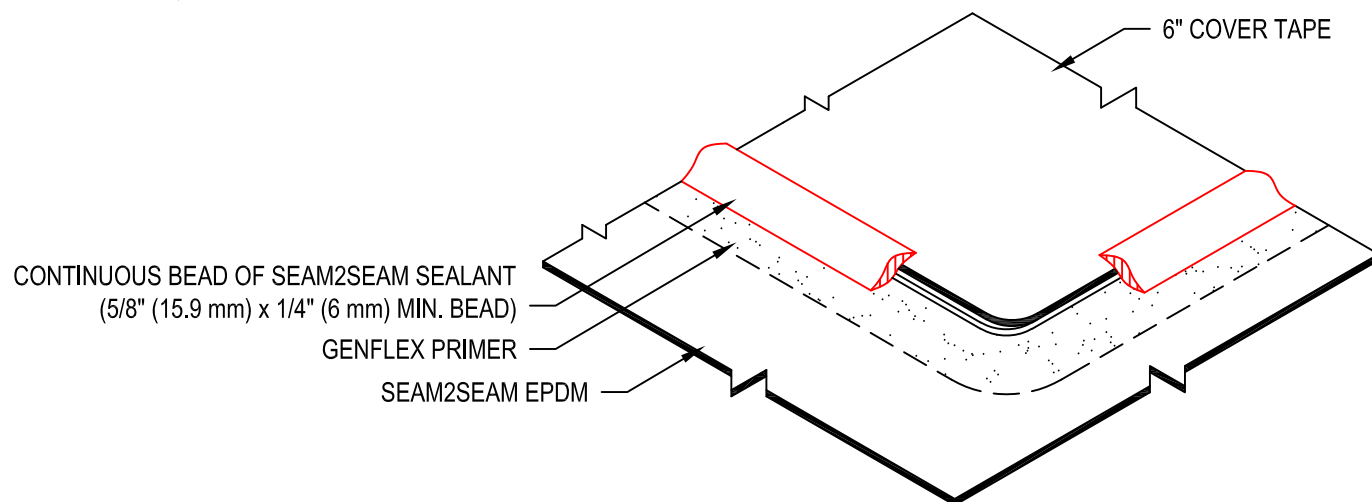

HEAD LAP SPLICE WITH 6" COVER TAPE

GENFLEX™

ACCEPTABLE SYSTEMS: **SEAM2SEAM™ EPDM**

GENFLEX: (800) 443-4272 www.genflex.com

MAXIMUM WARRANTY: 20 Years

ISSUE / REVISION
DATE:

01/05/2023

NOT TO SCALE

DETAIL NO.

S2S-LS-2