

NOTE:

1. REFER TO GENFLEX WEBSITE FOR THE MOST CURRENT INFORMATION.
2. GENFLEX SEALANT IS REQUIRED OVER ALL FIELD AND FLASHING SEAMS. REFERENCE S2S-LS-1 FOR SEAM EDGE TREATMENT. PRIME AREAS WHERE GENFLEX SEALANT IS REQUIRED PRIOR TO APPLICATION.
3. USE ACCEPTABLE GNEFLEX PRIMER TO CLEAN AND PRIME EPDM MATING SURFACES PRIOR TO SEAM SPLICING AND INSTALLATION OF PEEL & STICK PRODUCTS.
4. EXTRA CLEANING IS REQUIRED AT FACTORY SPLICE AREAS AND OTHER AREAS WHERE EXCESS DUSTING AGENTS MAY HAVE ACCUMULATED.
5. (2) T-JOINT COVERS - PLACE ONE OVER EACH T-JOINT BETWEEN PEEL & STICK FLASHING.

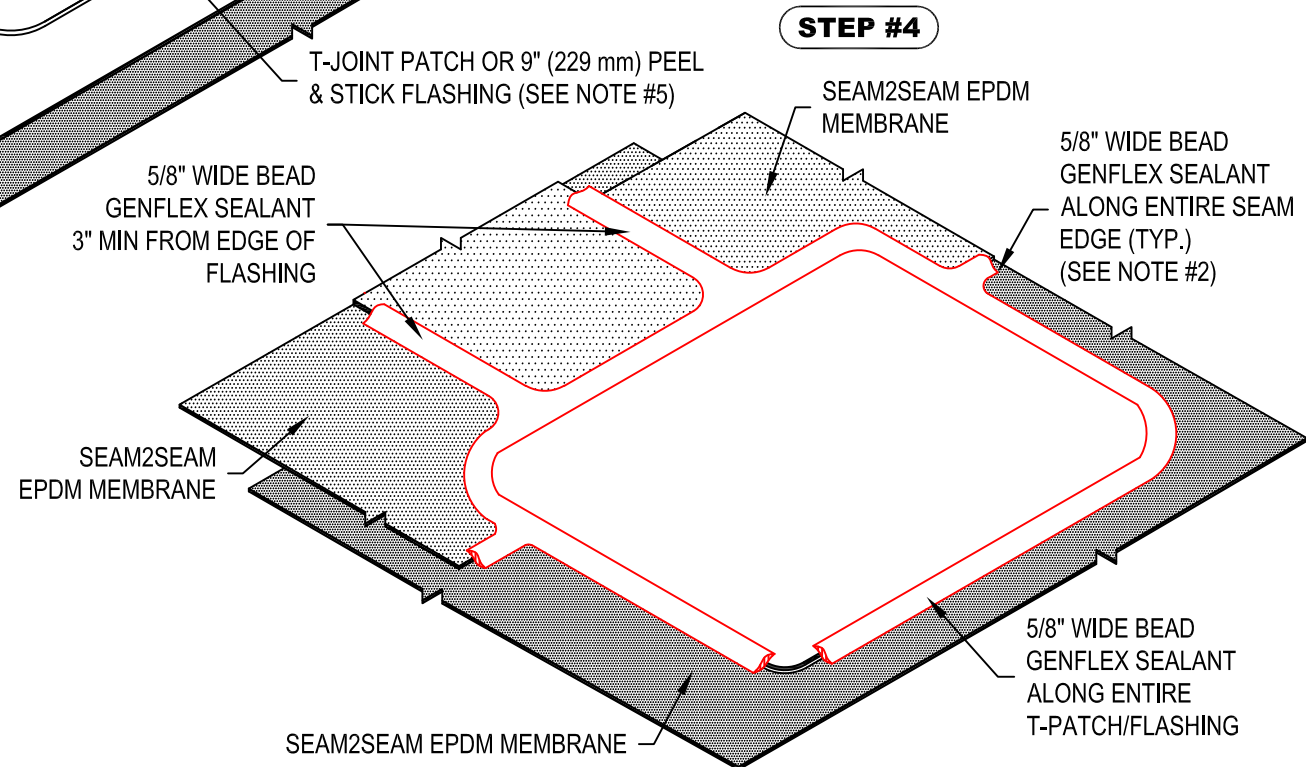

LAP SPLICE WITH HEADLAP OVER FIELD SEAM USING 7" PEEL & STICK FLASHING (INSTALLATION STEPS 1 & 2)

GENFLEX™

ACCEPTABLE SYSTEMS: **SEAM2SEAM™ EPDM**

GENFLEX: (800) 443-4272 www.genflex.com

MAXIMUM WARRANTY: 20 Years

ISSUE / REVISION
DATE:

01/05/2023

NOT TO SCALE

DETAIL NO.

S2S-LS-5B