

USE APPROPRIATE TERMINATION

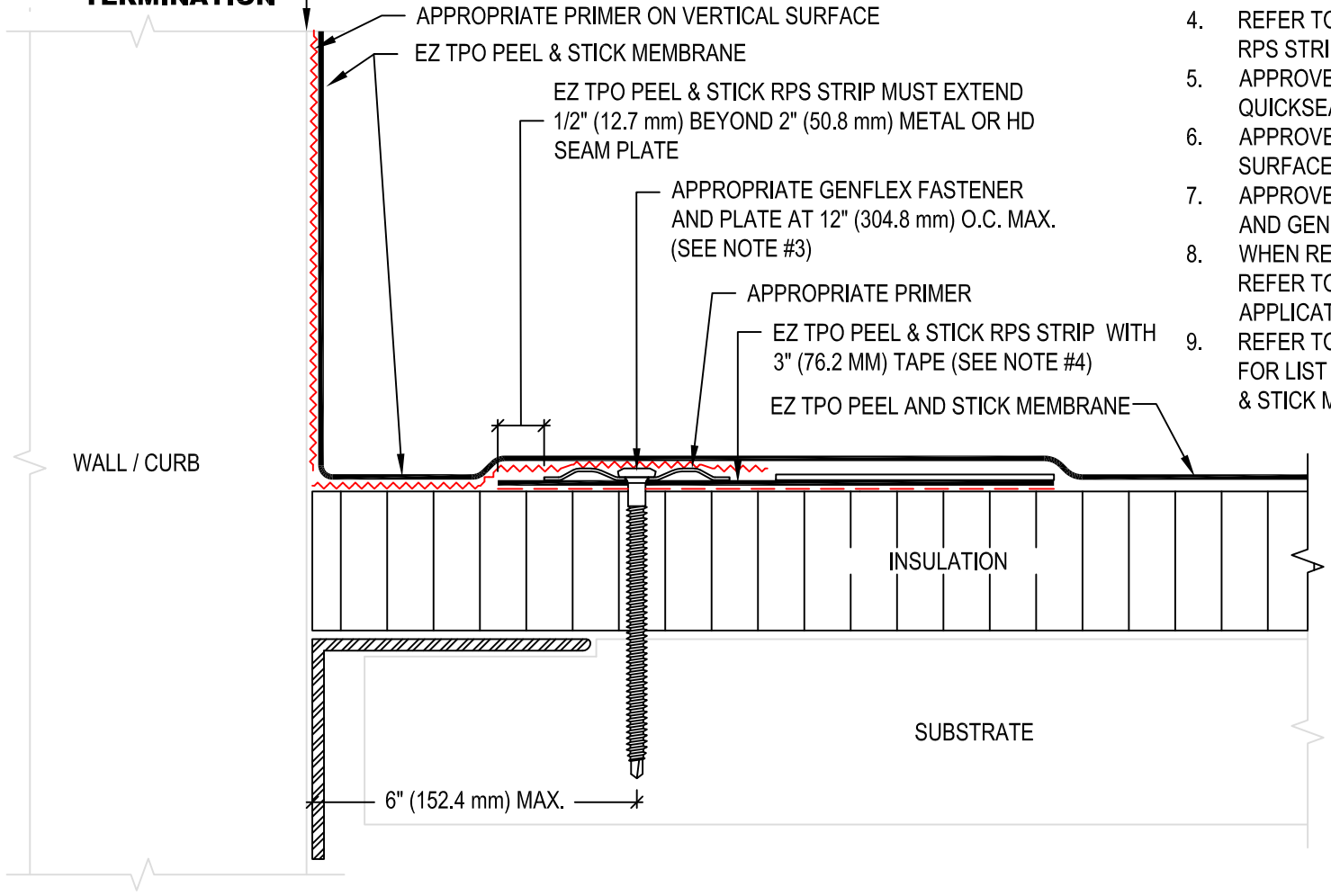

NOTE:

1. REFER TO THE GENFLEX™ WEBSITE FOR MOST CURRENT INFORMATION.
2. REFER TO DETAIL EZT-PS-LS-01 OR EZT-PS-LS-02 FOR WELD WIDTH.
3. MAXIMUM 10" (254 mm) LONG FASTENERS. (NOTE: WOOD BLOCKING MAY BE SUBSTITUTED FOR INSULATION TO REDUCE FASTENER LENGTH REQUIREMENT).
4. REFER TO EZT-PS-BT-08 & EZT-PS-BT-09 FOR QUICKSEAM RPS STRIP LAYOUT AT CORNERS.
5. APPROVED MEMBRANE ADHESIVE REQUIRED BETWEEN QUICKSEAM RPF STRIP AND INSULATION.
6. APPROVED PRIMER REQUIRED ON ALL VERTICAL SURFACES.
7. APPROVED PRIMERS INCLUDE GENFLEX CLEAR PRIMER AND GENFLEX CLEAR LVOC PRIMER.
8. WHEN REINFORCEMENT OF TPO MEMBRANE IS EXPOSED, REFER TO EZT-PS-LS-04 FOR CUT EDGE SEALANT APPLICATION.
9. REFER TO GENFLEX TIS SHEETS AND APPLICATION GUIDES FOR LIST OF COMPATIBLE SUBSTRATES WITH EZ TPO PEEL & STICK MEMBRANE.



BASE TIE-IN WITH EZ TPO PEEL & STICK™ RPS STRIP AND GENFAST™ FASTENER AND PLATE INTO DECK WITH DECK OBSTRUCTION

ACCEPTABLE SYSTEMS: EZ TPO PEEL & STICK™

ACCEPTABLE SYSTEMS: EZ TPO PEEL & STICK™ SELF ADHERED

MAXIMUM WARRANTY: 20 Years

ISSUE / REVISION DATE:
05/01/2023

DETAIL NO.
EZT-PS-BT-09