

**USE APPROPRIATE  
TERMINATION**

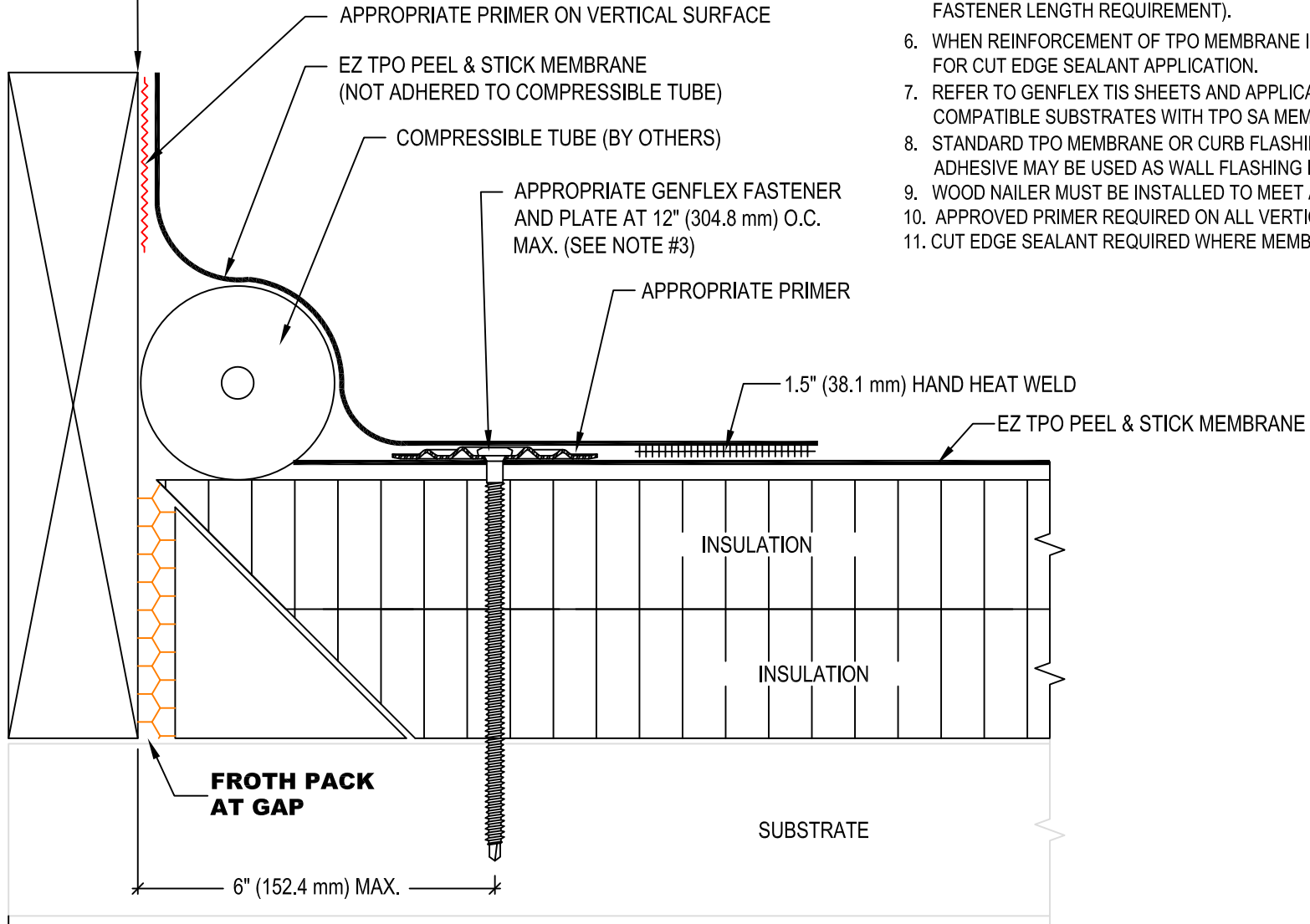

**NOTE:**

1. REFER TO THE GENFLEX™ WEBSITE FOR MOST CURRENT INFORMATION.
2. REFER TO DETAIL EZT-PS-LS-01 OR EZT-PS-LS-02 FOR WELD WIDTH.
3. MAXIMUM 10" (254 mm) LONG FASTENERS.  
(NOTE: WOOD BLOCKING MAY BE SUBSTITUTED FOR INSULATION TO REDUCE FASTENER LENGTH REQUIREMENT).
6. WHEN REINFORCEMENT OF TPO MEMBRANE IS EXPOSED, REFER TO EZT-PS-LS-04 FOR CUT EDGE SEALANT APPLICATION.
7. REFER TO GENFLEX TIS SHEETS AND APPLICATION GUIDES FOR LIST OF COMPATIBLE SUBSTRATES WITH TPO SA MEMBRANE.
8. STANDARD TPO MEMBRANE OR CURB FLASHING WITH APPROPRIATE MEMBRANE ADHESIVE MAY BE USED AS WALL FLASHING IN LIEU OF EZ TPO PEEL & STICK.
9. WOOD NAILER MUST BE INSTALLED TO MEET APPLICABLE BUILDING CODES.
10. APPROVED PRIMER REQUIRED ON ALL VERTICAL SURFACES
11. CUT EDGE SEALANT REQUIRED WHERE MEMBRANE REINFORCEMENT IS EXPOSED.



**BASE TIE-IN AT PARAPET / CURB WITH EXISTING  
GYPSUM CANT FASTENED INTO DECK**

ACCEPTABLE SYSTEMS: EZ TPO PEEL & STICK™

ACCEPTABLE SYSTEMS: EZ TPO PEEL & STICK™ SELF ADHERED

MAXIMUM WARRANTY: 20 Years

ISSUE / REVISION  
DATE:

05/01/2023

DETAIL NO.

**EZT-PS-BT-11**

(800) 443-4272 www.genflex.com

NOT TO SCALE