

NOTE:

1. REFER TO THE GENFLEX™ WEBSITE FOR THE MOST CURRENT INFORMATION.
2. REFER TO DETAIL EZT-PS-LS-01 OR EZT-PS-LS-02 FOR WELD WIDTH.
3. EXPANSION JOINT COVER INSTALLED AND SECURED PER MANUFACTURER'S RECOMMENDATIONS.
4. WOOD NAILER MUST BE INSTALLED TO MEET APPLICABLE BUILDING CODES.
5. WHEN REINFORCEMENT OF TPO MEMBRANE IS EXPOSED, REFER TO EZT-PS-LS-04 FOR CUT EDGE SEALANT APPLICATION.
6. APPROVED PRIMER REQUIRED ON ALL VERTICAL SURFACES WHEN EZ TPO PEEL & STICK MEMBRANE IS USED FOR FLASHING.
7. REFER TO GENFLEX TIS SHEETS AND APPLICATION GUIDES FOR LIST OF COMPATIBLE SUBSTRATES WITH GENFLEX EZ TPO PEEL & STICK MEMBRANE.

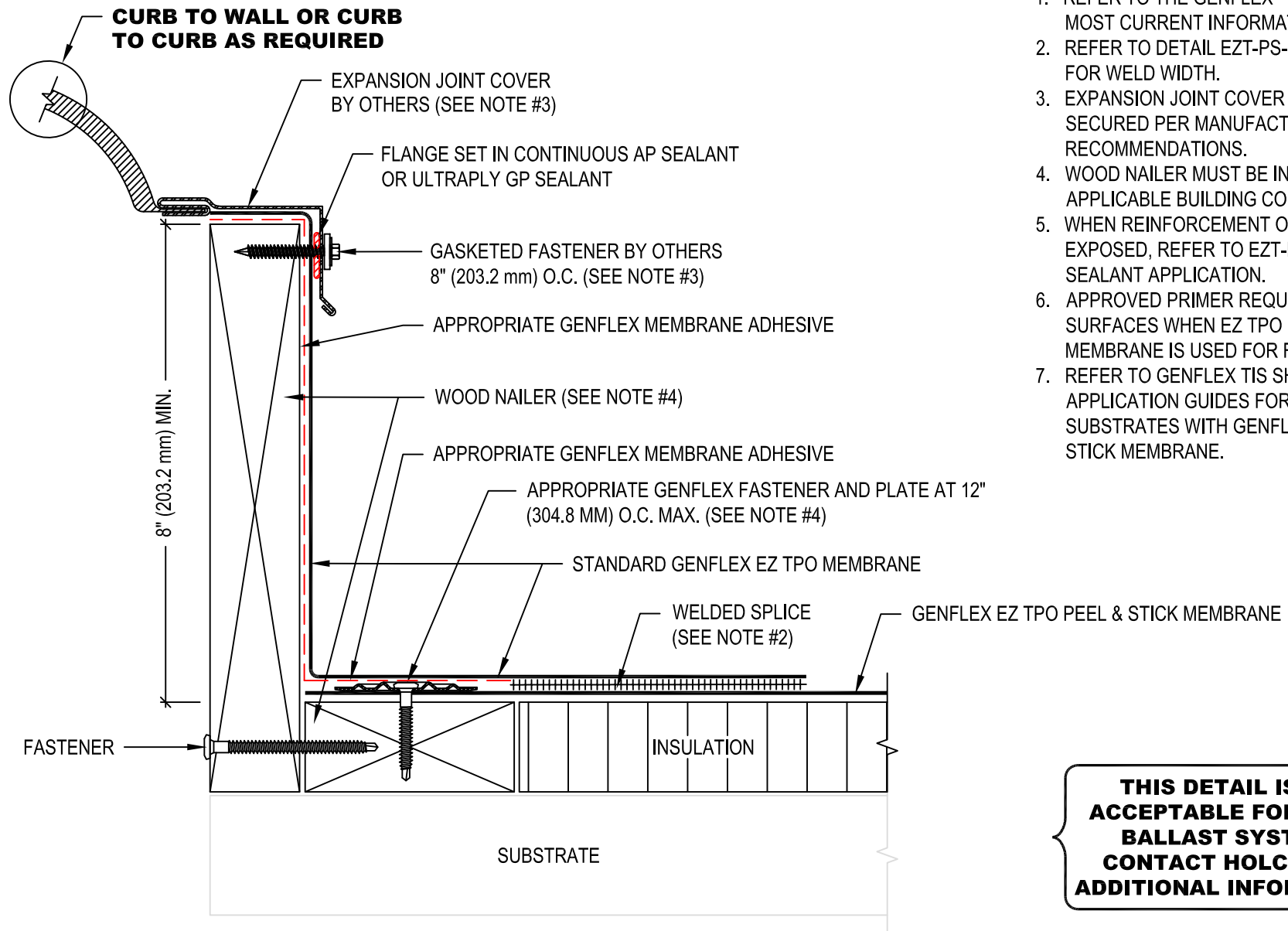

THIS DETAIL IS NOT ACCEPTABLE FOR PAVER BALLAST SYSTEMS. CONTACT HOLCIM FOR ADDITIONAL INFORMATION.



EXPANSION JOINT (MANUFACTURED COVER) WITH WELDED SPLICE

MAXIMUM WARRANTY: 20 Years

ACCEPTABLE SYSTEMS: EZ TPO PEEL & STICK™

ACCEPTABLE SYSTEMS: EZ TPO PEEL & STICK™ SELF ADHERED

ISSUE / REVISION DATE:
05/01/2023

DETAIL NO.
EZT-PS-E-04

(800) 443-4272 www.genflex.com

NOT TO SCALE