

NOTE:

1. REFER TO THE GENFLEX™ WEBSITE FOR THE MOST CURRENT INFORMATION.
2. REMOVE ALL EXISTING FLASHING, LEAD, ETC. PIPE SURFACE MUST BE FREE OF ALL RUST, GREASE, INSULATION, ETC.
3. GENFLEX POURABLE SEALER MOUNDED TO SHED WATER: MINIMUM DEPTH OF 2" (50.8 mm), REMAINDER OF POCKET MAY BE FILLED WITH A NON-SHRINKING GROUT.
4. DO NOT USE OVER EXISTING PENETRATION POCKETS.
5. WHEN OUTSIDE DIAMETER OF THE PIPE EXCEEDS 18" (457.2 MM), ADDITIONAL FIELD MEMBRANE SECUREMENT REQUIRED. REFER TO APPROPRIATE BASE TIE-IN DETAILS.
6. DO NOT USE WHEN SERVICE LINE TEMP. EXCEEDS 160 °F (71 °C).
7. APPROVED GENFLEX PRIMER REQUIRED ON PENETRATIONS AND INSIDE OF PENETRATION POCKET.
8. REFER TO THE GENFLEX TIS SHEETS AND APPLICATION GUIDES FOR LIST OF COMPATIBLE SUBSTRATES WITH GENFLEX EZ TPO PEEL & STICK MEMBRANE.

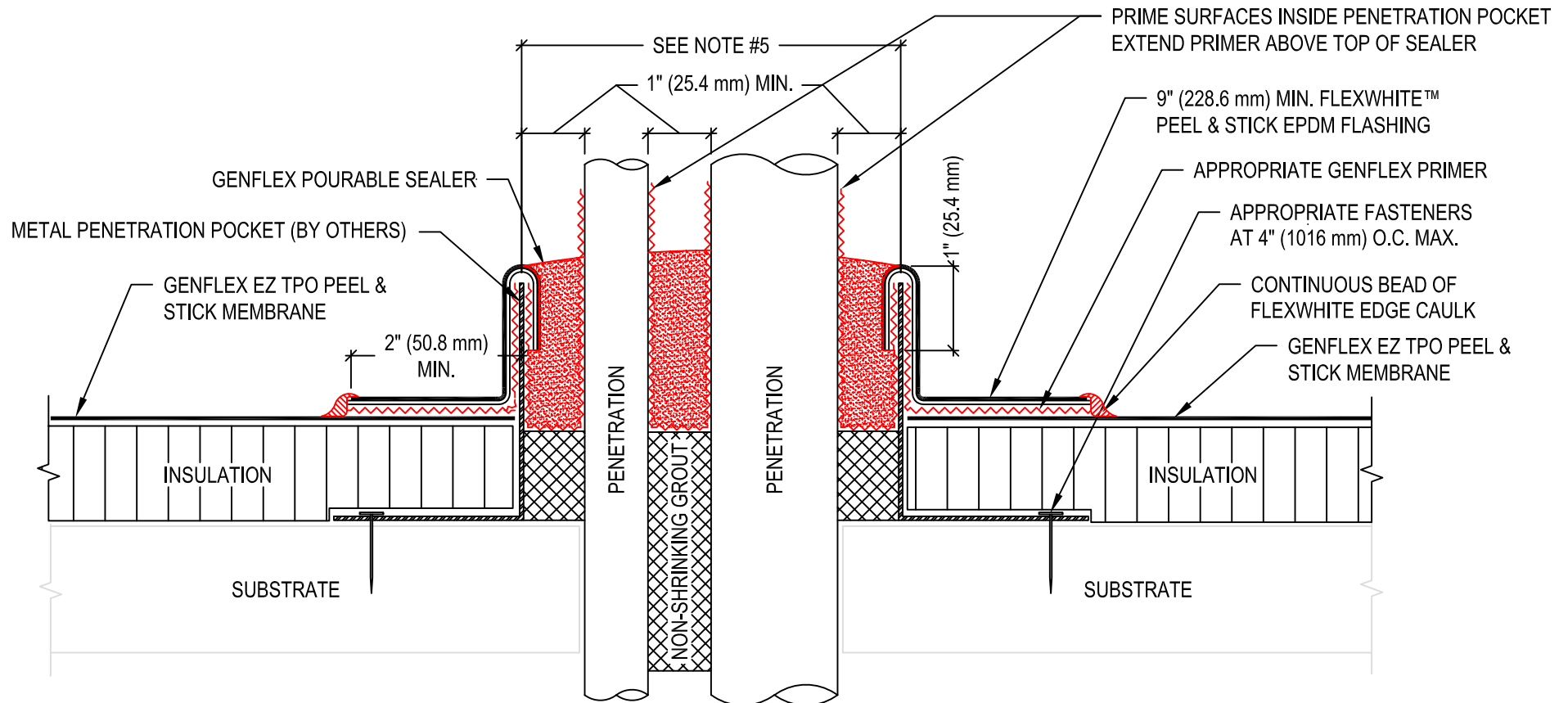

PENETRATION WITH METAL PENETRATION POCKET TO DECK

MAXIMUM WARRANTY: 20 Years

ACCEPTABLE SYSTEMS: EZ TPO PEEL & STICK™

ACCEPTABLE SYSTEMS: EZ TPO PEEL & STICK™ SELF ADHERED

ISSUE / REVISION DATE:

05/01/2023

DETAIL NO.

EZT-PS-P-06

(800) 443-4272 www.genflex.com

NOT TO SCALE