

NOTE:

1. REFER TO THE GENFLEX™ WEBSITE FOR THE MOST CURRENT INFORMATION.
2. REMOVE ALL EXISTING FLASHING, LEAD, ETC. PIPE SURFACE MUST BE FREE OF ALL RUST, GREASE, INSULATION, ETC.
3. GENFLEX POURABLE SEALER MOUNDED TO SHED WATER: MINIMUM DEPTH OF 2" (51 mm), REMAINDER OF POCKET MAY BE FILLED WITH A NON-SHRINKING GROUT.
4. DO NOT USE OVER EXISTING PENETRATION POCKETS.
5. WOOD NAILER MUST BE INSTALLED TO MEET APPLICABLE BUILDING CODES.
6. DO NOT USE WHEN SERVICE LINE TEMP. EXCEEDS 160 °F (71 °C).
7. APPROVED GENFLEX PRIMER REQUIRED ON PENETRATIONS AND INSIDE OF PENETRATION POCKET.
8. REFER TO GENFLEX TIS SHEETS AND APPLICATION GUIDES FOR LIST OF COMPATIBLE SUBSTRATES WITH EZ TPO PEEL & STICK MEMBRANE.
9. SEAMS MAY RUN PARALLEL WITH WATER FLOW.

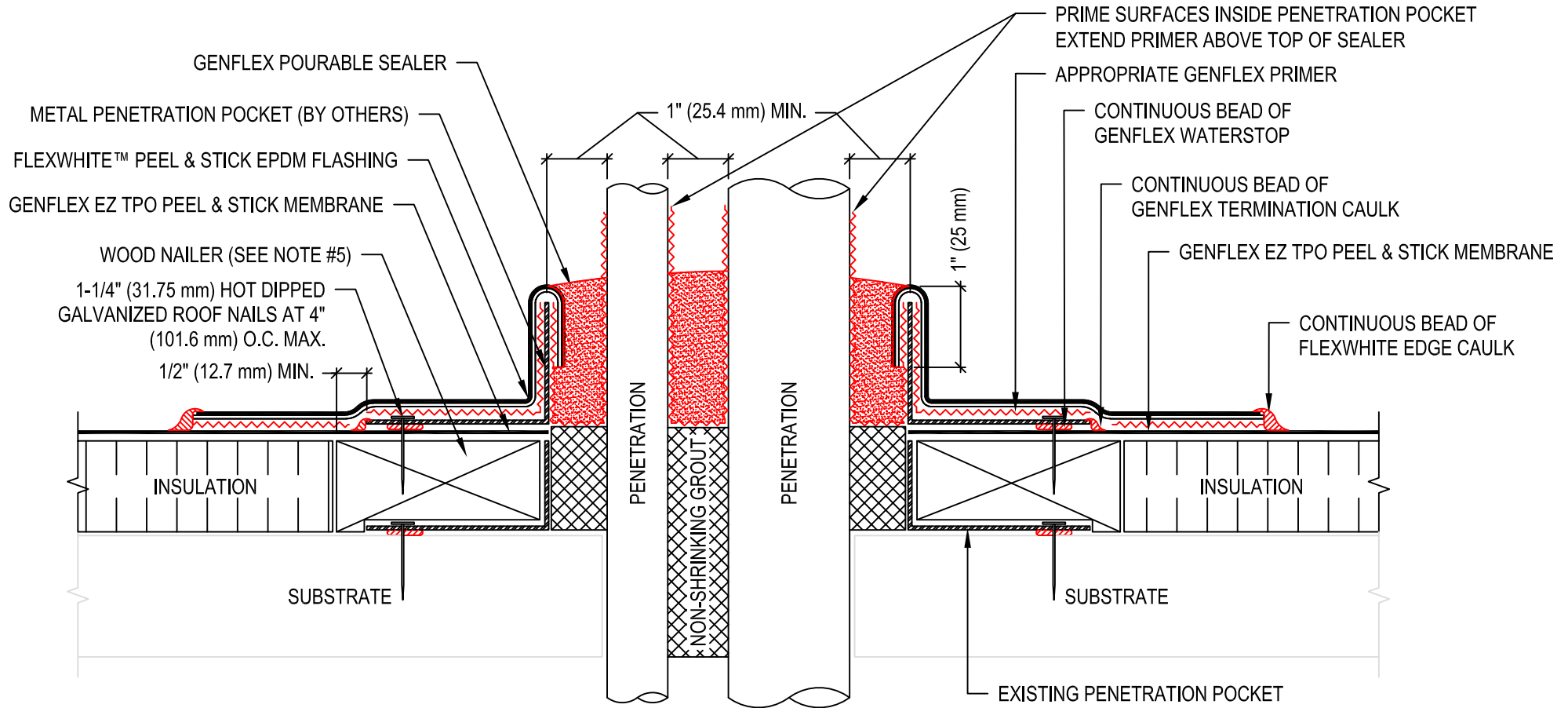

**PENETRATION WITH METAL PENETRATION POCKET
TO NAILER FOR RE-COVER OR RE-ROOF**

ACCEPTABLE SYSTEMS: EZ TPO PEEL & STICK™

ACCEPTABLE SYSTEMS: EZ TPO PEEL & STICK™ SELF ADHERED

MAXIMUM WARRANTY: 20 Years

ISSUE / REVISION
DATE:

05/01/2023

DETAIL NO.

EZT-PS-P-07

(800) 443-4272 www.genflex.com

NOT TO SCALE