

NOTE:

1. REFER TO THE GENFLEX™ WEBSITE FOR MOST CURRENT INFORMATION.
2. NON-GENFLEX METAL COPING IS ACCEPTABLE FOR USE IN THIS DETAIL PROVIDED FABRICATION AND INSTALLATION IS IN ACCORDANCE WITH CURRENT SMACNA RECOMMENDATIONS. HOWEVER, WATERTIGHT INTEGRITY OF WALL AND METAL COPING SHALL BE ENSURED BY OTHERS AND BE EXCLUDED FROM WARRANTY COVERAGE IN THE THE EVENT NON-GENFLEX COPING IS UTILIZED.
3. WOOD NAILER MUST BE INSTALLED TO MEET APPLICABLE BUILDING CODES.
4. FASTEN COPING CLEAT AS PER SUPPLIED INSTRUCTIONS.
5. GENFLEX EZ TPO PEEL & STICK CAN BE USED AS VERTICAL WALL FLASHING.
6. APPROVED PRIMER REQUIRED ON ALL VERTICAL SURFACES WHEN EZ TPO PEEL & STICK MEMBRANE IS USED FOR FLASHING.
7. REFER TO TPO APPLICATION GUIDE FOR ACCEPTABLE FLASHING SUBSTRATES.
8. IF INTERMEDIATE ATTACHMENT IS REQUIRED, COMPLETE AS FOLLOWS:
 - UP TO 5' (1.52 m) WALL HEIGHT- NONE REQUIRED
 - 5' (1.52 m) - 10' (3.05 m) WALL HEIGHT - ONE ATTACHMENT AT 1/2 THE WALL HEIGHT
 - ABOVE 10' (3.05 m) - ONE ATTACHMENT EVERY 3' (0.91 m)

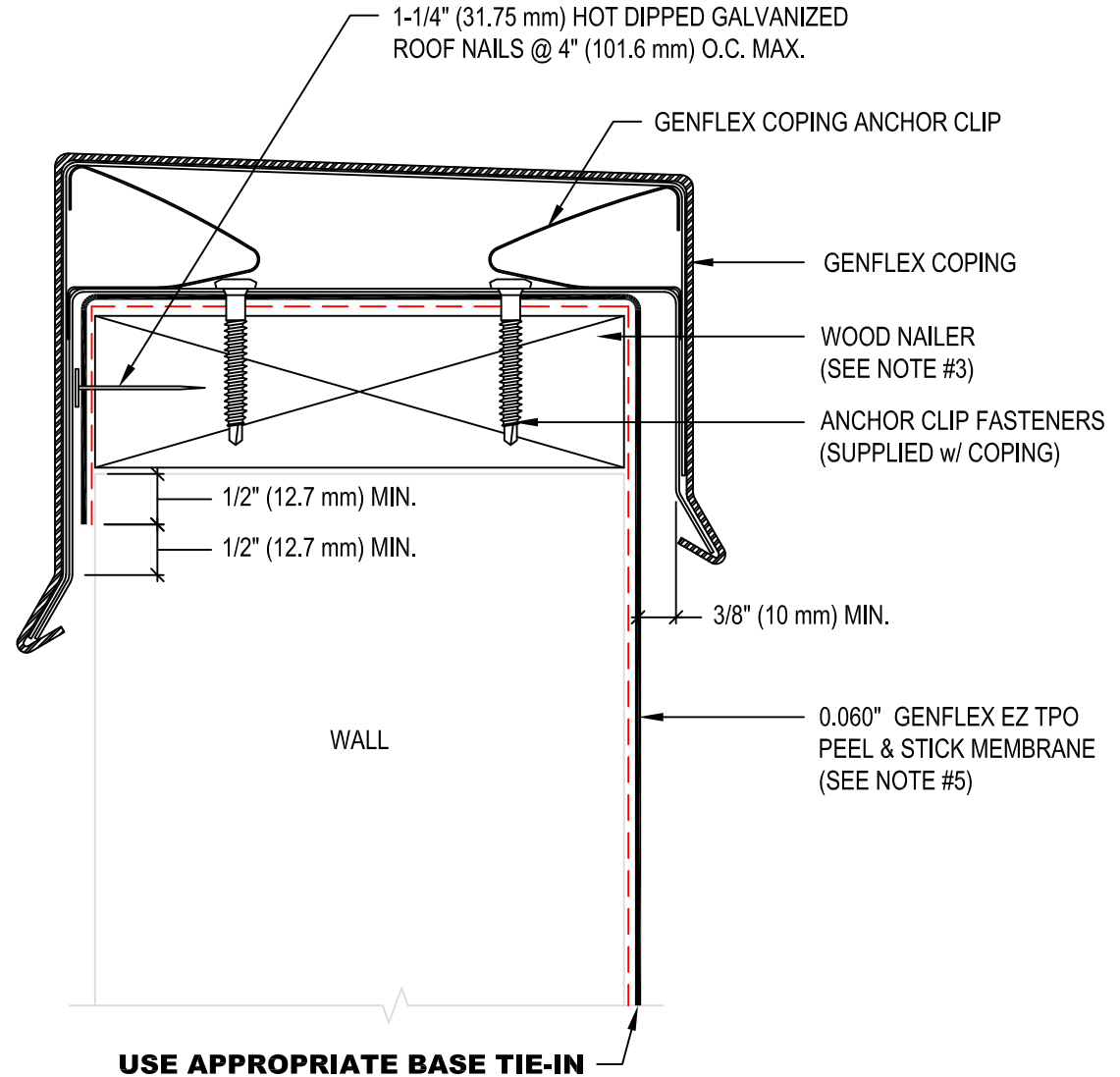

**TERMINATION AT TOP OF WALL WITH
GENFLEX COPING**

ACCEPTABLE SYSTEMS: EZ TPO PEEL & STICK™

ACCEPTABLE SYSTEMS: EZ TPO PEEL & STICK™ SELF ADHERED

MAXIMUM WARRANTY: 20 Years

ISSUE / REVISION
DATE:

05/01/2023

DETAIL NO.

EZT-PS-T-03

(800) 443-4272 www.genflex.com

NOT TO SCALE