

USE APPROPRIATE TERMINATION

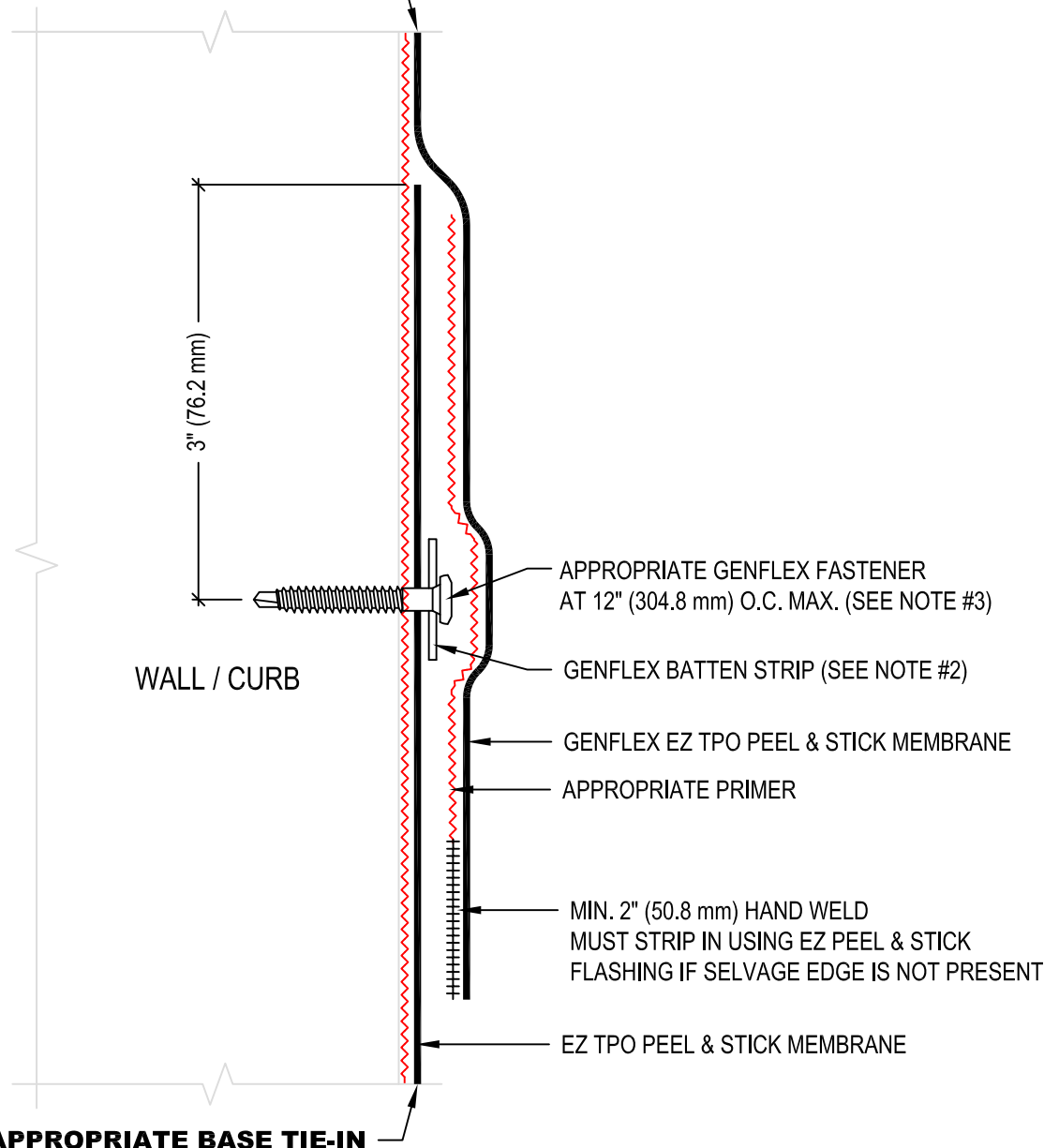

NOTE:

1. REFER TO THE GENFLEX™ WEBSITE FOR MOST CURRENT INFORMATION.
2. METAL BATTEN STRIP ACCEPTABLE FOR WOOD OR METAL SUBSTRATE. METAL BATTEN MUST BE USED WITH MASONRY SUBSTRATE.
3. IF INTERMEDIATE ATTACHMENT IS REQUIRED, COMPLETE AS FOLLOWS:
 - UP TO 5' (1.52 m) WALL HEIGHT- NONE REQUIRED
 - 5' (1.52 m) - 10' (3.05 m) WALL HEIGHT - ONE ATTACHMENT AT 1/2 THE WALL HEIGHT
 - ABOVE 10' (3.05 m) - ONE ATTACHMENT EVERY 3' (1 m)
4. THERE ARE SOME CONDITIONS WHICH DO NOT REQUIRE INTERMEDIATE ATTACHMENT. REFER TO GENFLEX APPLICATION SPECIFICATIONS FOR ADDITIONAL INFORMATION.
5. WHEN REINFORCEMENT OF TPO MEMBRANE IS EXPOSED, REFER TO EZT-PS-LS-07 FOR CUT EDGE SEALANT APPLICATION.
6. REFER TO TPO APPLICATION GUIDE FOR ACCEPTABLE FLASHING SUBSTRATES.
7. APPROVED PRIMER REQUIRED ON ALL VERTICAL SURFACES.

USE APPROPRIATE BASE TIE-IN



INTERMEDIATE WALL FLASHING ATTACHMENT WITH GENFLEX EZ TPO PEEL & STICK MEMBRANE AND BATTEN STRIP

ACCEPTABLE SYSTEMS: EZ TPO PEEL & STICK™

ACCEPTABLE SYSTEMS: EZ TPO PEEL & STICK™ SELF ADHERED

MAXIMUM WARRANTY: 20 Years

ISSUE / REVISION DATE:

05/01/2023

DETAIL NO.

EZT-PS-T-15

NOT TO SCALE