

**USE APPROPRIATE TERMINATION**

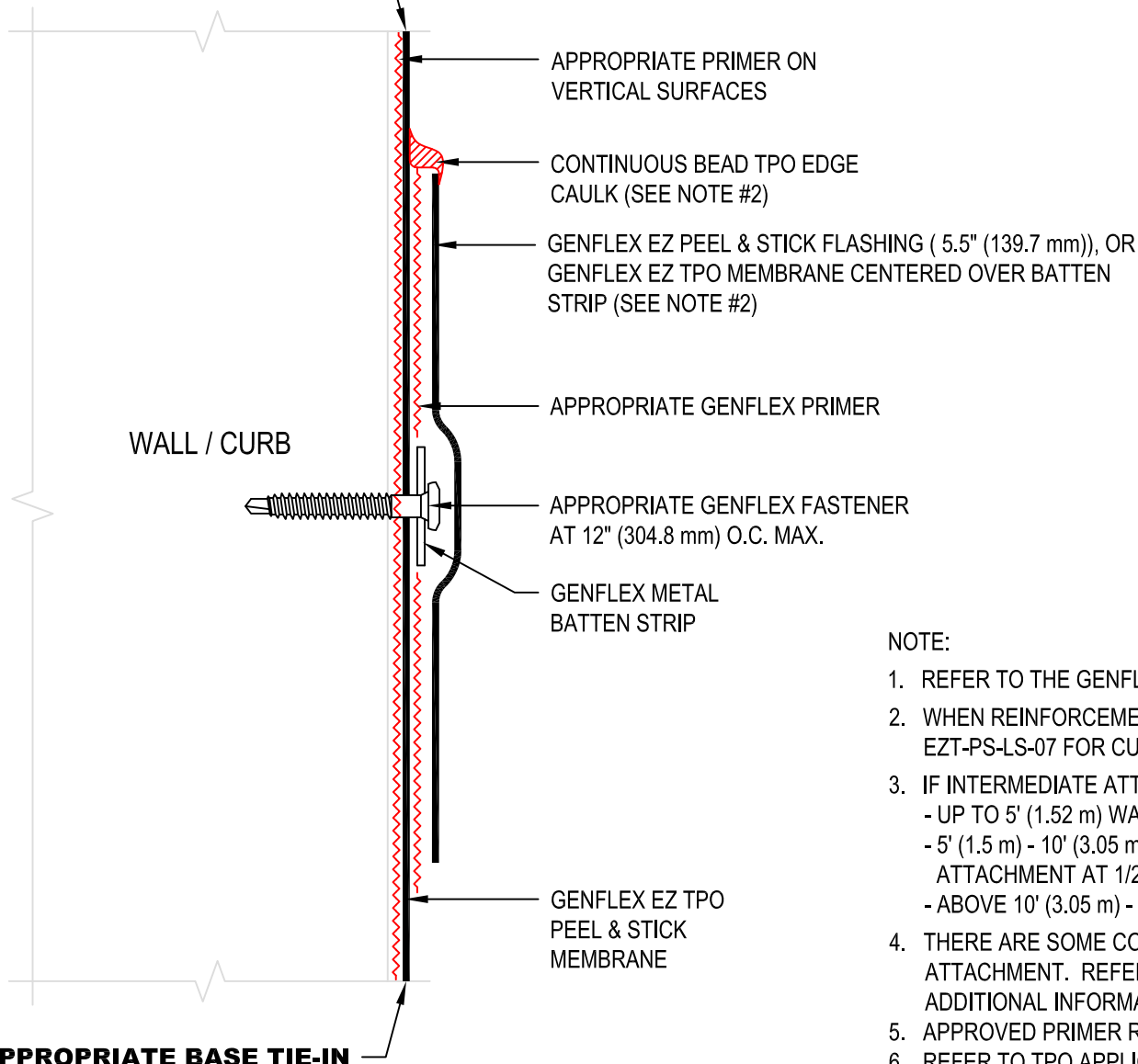

**NOTE:**

1. REFER TO THE GENFLEX™ WEBSITE FOR MOST CURRENT INFORMATION.
2. WHEN REINFORCEMENT OF TPO MEMBRANE IS EXPOSED, REFER TO EZT-PS-LS-07 FOR CUT EDGE SEALANT APPLICATION.
3. IF INTERMEDIATE ATTACHMENT IS REQUIRED, COMPLETE AS FOLLOWS:
  - UP TO 5' (1.52 m) WALL HEIGHT- NONE REQUIRED
  - 5' (1.5 m) - 10' (3.05 m) WALL HEIGHT - ONE ATTACHMENT AT 1/2 THE WALL HEIGHT
  - ABOVE 10' (3.05 m) - ONE ATTACHMENT EVERY 3' (1 m)
4. THERE ARE SOME CONDITIONS WHICH DO NOT REQUIRE INTERMEDIATE ATTACHMENT. REFER TO ELEVATE APPLICATION SPECIFICATIONS FOR ADDITIONAL INFORMATION.
5. APPROVED PRIMER REQUIRED ON ALL VERTICAL SURFACES.
6. REFER TO TPO APPLICATION GUIDE FOR ACCEPTABLE FLASHING SUBSTRATES.



**INTERMEDIATE WALL FLASHING ATTACHMENT WITH GENFLEX EZ PEEL & STICK FLASHING**

ACCEPTABLE SYSTEMS: EZ TPO PEEL & STICK™

ACCEPTABLE SYSTEMS: EZ TPO PEEL & STICK™ SELF ADHERED

MAXIMUM WARRANTY: 20 Years

ISSUE / REVISION DATE:

05/01/2023

DETAIL NO.

EZT-PS-T-16

NOT TO SCALE

(800) 443-4272 www.genflex.com