

NOTE:

1. REFER TO GENFLEX™ WEBSITE FOR MOST CURRENT INFORMATION.
2. WOOD NAILER MUST BE INSTALLED TO MEET APPLICABLE BUILDING CODES.
3. GENFLEX MEMBRANE ADHESIVE REQUIRED BETWEEN MEMBRANE AND INSULATION FOR ADHERED SYSTEMS.
4. HEAVYWEIGHT ROOF PAVER - MIN 10 LB (4.5 kg) PER SQ. FT. INSTALLED OVER PROTECTION LAYER REQUIRED FOR BALLASTED SYSTEMS.
5. WHEN CHANGE IN ELEVATION OCCURS BETWEEN SYSTEMS, USE APPROPRIATE TAPERED INSULATION TO CREATE A SMOOTH TRANSITION.

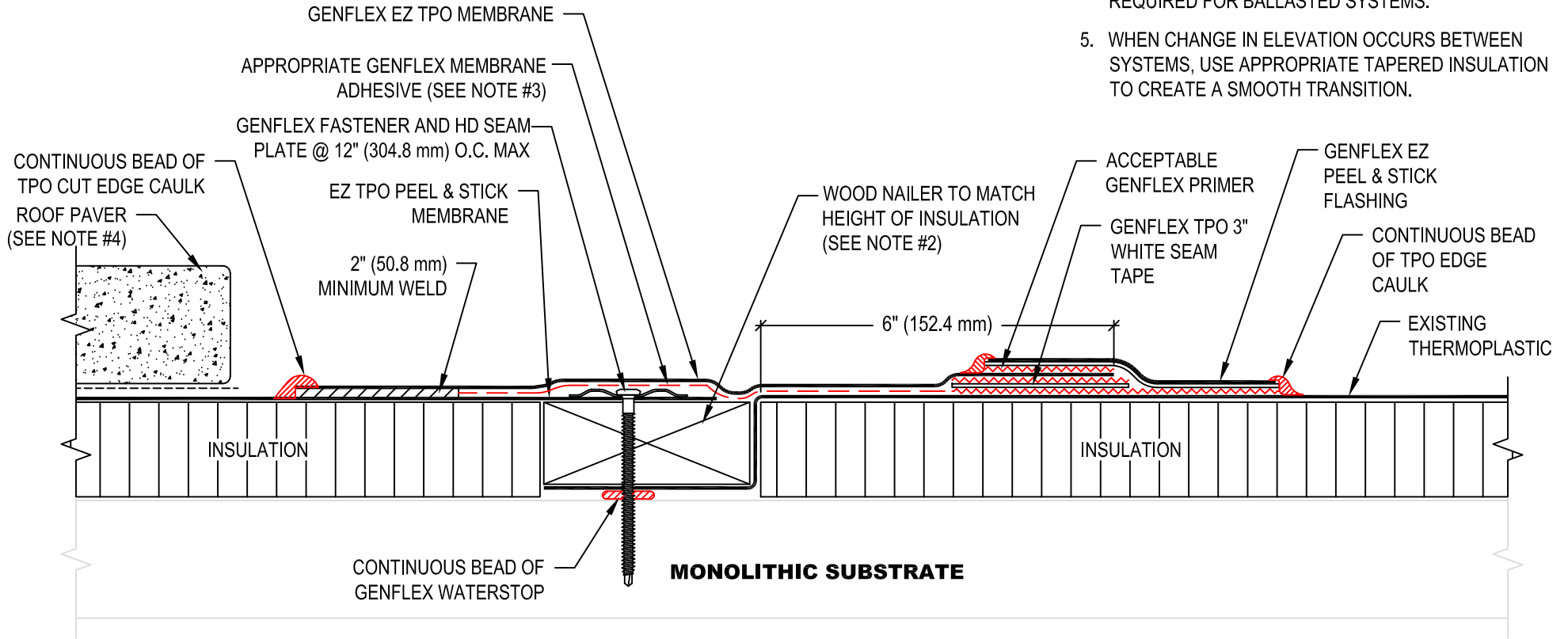

TIE-IN TO EXISTING ROOF SYSTEMS NOT WARRANTED BY GENFLEX



TIE-IN GENFLEX EZ TPO PEEL & STICK SYSTEM TO EXISTING THERMOPLASTIC SYSTEM (MONOLITHIC SUBSTRATE)

ACCEPTABLE SYSTEMS: EZ TPO PEEL & STICK™

ACCEPTABLE SYSTEMS: EZ TPO PEEL & STICK™ SELF ADHERED

MAXIMUM WARRANTY: 20 Years

ISSUE / REVISION DATE:
05/01/2023

DETAIL NO.
EZT-PS-T-17