

**SEAM EDGE TREATMENT AT LAP SPICE**

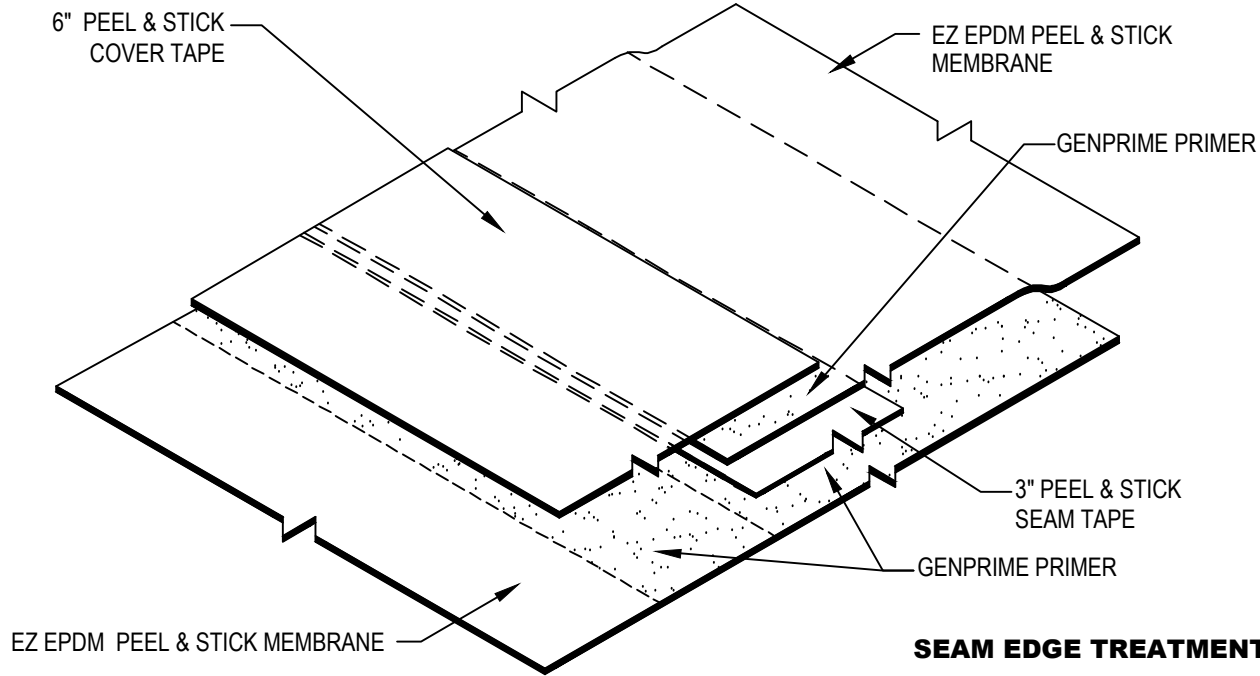

**NOTE:**

1. REFER TO GENFLEX™ WEBSITE FOR THE MOST CURRENT INFORMATION.
2. ALLOW PRIMER TO FLASH OFF BEFORE APPLYING EDGE CAULK.
3. USE GENPRIME TO CLEAN AND PRIME EPDM MATING SURFACE PRIOR TO INSTALLATION OF PEEL & STICK PRODUCTS.
4. EXTRA CLEANING IS REQUIRED AT FACTORY SPLICE AREAS AND OTHER AREAS WHERE EXCESS DUSTING AGENTS MAY HAVE ACCUMULATED.

**SEAM EDGE TREATMENT FOR QUICKSEAM PRODUCTS**

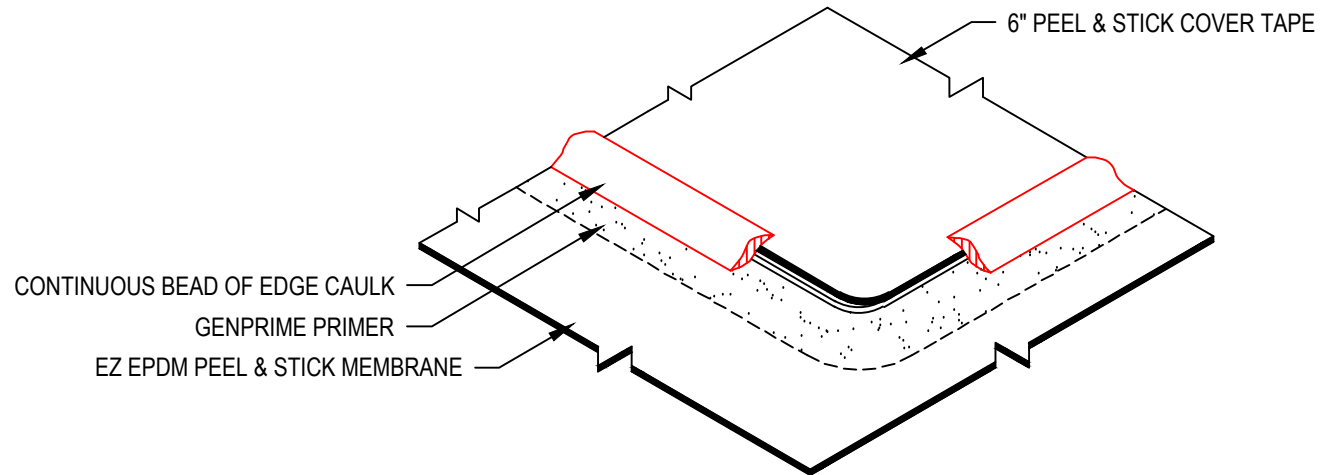

**LAP SPLICE WITH 3" SEAM TAPE  
AND 6" COVER TAPE**

ACCEPTABLE SYSTEMS: EZ EPDM PEEL & STICK™ SELF ADHERED

(800) 443-4272 www.genflex.com

MAXIMUM WARRANTY: 20 Years

ISSUE / REVISION  
DATE:

07/28/2023

NOT TO SCALE

DETAIL NO.

EZE-PS-LS-03