

PLAN VIEW

PIPE FLASHING OVER FIELD OR FACTORY SEAM

NOTE:

1. REFER TO GENFLEX™ WEBSITE FOR THE MOST CURRENT INFORMATION. REMOVE ALL EXISTING FLASHING, LEAD, ETC.
2. REMOVE ALL EXISTING FLASHING, LEAD, ETC. PIPE SURFACE MUST BE FREE OF ALL RUST, GREASE, INSULATION, ETC.
3. PIPE SURFACE MUST BE FREE OF ALL RUST, GREASE, INSULATION, ETC. GENFLEX POURABLE SEALER MOUNDED TO SHED WATER. (MINIMUM DEPTH OF 2" (51 mm), REMAINDER OF POCKET MAY BE FILLED WITH NON-SHRINKING GROUT.
4. DO NOT USE OVER EXISTING PENETRATION POCKETS.
5. DO NOT USE WHEN SERVICE LINE TEMP. EXCEEDS 180 °F (82 °C). REFER TO EZE-PS-P-04.
6. IF FIELD MEMBRANE IS CUT FOR INSTALLATION, THE MEMBRANE MUST BE REPAIRED WITH EPDM MEMBRANE PRIOR TO INSTALLATION OF THE PENETRATION POCKET.
7. MEMBRANE MUST BE INSTALLED WITHIN 1/2" (13 mm) OF PENETRATION
8. GENPRIME PRIMER REQUIRED ON PENETRATIONS AND MEMBRANE INSIDE OF GENPOCKET E.

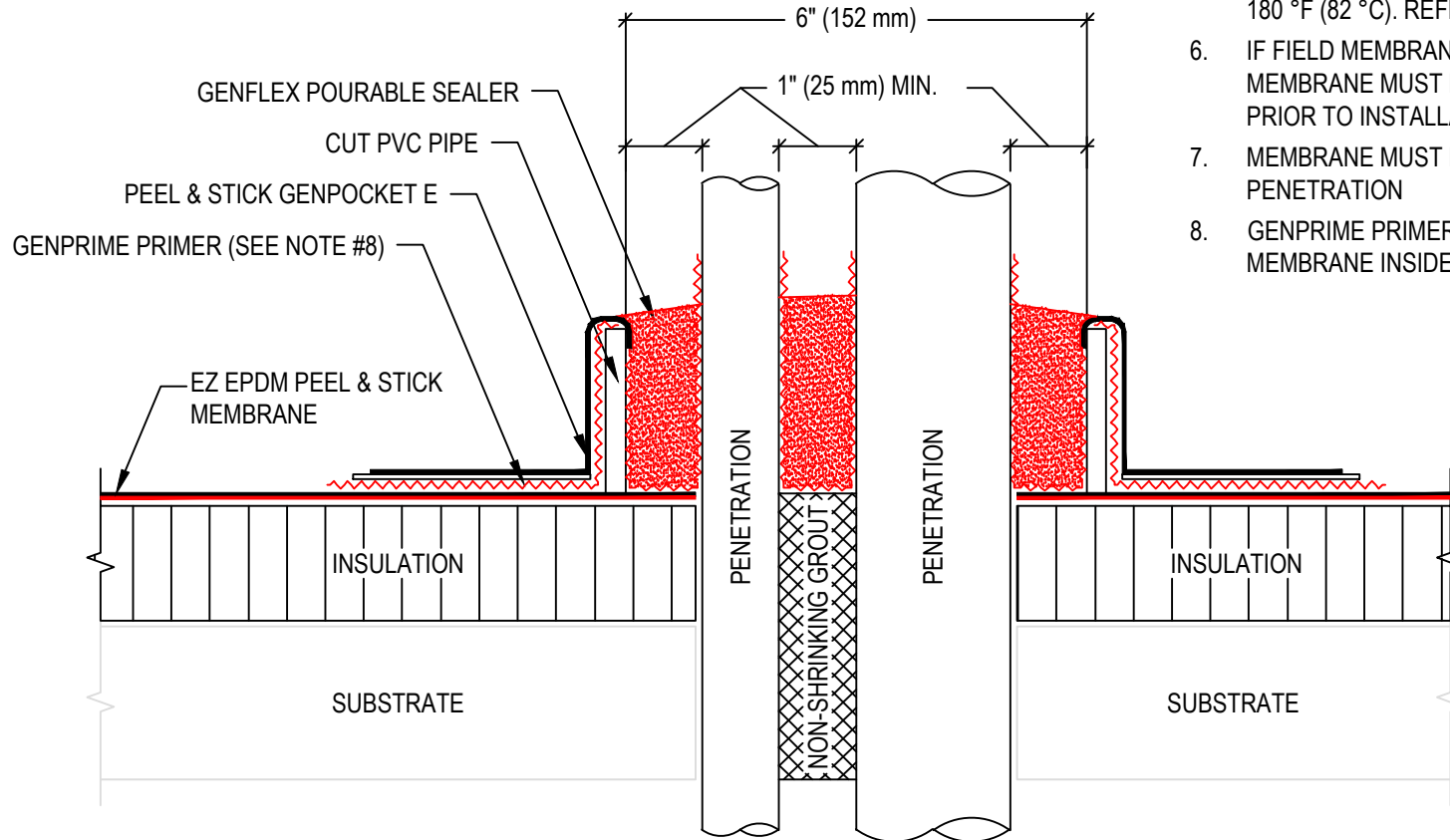

PENETRATION WITH PEEL & STICK GENPOCKET E

ACCEPTABLE SYSTEMS: EZ EPDM PEEL & STICK™ SELF ADHERED

(800) 443-4272 www.genflex.com

MAXIMUM WARRANTY: 20 Years

ISSUE / REVISION DATE:

07/28/2023

NOT TO SCALE

DETAIL NO.

EZE-PS-P-05