

NOTE:

1. REFER TO GENFLEX™ WEBSITE FOR THE MOST CURRENT INFORMATION.
2. REMOVE ALL EXISTING FLASHING, LEAD, ETC. PIPE SURFACE MUST BE FREE OF ALL RUST, GREASE, INSULATION, ETC.
3. GENFLEX POURABLE SEALER MOUNDED TO SHED WATER. (MINIMUM DEPTH OF 2" (51 mm), REMAINDER OF POCKET MAY BE FILLED WITH NON-SHRINKING GROUT.
4. DO NOT USE OVER EXISTING PENETRATIONS POCKETS.
5. WHEN OUTSIDE DIAMETER OF PIPE EXCEEDS 18" (457 mm), ADDITIONAL FIELD MEMBRANE SECUREMENT IS REQUIRED. REFER TO APPROPRIATE BASE TIE-IN DETAILS.
6. DO NOT USE WHEN SERVICE LINE TEMP. EXCEEDS 180 °F (82 °C). REFER TO EZE-PS-P-04.
7. APPLY EDGE CAULK AROUND ENTIRE PERIMETER OF FLASHING. REFER TO EZE-PS-LS-09 FOR SEAM EDGE TREATMENT.
8. GENPRIME PRIMER REQUIRED ON PENETRATIONS AND MEMBRANE INSIDE OF PENETRATION POCKET.

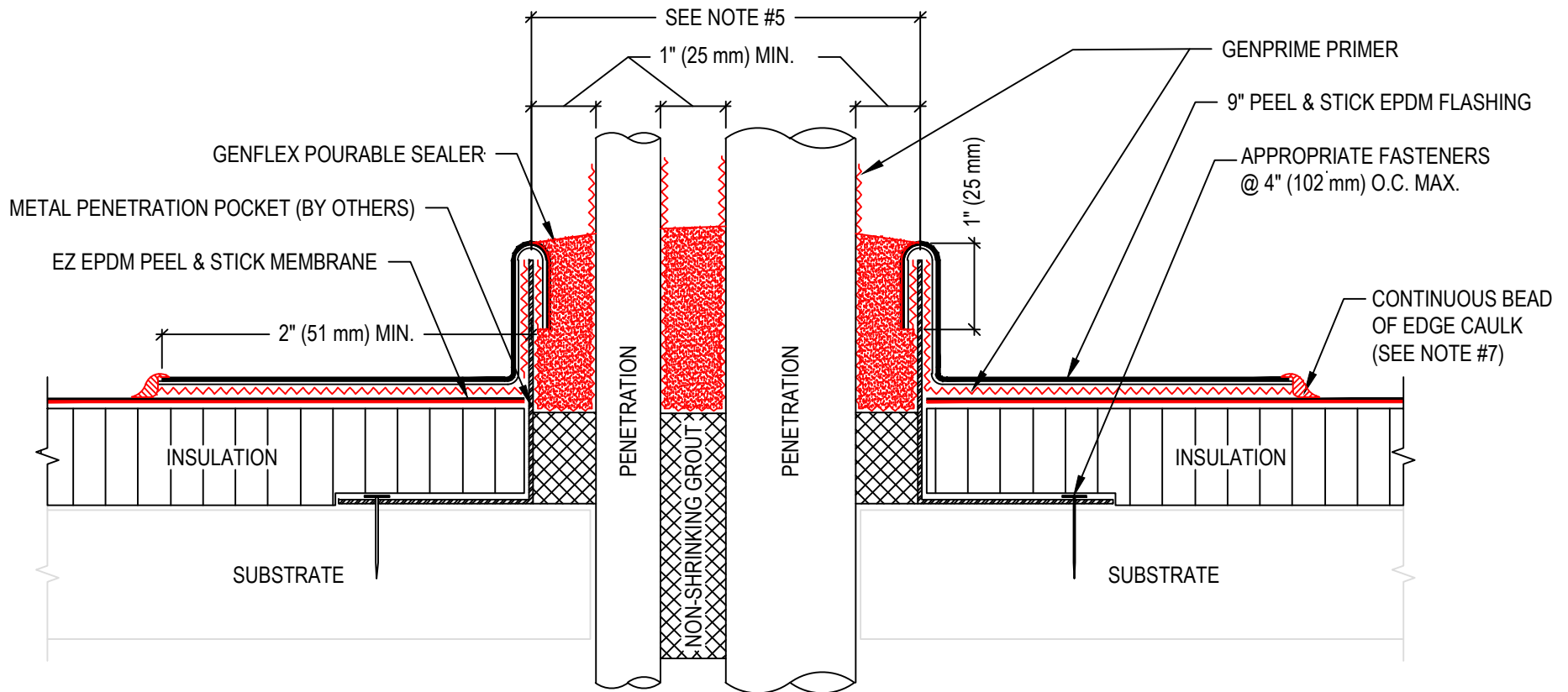

PENETRATION WITH METAL PENETRATION POCKET TO DECK

ACCEPTABLE SYSTEMS: EZ EPDM PEEL & STICK™ SELF ADHERED

(800) 443-4272 www.genflex.com

MAXIMUM WARRANTY: 20 Years

ISSUE / REVISION DATE:

07/28/2023

NOT TO SCALE

DETAIL NO.

EZE-PS-P-08