

NOTE:

1. REFER TO GENFLEX™ WEBSITE FOR THE MOST CURRENT INFORMATION.
2. APPLY EDGE CAULK ALONG ENTIRE PERIMETER OF PEEL & STICK COVER TAPE AND T-JOINT. REFER TO EZE-PS-LS-04 FOR SEAM EDGE TREATMENT.
3. APPLY EDGE CAULK BETWEEN SHEET METAL JOINTS.
4. WOOD NAILER MUST BE INSTALLED TO MEET APPLICABLE BUILDING CODES.
5. FLANGE OF METAL MUST BE FULLY SUPPORTED BY WOOD AND TERMINATED AT LEAST 1/2" (13 mm) FROM EDGE OF WOOD.
6. USE GENPRIME PRIMER TO CLEAN AND PRIME EPDM MATING SURFACES PRIOR TO INSTALLATION OF PEEL & STICK PRODUCTS.
7. 6" PEEL & STICK COVER TAPE MUST EXTEND TO WITHIN 1/4" (6 mm) OF THE METAL EDGE.

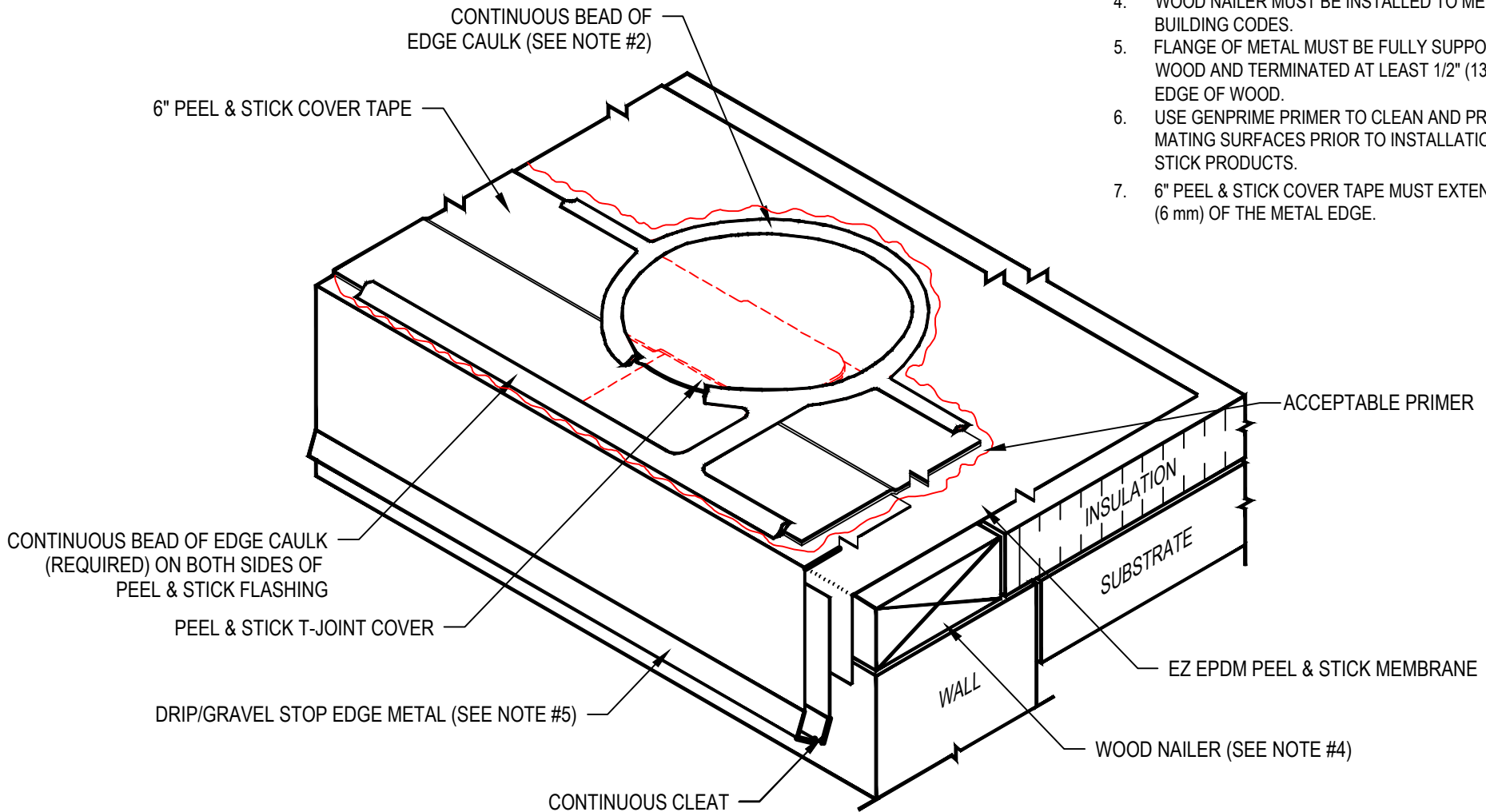

**ROOF EDGE WITH PEEL & STICK COVER TAPE
END SPLICE OVERLAP**

ACCEPTABLE SYSTEMS: EZ EPDM PEEL & STICK™ SELF ADHERED

(800) 443-4272 www.genflex.com

MAXIMUM WARRANTY: 20 Years

ISSUE / REVISION
DATE:

07/28/2023

NOT TO SCALE

DETAIL NO.

EZE-PS-RE-06