

USE APPROPRIATE TERMINATION

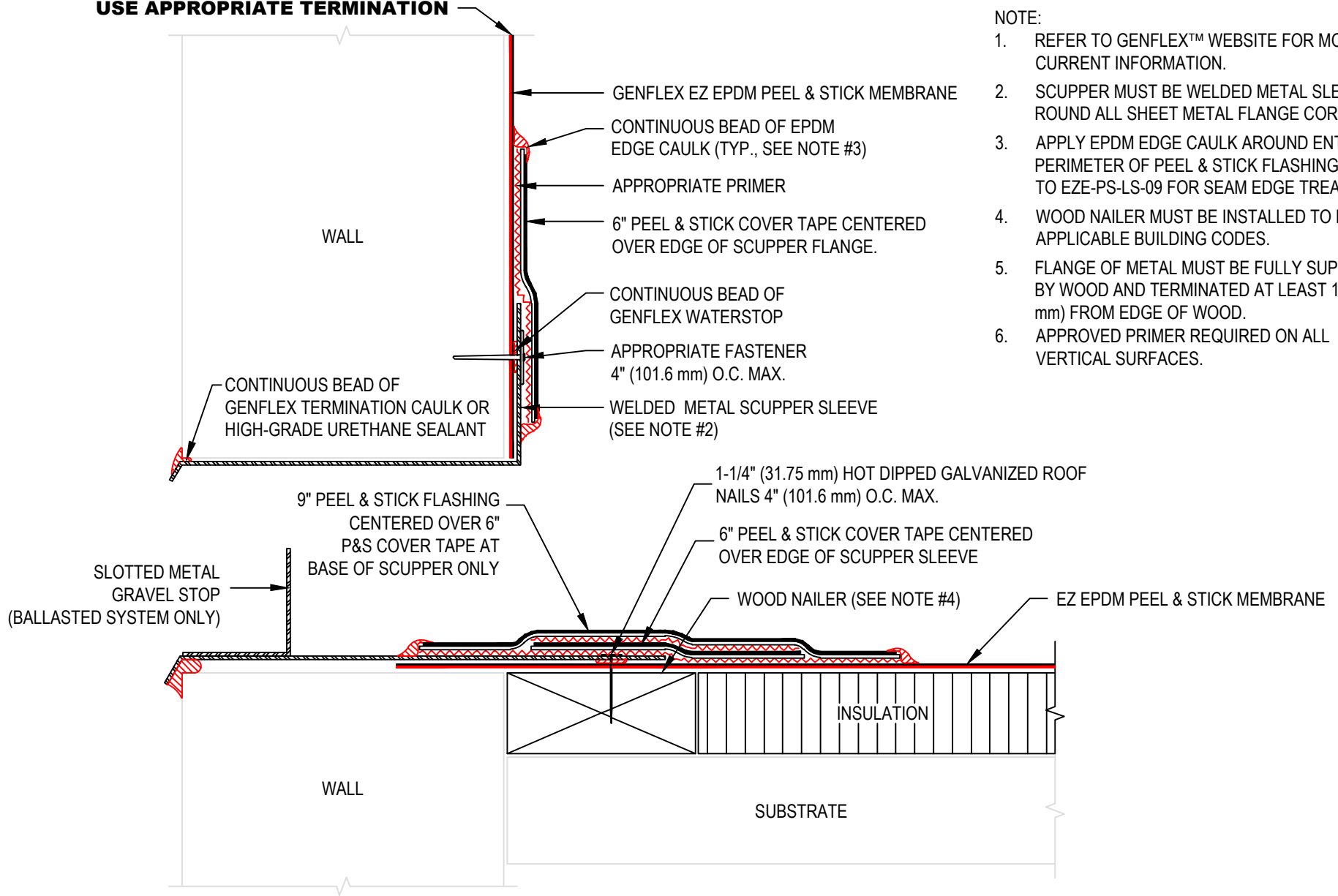

- NOTE:**
1. REFER TO GENFLEX™ WEBSITE FOR MOST CURRENT INFORMATION.
 2. SCUPPER MUST BE WELDED METAL SLEEVE, ROUND ALL SHEET METAL FLANGE CORNERS.
 3. APPLY EPDM EDGE CAULK AROUND ENTIRE PERIMETER OF PEEL & STICK FLASHING. REFER TO EZE-PS-LS-09 FOR SEAM EDGE TREATMENT.
 4. WOOD NAILER MUST BE INSTALLED TO MEET APPLICABLE BUILDING CODES.
 5. FLANGE OF METAL MUST BE FULLY SUPPORTED BY WOOD AND TERMINATED AT LEAST 1/2" (12.7 mm) FROM EDGE OF WOOD.
 6. APPROVED PRIMER REQUIRED ON ALL VERTICAL SURFACES.



THRU-WALL SCUPPER (WELDED SLEEVE)

ACCEPTABLE SYSTEMS: EZ EPDM PEEL & STICK™ SELF ADHERED

(800) 443-4272 www.genflex.com

MAXIMUM WARRANTY: 20 Years

ISSUE / REVISION DATE:
07/28/2023

NOT TO SCALE

DETAIL NO.
EZE-PS-S-01