

NOTE:

1. REFER TO GENFLEX™ WEBSITE FOR MOST CURRENT INFORMATION.
2. NON-GENFLEX METAL COPING IS ACCEPTABLE FOR THE USE IN THIS DETAIL PROVIDED FABRICATION AND INSTALLATION IS IN ACCORDANCE WITH CURRENT SMACNA RECOMMENDATIONS.
3. HOWEVER, WATERTIGHT INTEGRITY OF WALL AND METAL COPING SHALL BE ENSURED BY OTHERS AND BE EXCLUDED FROM WARRANTY COVERAGE IN THE EVENT NON-GENFLEX COPING IS UTILIZED.
4. WOOD NAILER MUST BE INSTALLED TO MEET APPLICABLE BUILDING CODES.
6. WALL SUBSTRATE MAY NEED TO BE PRIMED IF CONTAMINATED.
7. APPROVED PRIMERS INCLUDE GENPRIME AND ALL PURPOSE LVOC PRIMER.
9. APPROVED PRIMER REQUIRED ON ALL VERTICAL SURFACES.

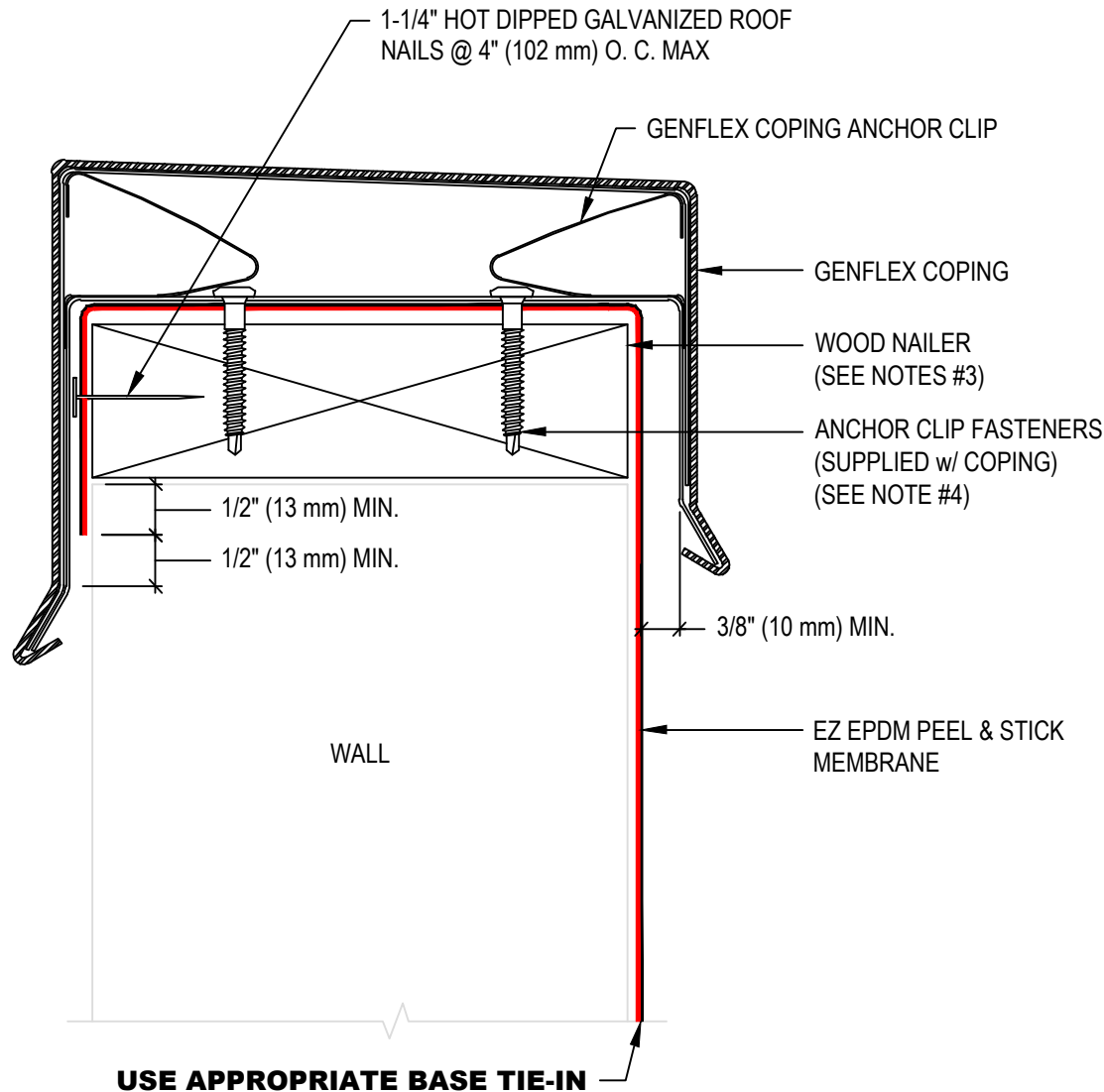

**TERMINATION AT TOP OF WALL WITH
GENFLEX COPING**

ACCEPTABLE SYSTEMS: EZ EPDM PEEL & STICK™ SELF ADHERED

MAXIMUM WARRANTY: 20 Years

ISSUE / REVISION
DATE:
07/28/2023

DETAIL NO.
EZE-PS-T-04

(800) 443-4272 www.genflex.com

NOT TO SCALE

