

NOTE:

1. REFER TO WWW.GENFLEX.COM FOR MOST CURRENT INFORMATION.
2. WHEN DRAIN SUMP EXCEEDS 1:12, THE USE OF A DRAIN INSERT IS RECOMMENDED.
3. THE MEMBRANE SHOULD EXTEND A MIN OF 1/2" (13 mm) BEYOND THE CLAMPING RING AND SHOULD NOT BE SMALLER THAN THE DIAMETER OF THE LEADER PIPE.
4. IF A FIELD SEAM IS BETWEEN 6" - 9" (152 mm - 229 mm) OF DRAIN COMPRESSION RING, A SMOOTH SBS MODIFIED BITUMEN TARGET PATCH IS REQUIRED.
5. NO SEAM CAN BE LESS THAN 6" (152 mm) FROM THE CLAMPING RING.

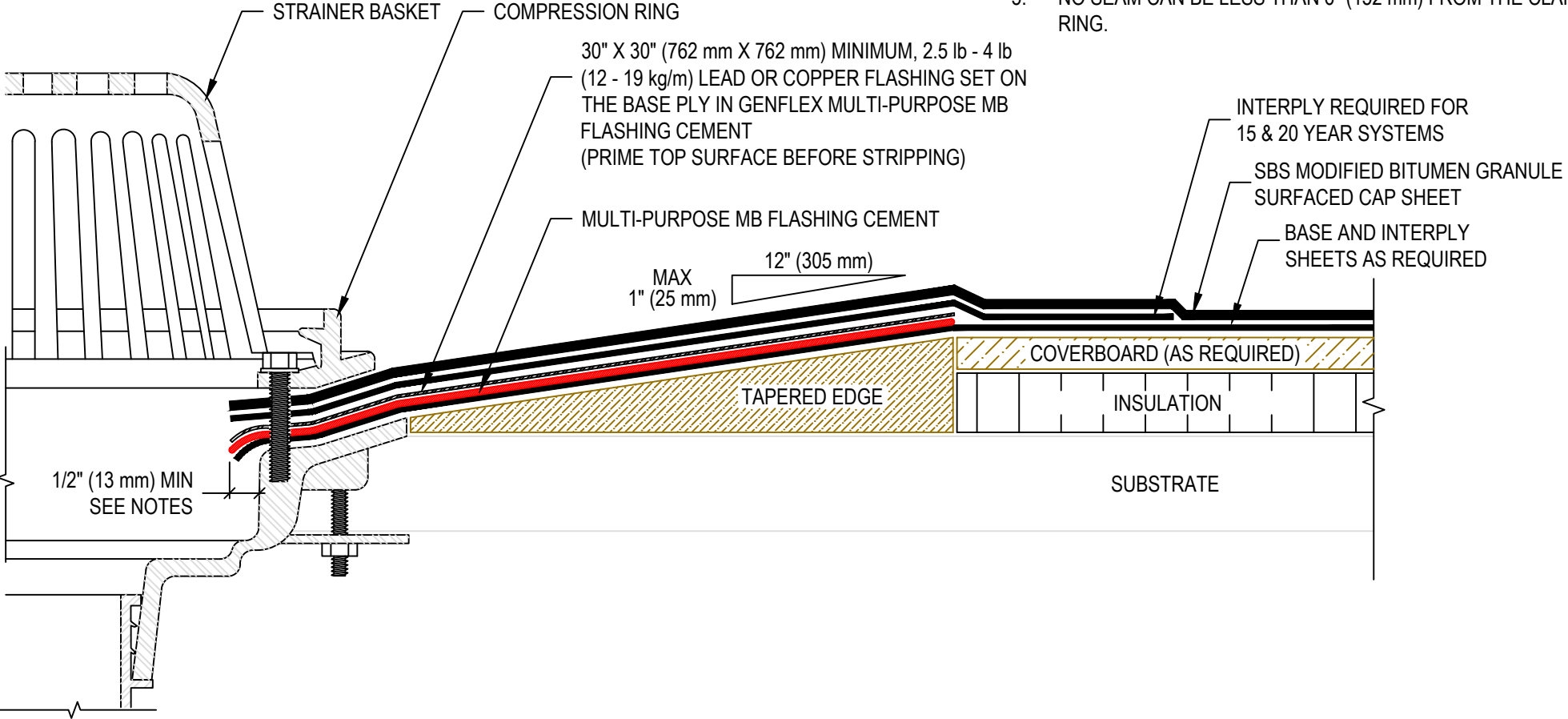

NO LEAD ROOF DRAIN

GENFLEX™

ACCEPTABLE SYSTEMS: **MODIFIED BITUMEN**

GENFLEX: (800) 443-4272 www.genflex.com

MAXIMUM WARRANTY: 20 Years

ISSUE / REVISION DATE:

05/21/2025

NOT TO SCALE

DETAIL NO.

MB-D-3