

NOTE:

1. REFER TO WWW.GENFLEX.COM FOR MOST CURRENT INFORMATION.
2. GRANULES MUST BE EMBEDDED PRIOR TO THERMALLY FUSING END LAPS.
3. GRANULES MUST BE EMBEDDED WHEN THERMALLY FUSING GRANULE SURFACED CAP SHEET.
4. SIDE LAPS MUST BE A MINIMUM OF 4" WIDE.
5. REFER TO ATTACHMENT GUIDE.

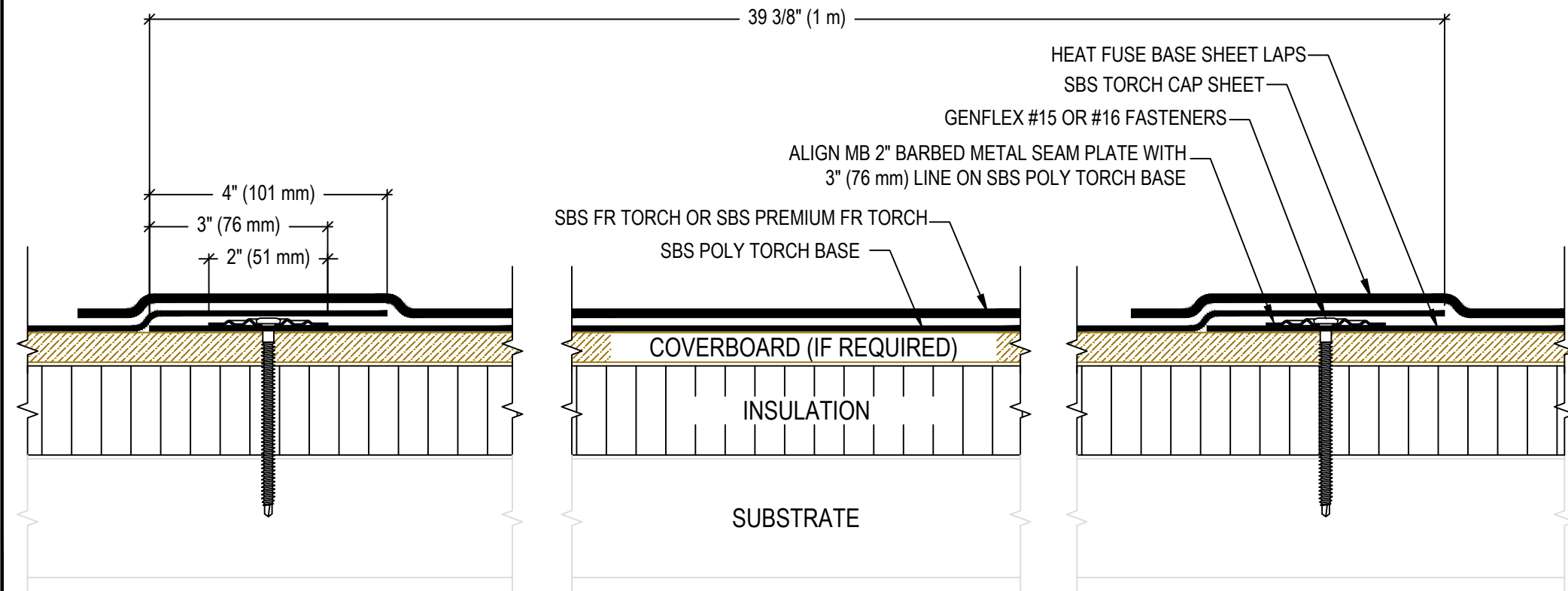

MECHANICALLY ATTACHED TWO PLY SBS SYSTEM

GENFLEX™

ACCEPTABLE SYSTEMS: MODIFIED BITUMEN

GENFLEX: (800) 443-4272 www.genflex.com

MAXIMUM WARRANTY: 20 Years

ISSUE / REVISION
DATE:

04/18/2025

NOT TO SCALE

DETAIL NO.

MB-LS-7