

BATTEN IN THE SEAM LAP SEALING REQUIREMENTS

| | END LAP | SIDE LAP |
|-------------------|------------------------------|-----------|
| BASE SHEET | HEAT WELD | HEAT WELD |
| CAP SHEET | EMBED GRANULES AND HEAT WELD | HEAT WELD |

NOTE:

1. REFER TO WWW.GENFLEX.COM FOR MOST CURRENT INFORMATION.
2. GRANULES MUST BE EMBEDDED PRIOR TO THERMALLY FUSING END LAPS.
3. GRANULES MUST BE EMBEDDED WHEN THERMALLY FUSING GRANULE SURFACED CAP SHEET.
4. SIDE LAPS MUST BE A MINIMUM OF 4" WIDE.
5. REFER TO ATTACHMENT GUIDE.

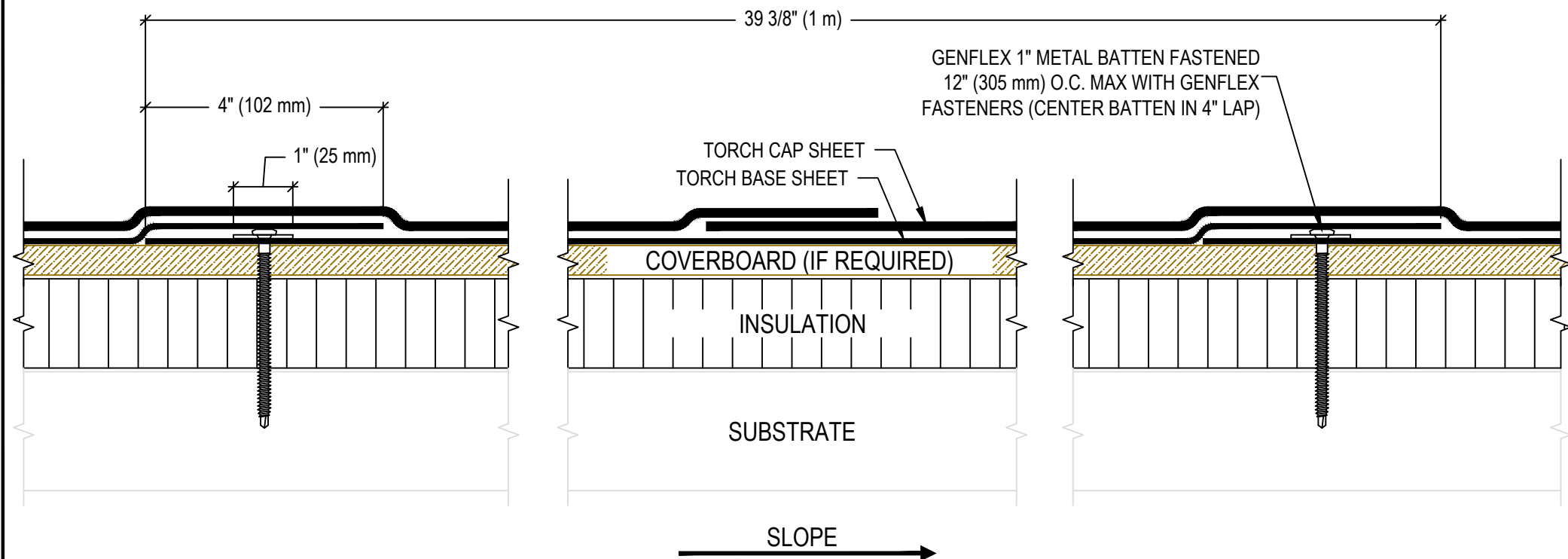

LAP SPLICE TORCH APPLIED MB BATTEN IN THE SEAM

GENFLEX™

ACCEPTABLE SYSTEMS: MODIFIED BITUMEN

MAXIMUM WARRANTY: 20 Years

ISSUE / REVISION
DATE:

05/08/2025

DETAIL NO.

MB-LS-8

NOT TO SCALE

GENFLEX: (800) 443-4272 www.genflex.com