

### IMPACTED ZONE

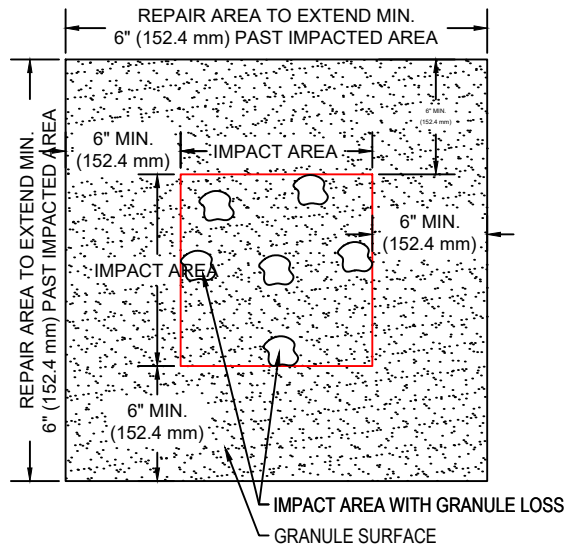

### ULTRAFLASH 3-COURSE

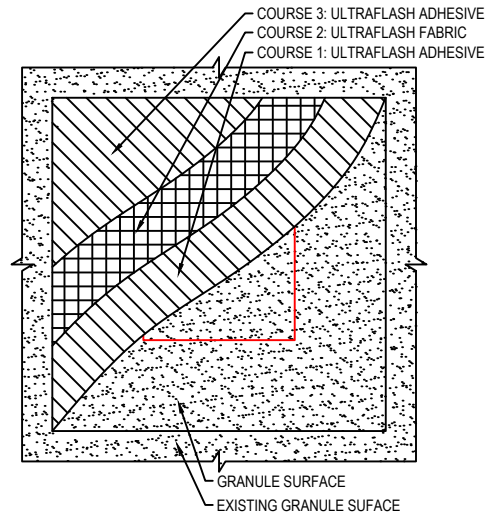

### NOTE:

1. REFER TO [WWW.GENFLEX.COM](http://WWW.GENFLEX.COM) FOR THE MOST CURRENT INFORMATION.
2. ROUND ALL CORNERS OF MEMBRANE/PATCHES WHEN USED.
3. BROOM LOOSE GRANULES AND OTHER DEBRIS FROM IMPACTED AREA.
4. ONLY PERFORM REPAIR WHEN ROOFING SURFACE IS DRY.

### OVERLAY WITH LIKE MATERIAL

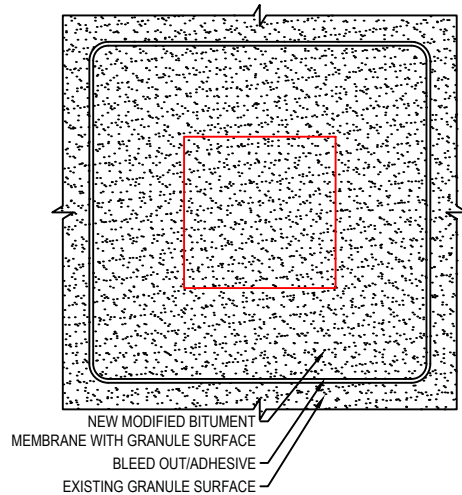

### MB COLD ADHESIVE WITH GRANULES

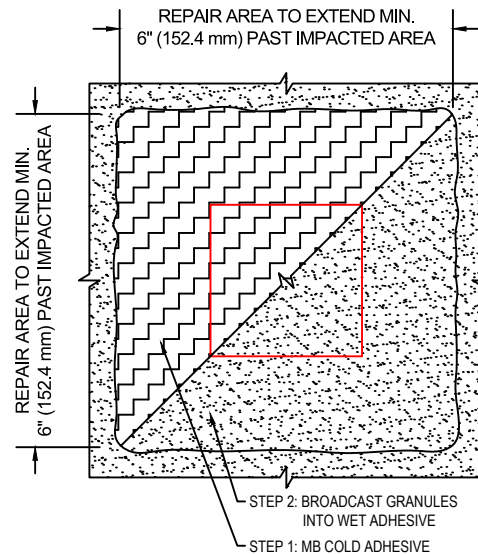

### COATING

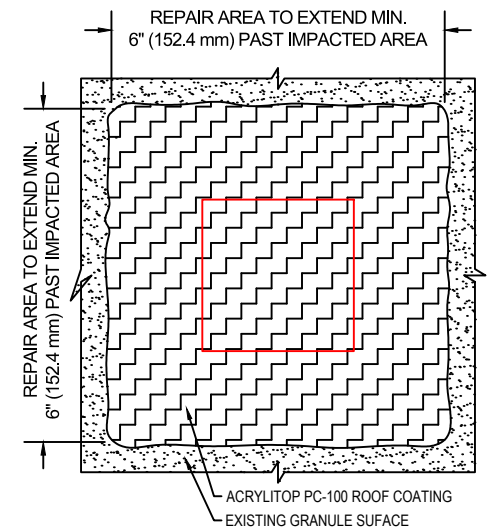

## HAIL IMPACT GRANULE LOSS REPAIR METHODS

GENFLEX™

ACCEPTABLE SYSTEMS: MODIFIED BITUMEN

GENFLEX: (800) 443-4272 [www.genflex.com](http://www.genflex.com)

MAXIMUM WARRANTY: 20 Years

ISSUE / REVISION  
DATE:

05/21/2025

NOT TO SCALE

DETAIL NO.

MB-M-10