

NOTE:

1. REFER TO WWW.GENFLEX.COM FOR MOST CURRENT INFORMATION.
2. THIS DETAIL SHOULD BE USED ONLY WHERE THE DECK IS SUPPORTED BY THE OUTSIDE WALL.
3. WOOD NAILERS MUST BE INSTALLED WITH SUITABLE FASTENERS TO MEET APPLICABLE BUILDING CODES.
4. ALL SHEET METAL IS TO BE INSTALLED PER SMACNA GUIDELINES.
5. PRIME METAL BEFORE ADHERING FLASHING.
6. GRANULES MUST BE EMBEDDED WHEN THERMALLY FUSING GRANULE SURFACED CAP SHEET.

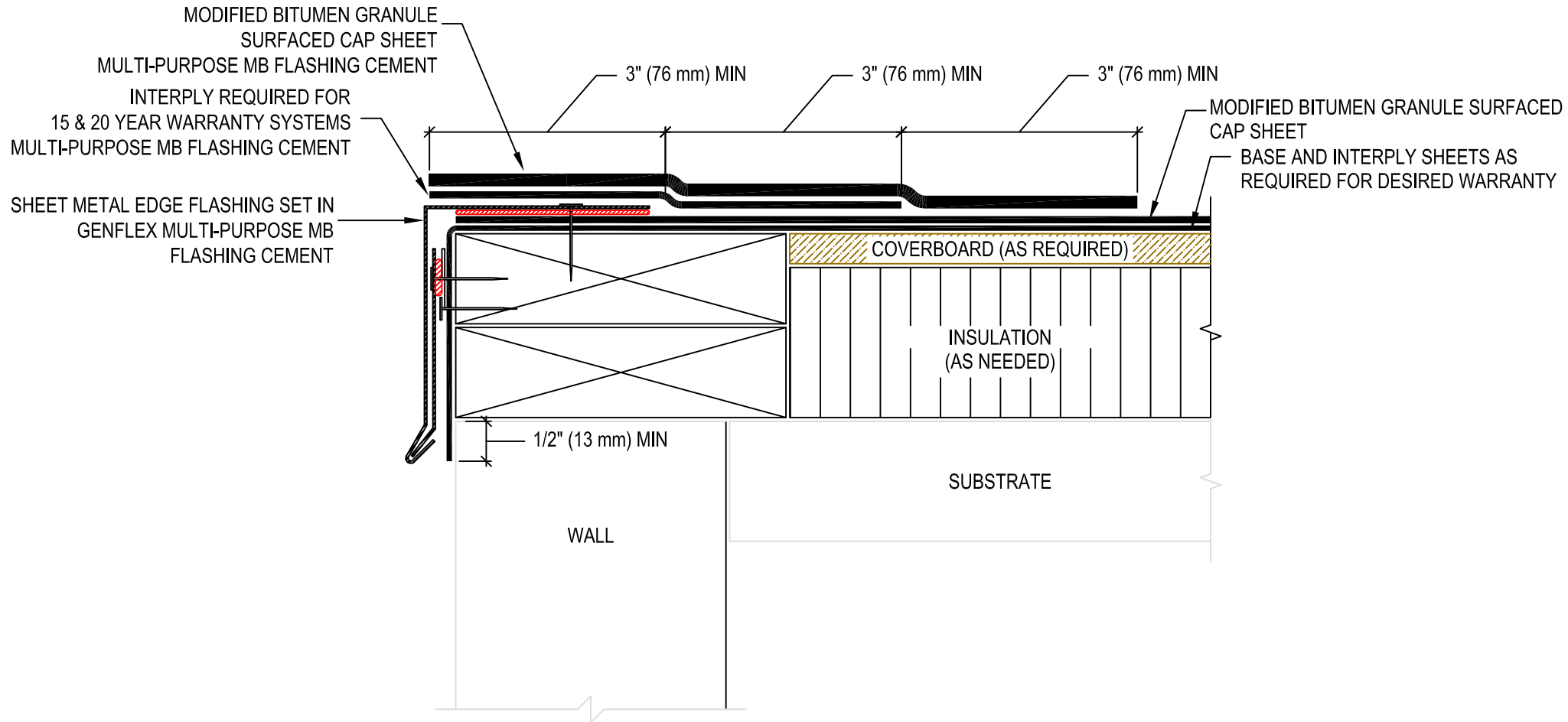

**EDGE METAL USING STRIP FLASHING**

**GENFLEX™**

ACCEPTABLE SYSTEMS: **MODIFIED BITUMEN**

GENFLEX: (800) 443-4272 [www.genflex.com](http://www.genflex.com)

**MAXIMUM WARRANTY: 20 Years**

ISSUE / REVISION  
DATE:

**05/21/2025**

NOT TO SCALE

**DETAIL NO.**

**MB-RE-13**