

# Submittal Sheet

## EZ TPO Fleece Backed Adhered Membrane Lightweight Concrete Deck

## Roofing System Limited Warranty: Up to 20 Years, 55 mph

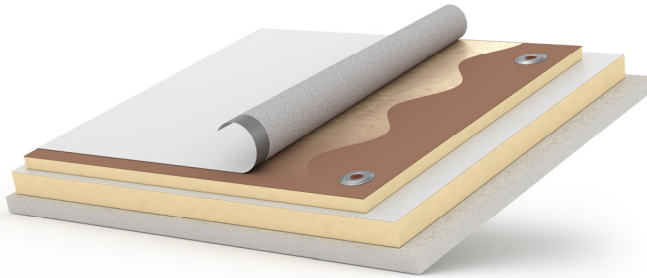

- GenFlex™ EZ TPO Fleece Backed Membrane
- Adhered with appropriate Bonding Adhesive
- Cover Board (Optional) – Mechanically Attached or Adhered
- Insulation – Mechanically Attached or Adhered
- Lightweight Concrete Deck

**Slope Requirement:** Positive drainage required for warranty.

### Construction Type:

- ☐ New Construction    ☐ Complete Tear-off    ☐ Recover (Any wet or damaged materials removed prior to installation)

**Building Height Limitation:** Elevate UltraPly TPO Adhered Systems are limited to buildings 250' (76.2 m) or less.

**Air Barrier:** An air barrier is recommended for projects with large wall openings greater than 10% of the total wall area.

**Vapor Barrier:** ☐ GenFlex Vapor Shield    ☐ 4-6 mil poly    ☐ Thermal Barrier

\*Thermal barrier required when using Vapor Shield over a Steel Deck on FM Insured or FM Specified projects.

**Base Tie-Ins:** Must be attached to substrates which provide a minimum of 200 lbf (1 kN) in any direction.

### Increased Wind Speed and Codes:

Any wind speed coverage exceeding 55 mph (88 km/h) or projects with code requirements must be reviewed by a GenFlex Regional Technical Coordinator.

### Deck Requirement:

- ☐ Minimum 2" Lightweight Concrete over 22 Gauge Steel Pan  
☐ Minimum 2" Lightweight Concrete over Structural Concrete  
☐ Minimum 2" Lightweight Concrete with Base Sheet Attachment

### Insulation Fasteners and Plates:

- ☐ GenFast #14 PreAssembled Screw and Plate (Steel Pan) (Max 15-Year)  
☐ GenFast #15 WH Fastener and GenFast 3" Round Plates (Steel Pan or Structural Concrete)  
☐ GenFast CD-10 Concrete Fasteners and GenFast 3" Round Plates (Structural Concrete)  
☐ GenFast Lite Deck Fastener and 3" Lite Deck Plates

### Insulation Adhesive\*:

- ☐ GenFlex ISO Bond Insulation Adhesive    ☐ GenFlex One Step Insulation Adhesive    ☐ Asphalt Type III or IV  
☐ GenFlex Quick Dual™

\*NOTE: Max. 4' x 4' boards must be used when attaching insulation with adhesives. Cleaning of the metal deck may be required to remove processing oils.

### Insulation / Membrane Adhesive Attachment:

#### Max. 15 Year Warranty:

- ☐ Bead Spacing: F: 12", P: 12", C: 12"

#### 20 Year Warranty:

- ☐ Bead Spacing: F: 12", P: 6", C: 6"    ☐ Full Coverage

### Membrane Requirement:

#### Max. 15 Year Warranty:

- ☐ EZ TPO Fleece Backed Membrane, 45 mil\*

#### 20 Year Warranty:

- ☐ EZ TPO Fleece Backed Membrane, 60 Mil

\*NOTE: When adhered direct to existing asphalt, mod-bit or built-up products.

### Seaming Requirement:

1.5" Single Weld System (use robot welder). Joint covers are required at all joints and at angle changes 1:12 or greater. Strip in end laps with welded 8" EZ TPO Membrane.

### GenFlex Membrane Adhesive:

- ☐ GenFlex Quick Jet    ☐ GenFlex Quick Dual    ☐ Asphalt (IV or SEBS) (Full Coverage)  
☐ Asphalt (III) (Max 15-year) (Full Coverage)

\*\* See Supplemental Wind Speed Attachment Guide for increased wind speed warranty requirements

### GenFlex Factory Formed Edge Metal System:

- ☐ GenFlex Coping System    ☐ GenFlex Fascia System  
☐ GenFlex Drip Edge    ☐ GenFlex TPO Skirted Drip Edge

SS-EZTPO-231

October 8, 2025

Sales: (800) 443-4272

Technical: (800) 428-4511

Page 1

**Non-Factory Formed Edge Conditions:**
☐ GenFast Termination Bar      ☐ GenFlex TPO Coated Metal      ☐ GenFlex Approved Detail

**Substrate Attachment Rates for Standard 55 mph Wind Speed (Top Layer, 4' x 8' Board)**

Thickness	Substrate Material	Minimum Fasteners
<input type="checkbox"/> 1.0" – 1.4"	<input type="checkbox"/> GenFlex GL ISO or GenFlex ISO or <input type="checkbox"/> GenFlex CG ISO or Coated Glass Facer Polyiso	16
<input type="checkbox"/> 1.5" – 1.9"		12
<input type="checkbox"/> 2.0" – 4.0"		8
<input type="checkbox"/> 1.5" – 1.9"	<input type="checkbox"/> GenFlex NB ISO or NailBase Composite Board / <input type="checkbox"/> OSB / <input type="checkbox"/> Plywood (Plate and Fastener)	12
<input type="checkbox"/> 2.0" – 4.0"		8
<input type="checkbox"/> GenFlex NB ISO or NailBase Composite Board / OSB / Plywood		16
<input type="checkbox"/> GenFlex HD Composite ISO		12
<input type="checkbox"/> GenFlex HD ISO or GenFlex ½" HD ISO Cover Board		12
<input type="checkbox"/> 1/4"	<input type="checkbox"/> SECUROCK® Gypsum-Fiber Roof Board <input type="checkbox"/> SECUROCK UltraLight Coated Glass-Mat Roof Board	10
<input type="checkbox"/> 1/2"		8
<input type="checkbox"/> 5/8"		8
<input type="checkbox"/> 1/4"	SECUROCK UltraLight Glass-Mat Roof Board <b>NOTE:</b> Not for use with adhered membrane or insulation adhesives. May be used as insulation layer or thermal barrier layer when fastened through.	10
<input type="checkbox"/> 1/2"		8
<input type="checkbox"/> 5/8"		8
<input type="checkbox"/> 1/2"	SECUROCK Cement Roof Board	8
<input type="checkbox"/> 5/8"		8
<input type="checkbox"/> 1/4"	DensDeck® Prime Roof Board	12
<input type="checkbox"/> 1/2"		8
<input type="checkbox"/> 5/8"		8
<input type="checkbox"/> 5/8"	DensDeck Prime StormX™ Roof Board	8
<input type="checkbox"/> 1/4"	DEXcell® Glass Mat Roof Board <b>NOTE:</b> Not for use with adhered membrane or insulation adhesives. May be used as insulation layer or thermal barrier layer when fastened through.	12
<input type="checkbox"/> 1/2"		8
<input type="checkbox"/> 5/8"		8
<input type="checkbox"/> 1/4"	DEXcell FA™ Glass Mat Roof Board	12
<input type="checkbox"/> 1/2"		8
<input type="checkbox"/> 5/8"		8
<input type="checkbox"/> 7/16"	DEXcell Cement Roof Board	10
<input type="checkbox"/> 5/8"		8
<input type="checkbox"/> 5/8"	DEXcell FA VSH™ Glass Mat Roof Board	8
<input type="checkbox"/> 1/2"	Structodek® High Density Wood Fiber Board	16

**NOTE:**

- Only GenFlex brand products are covered in a GenFlex Roof System Warranty.
- Refer to the GenFlex Technical Database at [www.genflex.com](http://www.genflex.com) for additional information regarding appropriate roof systems and roof system warranty requirements. Review appropriate details and installation requirements based on warranty term requested.
- It is the installing contractor's responsibility to follow all applicable building codes.
- Contact GenFlex Technical Services for full warranty requirements.
- DensDeck is a registered trademark of Georgia-Pacific Gypsum LLC, SECUROCK is a registered trademark of USG Corporation, Structodek is a registered trademark of Blue Ridge Fiberboard, Inc., and DEXcell is a registered trademark of National Gypsum Company.

This sheet is meant to highlight GenFlex products and specifications and is subject to change without notice. Amrize takes responsibility for furnishing quality materials that meet published GenFlex product specifications or other technical documents, subject to normal manufacturing tolerances. Neither Amrize nor its representatives practice architecture. Amrize offers no opinion on and expressly refuses any responsibility for the soundness of any structure. Amrize accepts no liability for structural failure or resultant damages. Consult a competent structural engineer prior to installation if the structural soundness or structural ability to properly support a planned installation is in question. No Amrize representative is authorized to vary this disclaimer.