

**USE
APPROPRIATE
TERMINATION**

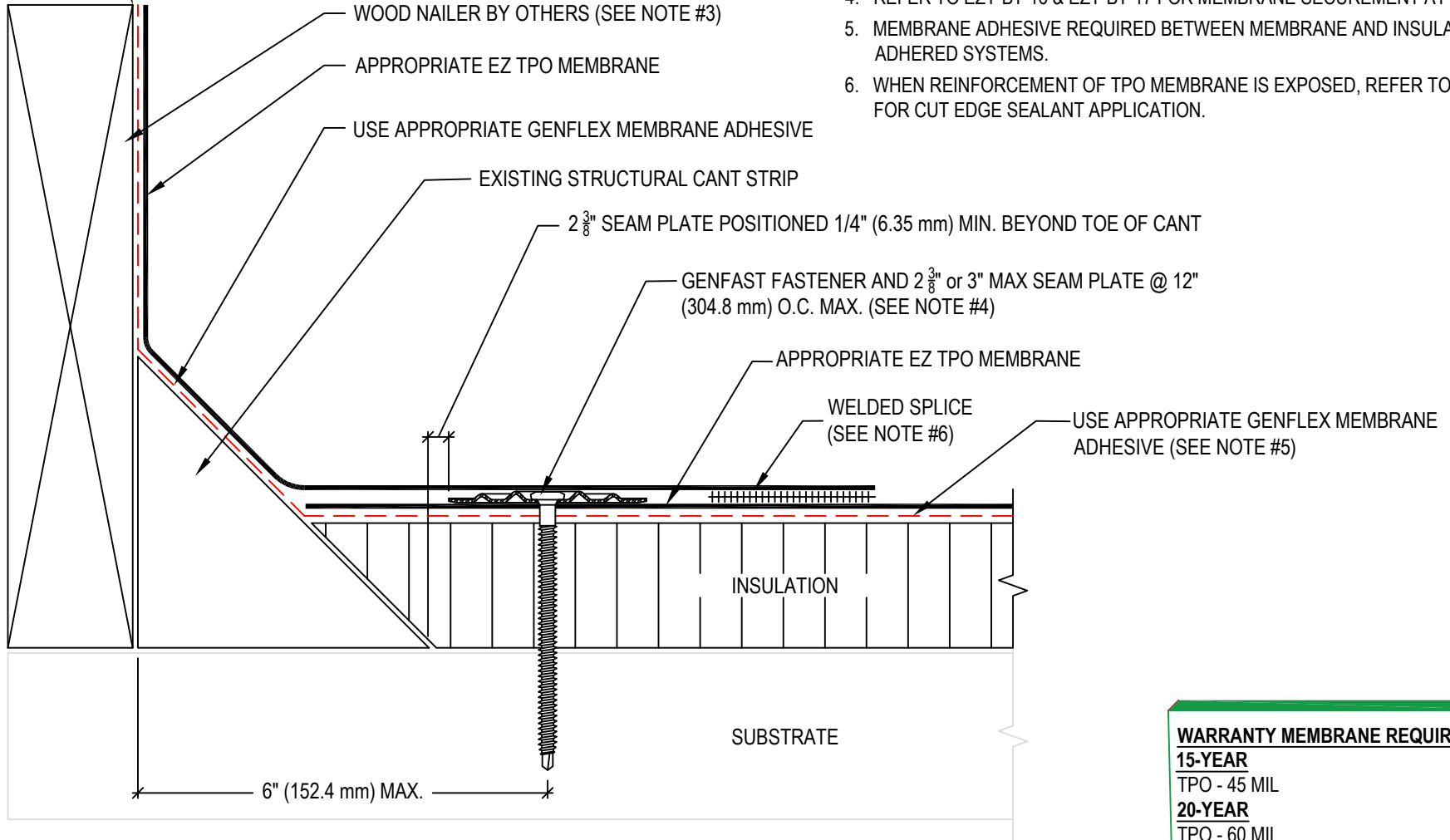

- NOTE:
1. REFER TO THE GENFLEX™ WEBSITE FOR MOST CURRENT INFORMATION.
 2. REFER TO DETAIL EZT-LS-01 OR EZT-LS-02 FOR WELD WIDTH.
 3. WOOD NAILER BY OTHERS MUST BE INSTALLED TO MEET APPLICABLE BUILDING CODES.
 4. REFER TO EZT-BT-16 & EZT-BT-17 FOR MEMBRANE SECUREMENT AT CORNERS.
 5. MEMBRANE ADHESIVE REQUIRED BETWEEN MEMBRANE AND INSULATION FOR ADHERED SYSTEMS.
 6. WHEN REINFORCEMENT OF TPO MEMBRANE IS EXPOSED, REFER TO EZT-LS-14 FOR CUT EDGE SEALANT APPLICATION.

WARRANTY MEMBRANE REQUIREMENTS:

15-YEAR
TPO - 45 MIL

20-YEAR
TPO - 60 MIL



BASE TIE-IN AT CURB / PARAPET WITH EXISTING CANT

MATERIAL: EZ TPO

ACCEPTABLE SYSTEMS: ALL

GENFLEX: (800) 443-4272 www.genflex.com

MAXIMUM WARRANTY: 20 Years

ISSUE / REVISION
DATE:

04/14/2026

NOT TO SCALE

DETAIL NO.

EZT-BT-07