

**NOTE:**

1. REFER TO THE GENFLEX™ WEBSITE FOR MOST CURRENT INFORMATION.
2. INSTALL METAL WORK TO SMACNA RECOMMENDATIONS
3. WOOD NAILER BY OTHERS MUST BE INSTALLED TO MEET APPLICABLE BUILDING CODES.
4. FLANGE OF METAL MUST BE FULLY SUPPORTED BY WOOD AND TERMINATED AT LEAST 1/2" (13 MM) FROM EDGE OF WOOD.

**STEP #1**

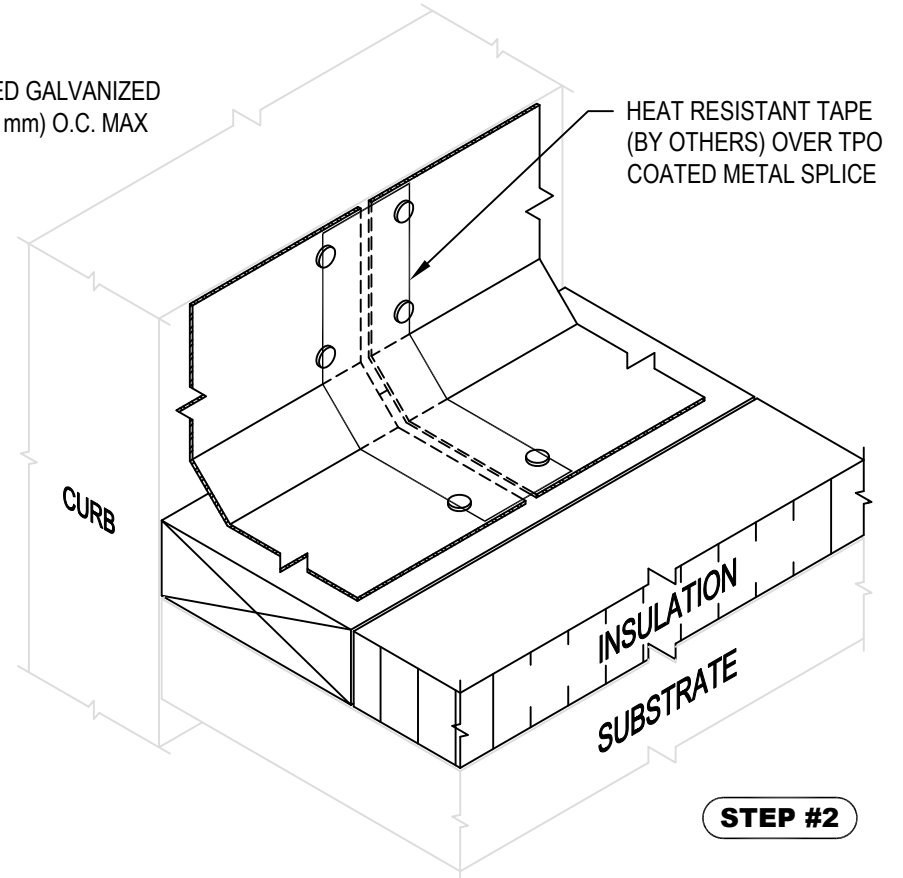
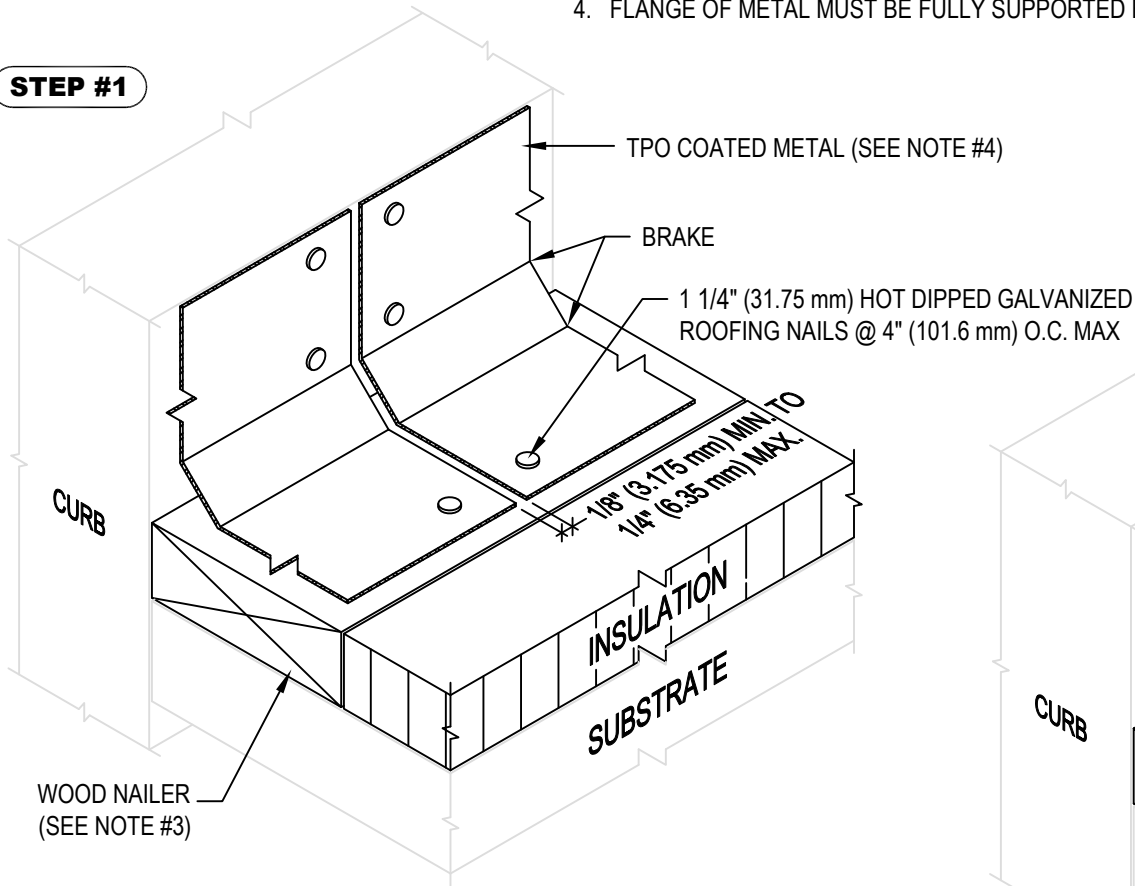

**STEP #2**

**WARRANTY MEMBRANE REQUIREMENTS:**

- 15-YEAR**  
TPO - 45 MIL
- 20-YEAR**  
TPO - 60 MIL



**BASE TIE-IN WITH TPO COATED METAL  
(WITH BRAKE) SPLICE - INSTALLATION STEPS 1 & 2**

MATERIAL: EZ TPO

ACCEPTABLE SYSTEMS: ALL

GENFLEX: (800) 443-4272 www.genflex.com

MAXIMUM WARRANTY: 20 Years

ISSUE / REVISION  
DATE:

04/14/2026

NOT TO SCALE

DETAIL NO.

**EZT-BT-09A**