

NOTE:

1. REFER TO THE GENFLEX™ WEBSITE FOR MOST CURRENT INFORMATION.
2. REFER TO DETAIL EZT-LS-01 OR EZT-LS-02 FOR WELD WIDTH.
3. WHEN REINFORCEMENT OF TPO MEMBRANE IS EXPOSED, REFER TO EZT-LS-14 FOR CUT EDGE SEALANT APPLICATION.

STEP #3

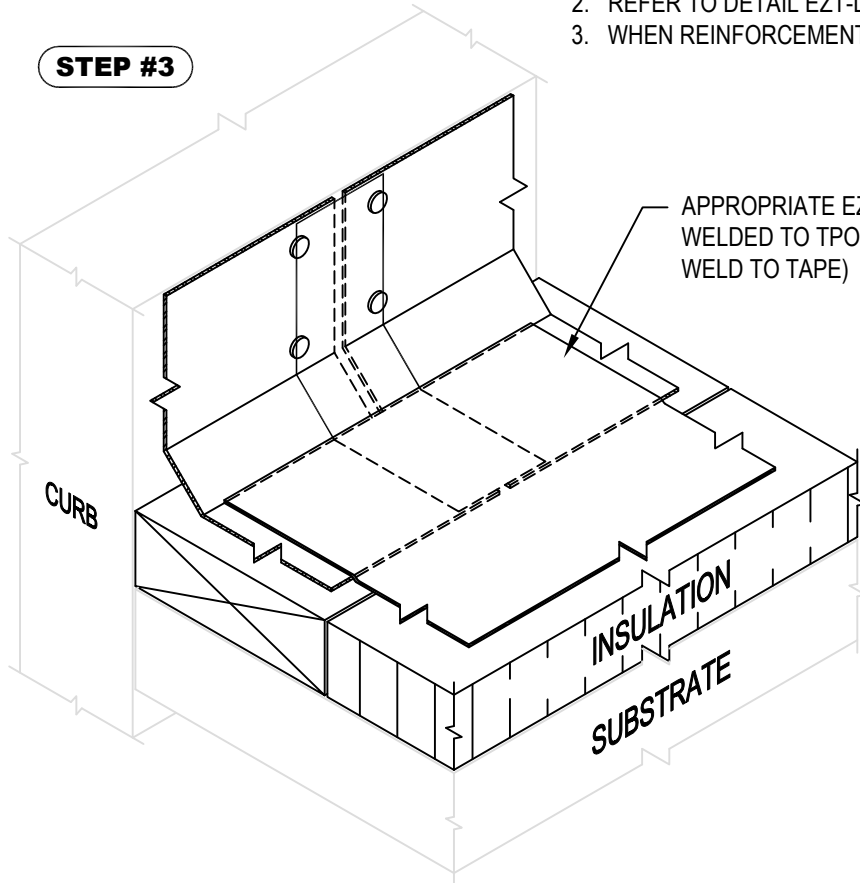

USE APPROPRIATE TERMINATION

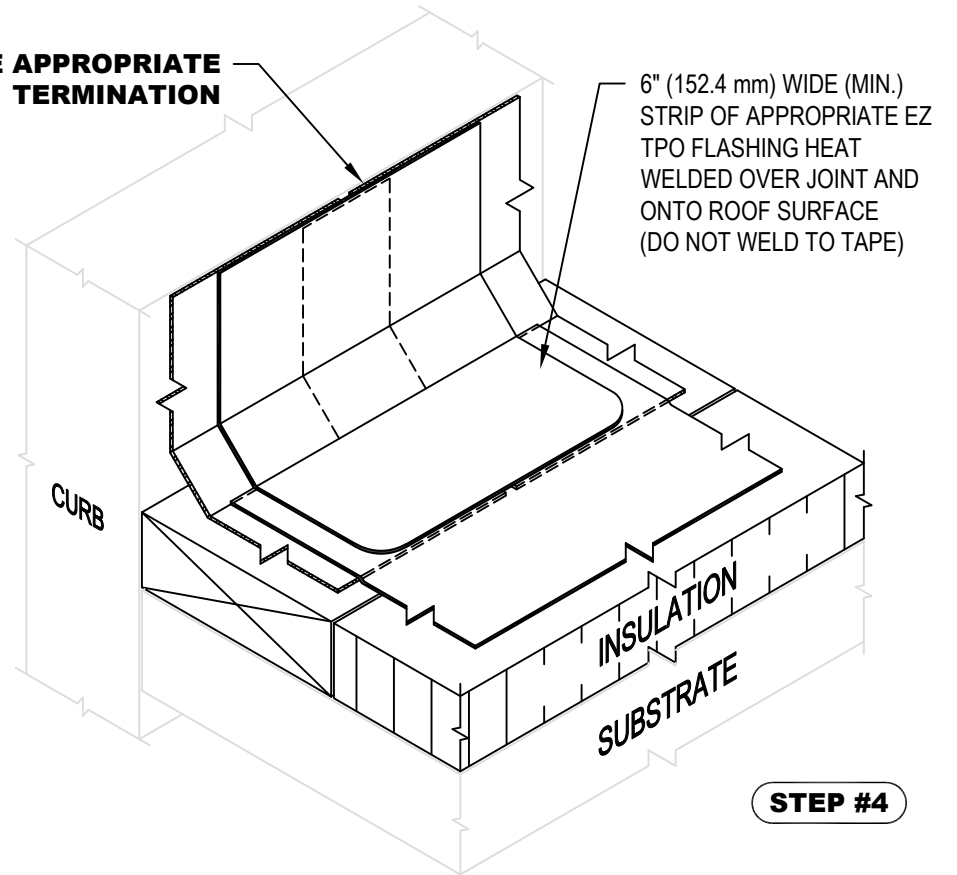

STEP #4

WARRANTY MEMBRANE REQUIREMENTS:

15-YEAR
TPO - 45 MIL
20-YEAR
TPO - 60 MIL



**BASE TIE-IN WITH TPO COATED METAL
(WITH BRAKE) SPLICE - INSTALLATION STEPS 3 & 4**

MATERIAL: EZ TPO

ACCEPTABLE SYSTEMS: ALL

MAXIMUM WARRANTY: 20 Years

ISSUE / REVISION
DATE:
04/14/2026

DETAIL NO.
EZT-BT-09B

NOT TO SCALE

GENFLEX: (800) 443-4272 www.genflex.com