

NOTE:

1. REFER TO THE GENFLEX™ WEBSITE FOR MOST CURRENT INFORMATION.
2. REFER TO DETAIL EZT-BT-11 FOR TPO COATED METAL SPLICE
3. REFER TO DETAIL EZT-C-07 & EZT-C-09 FOR CORNER FLASHING APPLICATION.
4. INSTALL METAL WORK TO SMACNA RECOMMENDATIONS.
5. WOOD NAILER BY OTHERS MUST BE INSTALLED TO MEET APPLICABLE BUILDING CODES.
6. FLANGE OF METAL MUST BE FULLY SUPPORTED BY WOOD TERMINATED AT LEAST 1/2" (12.7 mm) FROM EDGE OF WOOD.
7. WHEN REINFORCEMENT OF TPO MEMBRANE IS EXPOSED, REFER TO EZT-LS-14 FOR CUT EDGE SEALANT APPLICATION.
8. GENFLEX MEMBRANE ADHESIVE REQUIRED BETWEEN MEMBRANE AND INSULATION FOR ADHERED SYSTEMS.

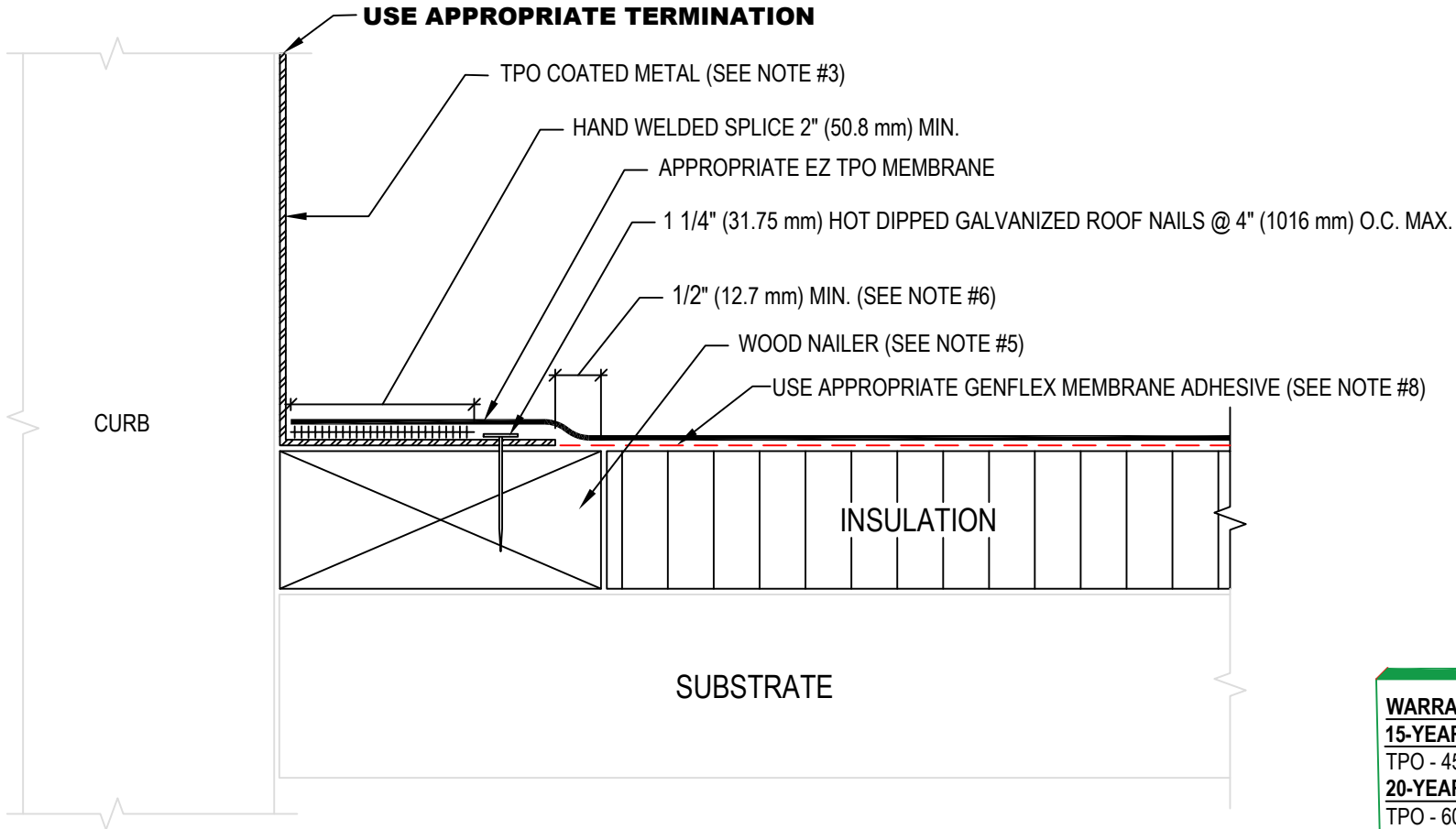

WARRANTY MEMBRANE REQUIREMENTS:
15-YEAR
 TPO - 45 MIL
20-YEAR
 TPO - 60 MIL



BASE TIE-IN WITH TPO COATED METAL

MATERIAL: EZ TPO

ACCEPTABLE SYSTEMS: ALL

MAXIMUM WARRANTY: 20 Years

ISSUE / REVISION DATE:

04/14/2026

DETAIL NO.

EZT-BT-10

GENFLEX: (800) 443-4272 www.genflex.com

NOT TO SCALE