

- NOTE:
1. REFER TO THE GENFLEX™ WEBSITE FOR MOST CURRENT INFORMATION.
 2. WOOD NAILER MUST BE INSTALLED TO MEET APPLICABLE BUILDING CODES.
 3. GENFLEX MEMBRANE ADHESIVE REQUIRED BETWEEN MEMBRANE AND INSULATION FOR ADHERED SYSTEMS.
 4. ACCEPTABLE ROOF PAVER - MIN 10 LB (4.5 KG) PER SQ. FT, INSTALLED OVER PROTECTION LAYER (REQUIRED FOR BALLASTED SYSTEMS).
 5. WHEN CHANGE IN ELEVATION OCCURS BETWEEN SYSTEMS, USE APPROPRIATE TAPERED INSULATION TO CREATE A SMOOTH TRANSITION.

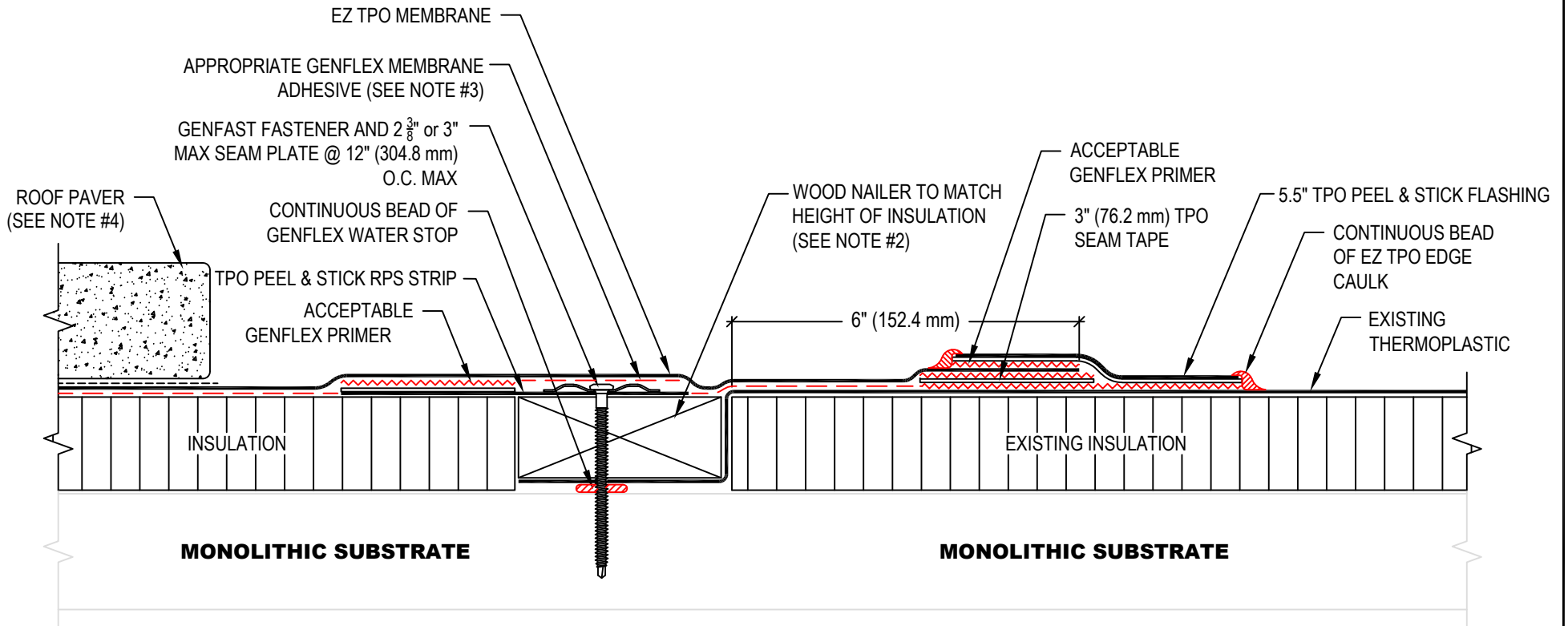

TIE-IN TO EXISTING ROOF SYSTEMS NOT WARRANTED BY GENFLEX

WARRANTY MEMBRANE REQUIREMENTS:
15-YEAR
 TPO - 45 MIL
20-YEAR
 TPO - 60 MIL



TIE-IN EZ TPO SYSTEM TO EXISTING THERMOPLASTIC SYSTEM (MONOLITHIC SUBSTRATE)

MATERIAL: EZ TPO ACCEPTABLE SYSTEMS: ALL

MAXIMUM WARRANTY: 20 Years

ISSUE / REVISION DATE:
 04/14/2026

DETAIL NO.
EZT-BT-18

GENFLEX: (800) 443-4272 www.genflex.com

NOT TO SCALE