

**NOTE:**

1. REFER TO THE GENFLEX™ WEBSITE FOR MOST CURRENT INFORMATION.
2. WOOD NAILER MUST BE INSTALLED TO MEET APPLICABLE BUILDING CODES.
3. GENFLEX MEMBRANE ADHESIVE REQUIRED BETWEEN MEMBRANE AND INSULATION FOR ADHERED SYSTEMS.
4. ACCEPTABLE ROOF PAVER - MIN 10 LB (4.5KG) PER SQ. FT.) INSTALLED OVER PROTECTION LAYER (REQUIRED FOR BALLASTED SYSTEMS).
5. REFER TO EZT-BT-24 FOR ADDITIONAL REQUIREMENTS FOR METAL ROOF DECKS
6. WHEN CHANGE IN ELEVATION OCCURS BETWEEN SYSTEMS, USE APPROPRIATE TAPERED INSULATION TO CREATE A SMOOTH TRANSITION.

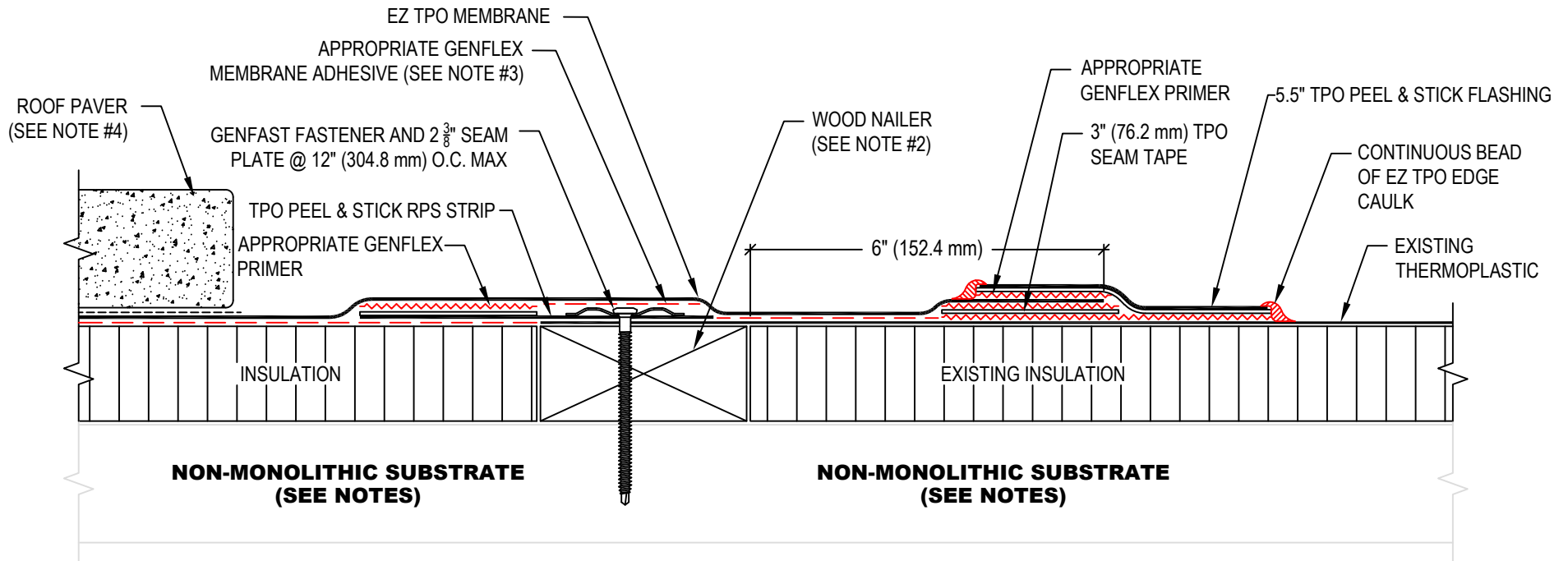

**TIE-IN TO EXISTING ROOF SYSTEMS NOT WARRANTED BY GENFLEX**

**WARRANTY MEMBRANE REQUIREMENTS:**  
**15-YEAR**  
 TPO - 45 MIL  
**20-YEAR**  
 TPO - 60 MIL

	<b>TIE-IN EZ TPO SYSTEM TO EXISTING THERMOPLASTIC SYSTEM (NON-MONOLITHIC SUBSTRATE)</b>		MAXIMUM WARRANTY: 20 Years	
	MATERIAL: EZ TPO	ACCEPTABLE SYSTEMS: ALL	ISSUE / REVISION DATE: 04/14/2026	DETAIL NO. <b>EZT-BT-19</b>
GENFLEX: (800) 443-4272 www.genflex.com			NOT TO SCALE	