

**NOTE:**

1. REFER TO THE GENFLEX™ WEBSITE FOR MOST CURRENT INFORMATION.
2. WOOD NAILER MUST BE INSTALLED TO MEET APPLICABLE BUILDING CODES.
3. GENFLEX MEMBRANE ADHESIVE REQUIRED BETWEEN MEMBRANE AND INSULATION FOR ADHERED SYSTEMS.
4. ACCEPTABLE ROOF PAVER - MIN 10 LB (4.5 KG) PER SQ. FT. INSTALLED OVER PROTECTION LAYER (REQUIRED FOR BALLASTED SYSTEMS).
5. GRAVEL SURFACING, IRREGULARITIES, MOISTURE, ETC. MUST BE REMOVED FROM EXISTING ASPHALT SYSTEM PRIOR TO TIE-IN. APP 160 OR 160 COOL REQUIRED WHEN PEEL & STICK PRODUCTS ARE USED.
6. WHEN CHANGE IN ELEVATION OCCURS BETWEEN SYSTEMS, USE APPROPRIATE TAPERED INSULATION TO CREATE A SMOOTH TRANSITION.

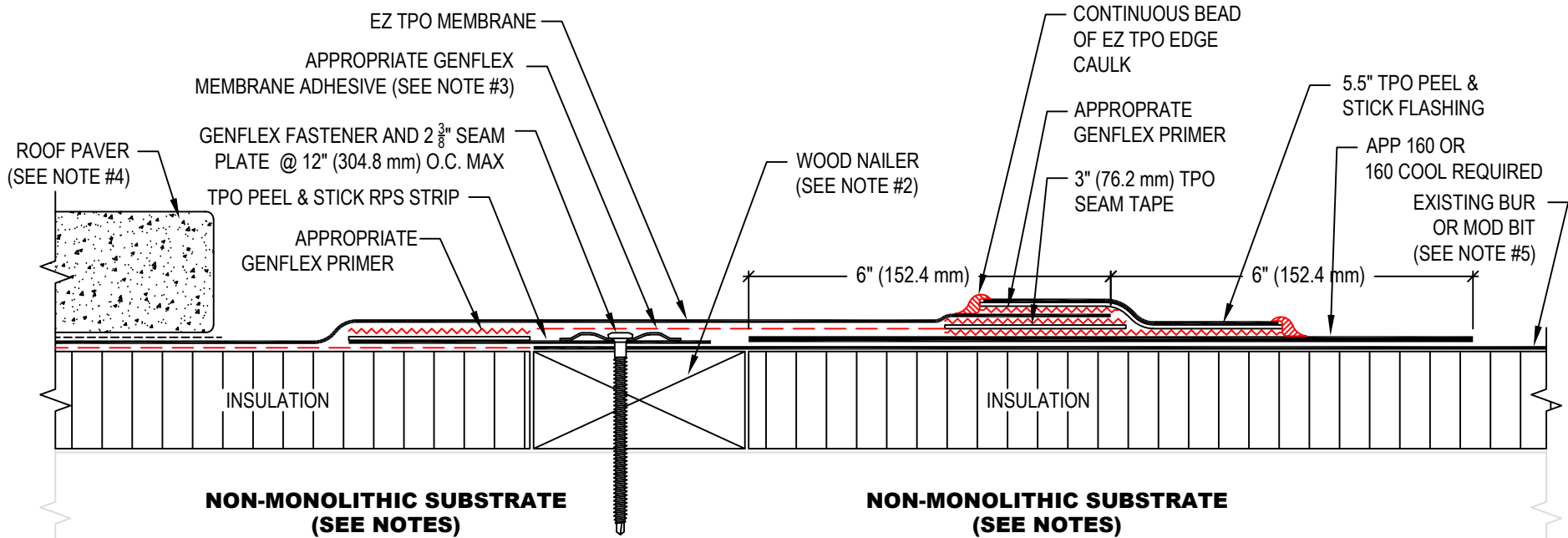

**EXTREME CARE SHOULD BE TAKEN WHEN TORCHING APP MEMBRANE NEAR FLAMMABLE MATERIALS**

**TIE-IN TO EXISTING ROOF SYSTEMS NOT WARRANTED BY GENFLEX**

**WARRANTY MEMBRANE REQUIREMENTS:**  
**15-YEAR**  
 TPO - 45 MIL  
**20-YEAR**  
 TPO - 60 MIL

	<b>TIE-IN EZ TPO SYSTEM TO EXISTING ASPHALT SYSTEM (NON-MONOLITHIC SUBSTRATE)</b>		MAXIMUM WARRANTY: 20 Years	
	MATERIAL: EZ TPO	ACCEPTABLE SYSTEMS: ALL	ISSUE / REVISION DATE: 04/14/2026	DETAIL NO. <b>EZT-BT-23</b>
GENFLEX: (800) 443-4272 www.genflex.com			NOT TO SCALE	