

NOTE:

1. REFER TO THE GENFLEX™ WEBSITE FOR MOST CURRENT INFORMATION.
2. REFER TO DETAIL EZT-LS-01 OR EZT-LS-02 FOR WELD WIDTH.
3. MAXIMUM 10" (254 mm) LONG FASTENERS (NOTE: WOOD BLOCKING MAY BE SUBSTITUTED FOR INSULATION TO REDUCE FASTENER LENGTH REQUIREMENTS).
4. APPROPRIATE ADHESIVE REQUIRED BETWEEN MEMBRANE AND INSULATION FOR ADHERED SYSTEMS.
5. WHEN REINFORCEMENT OF TPO MEMBRANE IS EXPOSED, REFER TO EZT-LS-14 FOR CUT EDGE SEALANT APPLICATION.
6. OMIT PEEL & STICK FLASHING IF INVISIWELD PLATES ARE USED BELOW FIELD MEMBRANE.

WARRANTY MEMBRANE REQUIREMENTS:
15-YEAR
 TPO - 45 MIL
20-YEAR
 TPO - 60 MIL

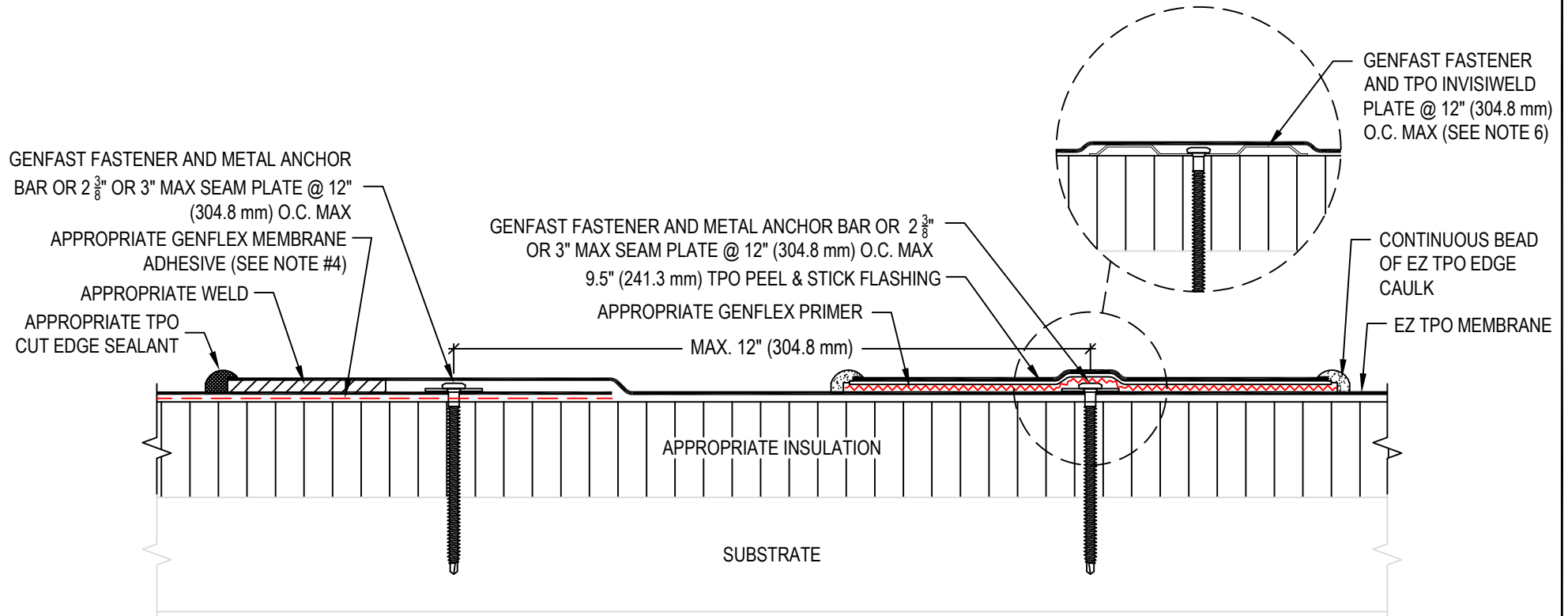

	TRANSITION - EZ TPO MEMBRANE ADHERED TO MECHANICALLY ATTACHED		MAXIMUM WARRANTY: 20 Years	
	MATERIAL: EZ TPO	ACCEPTABLE SYSTEMS: ALL	ISSUE / REVISION DATE: 04/14/2026	DETAIL NO. EZT-BT-31
GENFLEX: (800) 443-4272 www.genflex.com			NOT TO SCALE	